

产品目录

**ROSETTA
FANTINI
COSMI**



凡提尼科斯米集团成立于 1931 年，是中意的意大利公司，以优秀的质量闻名于世。

凡提尼科斯米集团拥有三个著名品牌：凡提尼科斯米、埃斯和凡客斯。凡提尼科斯米集团主要产品涵盖：液位控制、压力控制、温度控制、流量控制、环境控制、通讯控制、电气控制、加热系统、电磁阀、气体探测、电能管理、家居自动化等。

A	水位控制	12
B	压力控制	15
C	温度控制	18
	工业温控器	18
	房间温控器	21
	可编程温控器	23
EC	水计量系统	28
EV	气候热能调节系统	34
EW	远程控制系统	41
FF	流量控制	42
H	接触器和热继电器	44
K	加热电缆	48
L	数字型温控器及仪表	50
M	电磁阀	52
O	家居自动化	54
P	气体探测	59
W	电能计量及数字型计时器	63

A	LEVEL CONTROLS	12
B	PRESSURE CONTROLS	15
C	TEMPERATURE CONTROLS	18
	INDUSTRIAL THERMOSTATS	18
	ROOM THERMOSTATS	21
	PROGRAMMABLE THERMOSTATS	23
EC	WATER METERING SYSTEMS	28
EV	CLIMATIC THERMOREGULATION SYSTEMS	34
EW	TELECONTROL SYSTEMS	41
FF	FLOW CONTROLS	42
H	CONTACTORS AND THERMAL RELAYS	44
K	HEATING CABLES	48
L	DIGITAL THERMOSTATS AND INSTRUMENTS	50
M	SOLENOID VALVES	52
O	HOME AUTOMATION	54
P	GAS DETECTORS	59
W	ENERGY METERING AND DIGITAL TIMER	63

INDEX

CODE	PAGE
1560053	41
1573001	54
1573005	54
1573007	54
1573505	54
1578501	53
1582021	55
1582022	55
1582023	55
1590029	36
1590080	59
1592022	33
1592023	33
2013347	12
2013348	12
2554972	18
2593367	15-16-17
2723094	18
2723095	18
2723856	18
2724259	18
2724260	18
2724261	18
2754975	18
303298LA	15-16-17-18-19-20
5677050	18
A03F	12
A03M	12
A04F	12
A04M	12
A41A	13
A41B	13
A42A	13
A70	13
A94C	13
A94D	13
A95A	13
A95AS1	13
A95AS2	13
A95AS3	13
A95B	13
A95BS1	13
A95BS4	13
A95BS5	13
A95BS6	13
A95BS7	13
A96C	14

CODE	PAGE
A96D	14
A96E	14
A96G	14
AD22	12
AD23	12
AD23A	12
AD23B	12
AD23C	12
AD52	12
AD52P	12
AD52PS1	12
ASE	14
ASM2	14
B01A	15
B01A4	15
B01A4RI	15
B01AM	15
B01AM4	15
B01ARI	15
B01B	15
B01B4	15
B01B4RI	15
B01BM	15
B01BM4	15
B01BRI	15
B01C	15
B01C4	15
B01C4RI	15
B01CM	15
B01CM4	15
B01CRI	15
B01D	15
B01D4	15
B01D4RI	15
B01DM	15
B01DM4	15
B01DRI	15
B11AN	15
B11AN4	15
B11AN4Y	15
B11ANY	15
B12AN	15
B12AN4	15
B12ANY	15
B12BN	15
B12BNY	15
B12CMN	16

CODE	PAGE
B12CN	16
B12CN4	16
B12CNY	16
B12CRN	16
B12CRNY	16
B12DMN	16
B12DN	16
B12DN4	16
B12DNY	16
B12EMN	16
B12EN	16
B12ENY	16
B12ERN	16
B12ERNY	16
B12FMN	17
B12FN	17
B12FNY	17
B12GMN	17
B12GN	17
B12GNY	17
B12HMN	17
B12HN	17
B12HNY	17
B12MN	17
B12MNY	17
B13BN	16
B13BNY	16
B13CN	16
B13CNY	16
B70A	17
B71A	17
C01A	18
C01AM	18
C01ARI	18
C01B	18
C02A3	18
C02B3	18
C02C2	18
C02D2	18
C02E3	18
C02F	18
C03A3	19
C03A3RI	19
C03B3	19
C03B3RI	19
C03C3	19
C04A3	19

CODE	PAGE
C04A3RI	19
C04A3Y	19
C04B3	19
C04B3Y	19
C04C2	19
C04C2RI	19
C04C2RIY	19
C04C2Y	19
C04D2	19
C04D2Y	19
C04E3	19
C04E3Y	19
C06A3M	20
C06B3M	20
C07A3M	20
C08A	19
C08B	19
C09A3M	20
C10A2	20
C10A2RI	20
C10A2RIY	20
C10A2Y	20
C10B2	20
C10B2RI	20
C10B2RIY	20
C10B2Y	20
C10C2	20
C10C2RI	20
C10C2RIY	20
C10C2Y	20
C16	21
C16EH	21
C16EHL	21
C16I	21
C16IL	21
C16L	21
C31	23
C32	23
C44	21
C44B	21
C44C	21
C47	21
C47B	21
C47C	21
C47EH	21
C47EHB	21
C48	21
C48B	21
C48C	21
C50	21
C50B	21
C50C	21
C51A	26
C51AB	26
C51ABT	26

CODE	PAGE
C51ACT	26
C51AT	26
C52A	26
C52AB	26
C52ABT	26
C52AT	26
C53A	26
C53AB	26
C54A	26
C54AB	26
C57	24
C57C	24
C57CT	24
C57N	24
C57RFR	24
C58	24
C58C	24
C58CT	24
C58N	24
C58RFR	24
C60	21
C61	21
C63	22
C67	23
C67C	23
C67N	23
C68	23
C68C	23
C68N	23
C75A	23
C75ACT	23
C75CT	23
C76A	23
C76CT	23
CAS05	33
CAS10	33
CH110	22
CH111	22
CH112	22
CH115	22
CH115-16	22
CH115RF	22
CH116	22
CH117	22
CH130ARFR	22
CH130ARR	22
CH130RFR	22
CH130RR	22
CH140GSM	27
CH141	26
CH141MB	25
CH143	26
CH150	24
CH150-16	24
CH150MB	25

CODE	PAGE
CH150R	24
CH150RBS	25
CH150REV	25
CH150RF	24
CH150TS	24
CH150TSMB	25
CH151	24
CH151MB	25
CH152	24
CH152MB	25
CH170D	24
CH171D	24
CH171DBS	25
CH172DRF	22
CH172DS	22
CH173D	22
CT3M	41
CT3MA	41
CTI5X	26
CTIRM	41
D40	27
EA18	12
EA19	12
EA20	12
EA21	12
EA31M	14
EA32F	14
EAD01	12
EC10	34-36
EC11	34-36
EC12	34-36
EC13A	34-36
EC14	34-36
EC15	34-36
EC16A	34-36
EC17	34-36
EC18	24
EC19	24
EC20	24
EC21	34-36
EC45	28
EC45KPS	28
EC45P	28
EC45PD	28
EC45PS	28
EC85P	28
ECC100W	30
ECC125W	30
ECC150W	30
ECC15AC	28
ECC15AGS	29
ECC15C	29
ECC15C2I	29
ECC15GM	29
ECC15GS	29

CODE	PAGE
ECC15GSF	29
ECC15HC2I	29
ECC200W	30
ECC20AGM	29
ECC20C	28
ECC20C2I	28
ECC20CON	30
ECC20GM	29
ECC20GS	29
ECC20GSF	29
ECC20HC2I	28
ECC250W	30
ECC25GM	29
ECC300W	30
ECC32GM	29
ECC40GM	29
ECC50GM	29
ECC50W	30
ECC60CON	30
ECC65W	30
ECC80W	30
ECCF100W	30
ECCF125W	30
ECCF150W	30
ECCF15GM	29
ECCF15GS	29
ECCF200W	30
ECCF20AGM	29
ECCF20GM	29
ECCF20GS	29
ECCF250W	30
ECCF25GM	30
ECCF300W	30
ECCF32GM	29
ECCF40GM	29
ECCF50GM	29
ECCF50W	30
ECCF65W	30
ECCF80W	30
ECCM	28
ECCM2I	28
ECCM2IS1	28
ECCMR	30
ECCR	30
ECCRR25	30
ECCRR500	30
ECCRSW	33
ECCS15GM	29
ECCS15GS	29
ECCS20AGM	29
ECCS20GM	29
ECCS20GS	29
ECCS25GM	29
ECCS32GM	29
ECCS40GM	29

CODE	PAGE
ECCS50GM	29
ECCSW	33
ECMC001	31
ECMC002	31
ECMC003	31
ECMC006	31
ECMC007	31
ECMC010	31
ECMR001	31
ECMR002	31
ECMR003	31
ECMR004	31
ECMR005	32
ECMR006	32
ECMR007	31
ECMR008	31
ECMR011	32
ECMR013	32
ECMR014	32
ECMR063	32
ECMR064	32
ECMR065	31
ECMR066	31
ECMR067	31
ECMR068	31
ECMR069	32
ECMR070	32
ECMR071	32
ECMR072	32
ECMR073	31
ECMR074	31
ECMR075	31
ECMR076	31
ECMR077	31
ECMR078	31
ECMR079	31
ECMR080	31
ECMR081	32
ECMR082	32
ECMR083	32
ECMR084	32
ECMR085	31
ECMR086	31
ECMR087	32
ECMR088	32
ECMR089	32
ECMR090	32
ECMR091	32
ECMR092	32
ECMR093	32
ECMR094	32
ECMR095	32
ECMR096	32
ECMR097	32
ECMR098	32

CODE	PAGE
ECMR099	32
ECMR100	32
ECMR101	32
ECMR102	32
ECMR103	32
ECMR104	32
ECMS001	31
ECMS002	31
ECMS005	31
ECMS006	31
ECMS007	31
ECMS008	31
ECMS009	31
ECMS010	31
ECMS011	31
ECMS012	31
EM70S	36
EP11	60
EP12	60
EP21	60
EP22	60
EV02F	34
EV05M	34
EV40	34
EV60	35
EV70A	41
EV70AK	41
EV70AQ	41
EV70AQB	41
EV70D	41
EV70DK	41
EV70DQ	41
EV70DQB	41
EV80	35
EV83	35
EV84	34
EV84A	34
EV85	35
EV87	35
EV90	35
EV91A	36
EV91B	36
EV91C	36
EV91D	36
EV92	36
FF71A	42
FF81	42
FF81P	43
FF82	43
FF84	42
FF91P	43
G23	18-20
G25	19
G27	19
G28	18-19-20

CODE	PAGE
G29	20
G30	19
G31	20
HR0901NB	44
HR0901NC	44
HR0901ND	44
HR0901NF	44
HR0901NG	44
HR0901NU	44
HR0901NW	44
HR0901NX	44
HR0901NZ	44
HR0910NB	44
HR0910NC	44
HR0910ND	44
HR0910NF	44
HR0910NG	44
HR0910NU	44
HR0910NW	44
HR0910NX	44
HR0910NZ	44
HR1301NB	44
HR1301NC	44
HR1301ND	44
HR1301NF	44
HR1301NG	44
HR1301NU	44
HR1301NW	44
HR1301NX	44
HR1301NZ	44
HR1310NB	44
HR1310NC	44
HR1310ND	44
HR1310NF	44
HR1310NG	44
HR1310NU	44
HR1310NW	44
HR1310NX	44
HR1310NZ	44
HR1701NB	44
HR1701NC	44
HR1701ND	44
HR1701NF	44
HR1701NG	44
HR1701NU	44
HR1701NW	44
HR1701NX	44
HR1701NZ	44
HR1710NB	44
HR1710NC	44
HR1710ND	44
HR1710NF	44
HR1710NG	44
HR1710NU	44
HR1710NW	44

CODE	PAGE
HR1710NX	44
HR1710NZ	44
HR2501NB	44
HR2501NC	44
HR2501ND	44
HR2501NF	44
HR2501NG	44
HR2501NU	44
HR2501NW	44
HR2501NX	44
HR2501NZ	44
HR2510NB	44
HR2510NC	44
HR2510ND	44
HR2510NF	44
HR2510NG	44
HR2510NU	44
HR2510NW	44
HR2510NX	44
HR2510NZ	44
HR33NB	44
HR33NC	44
HR33ND	44
HR33NF	44
HR33NG	44
HR33NU	44
HR33NW	44
HR33NX	44
HR33NZ	44
HR40NF	44
HR40NG	44
HR40NU	44
HR40NW	44
HR40NX	44
HR40NZ	44
HR46NB	44
HR46NC	44
HR46ND	44
HR46NF	44
HR46NG	44
HR46NU	44
HR46NW	44
HR46NX	44
HR46NZ	44
HR55NB	44
HR55NC	44
HR55ND	44
HR55NF	44
HR55NG	44
HR55NU	44
HR55NW	44
HR55NX	44
HR55NZ	44
HS0910YFHP	46
HS0910YUAP	46

CODE	PAGE
HS0910YUB	46
HS0910YUBP	46
HS0910YUD	46
HS0910YUDP	46
HS0910YUE	46
HS0910YUEP	46
HS0910YUF	46
HS0910YUFP	46
HS0910YUG	46
HS0910YUGP	46
HS0910YUH	46
HS0910YUHP	46
HS0910YUI	46
HS0910YUIP	46
HS0910YUL	46
HS0910YULP	46
HS0910YUM	46
HS0910YUMP	46
HS0910YUN	46
HS0910YUNP	46
HS0910YUO	46
HS0910YUOP	46
HS0910YUP	46
HS0910YUPP	46
HS0910YUQ	46
HS0910YUQP	46
HS0910YWA	46
HS0910YWAP	46
HS0910YWB	46
HS0910YWBP	46
HS0910YWC	46
HS0910YWCP	46
HS0910YWD	46
HS0910YWDP	46
HS0910YWE	46
HS0910YWEP	46
HS0910YWF	46
HS0910YWFP	46
HS0910YWG	46
HS0910YWGP	46
HS0910YWH	46
HS0910YWHP	46
HS0910YWI	46
HS0910YWIP	46
HS0910YWL	46
HS0910YWLP	46
HS0910YWM	46
HS0910YWMP	46
HS0910YWN	46
HS0910YWNP	46
HS0910YWO	46
HS0910YWOP	46
HS0910YWP	46
HS0910YWPP	46
HS0910YWQ	46

CODE	PAGE
HS0910YWQP	46
HS1310YUA	46
HS1310YUAP	46
HS1310YUB	46
HS1310YUBP	46
HS1310YUC	46
HS1310YUCP	46
HS1310YUD	46
HS1310YUDP	46
HS1310YUE	46
HS1310YUEP	46
HS1310YUF	46
HS1310YUFP	46
HS1310YUG	46
HS1310YUGP	46
HS1310YUH	46
HS1310YUHP	46
HS1310YUI	46
HS1310YUIP	46
HS1310YUL	46
HS1310YULP	46
HS1310YUM	46
HS1310YUMP	46
HS1310YUN	46
HS1310YUNP	46
HS1310YUO	46
HS1310YUOP	46
HS1310YUP	46
HS1310YUPP	46
HS1310YUQ	46
HS1310YUQP	46
HS1310YWA	46
HS1310YWAP	46
HS1310YWB	46
HS1310YWBP	46
HS1310YWC	46
HS1310YWCP	46
HS1310YWD	46
HS1310YWDP	46
HS1310YWE	46
HS1310YWEP	46
HS1310YWF	46
HS1310YWFP	46
HS1310YWG	46
HS1310YWGP	46
HS1310YWH	46
HS1310YWHP	46
HS1310YWI	46
HS1310YWIP	46
HS1310YWL	46
HS1310YWLP	46
HS1310YWM	46
HS1310YWMP	46
HS1310YWN	46
HS1310YWNP	46

CODE	PAGE
HS1310YWQ	46
HS1310YWOP	46
HS1310YWP	46
HS1310YWPP	46
HS1310YWQ	46
HS1310YWQP	46
HS1710YUA	46
HS1710YUAP	46
HS1710YUB	46
HS1710YUBP	46
HS1710YUC	46
HS1710YUCP	46
HS1710YUD	46
HS1710YUDP	46
HS1710YUE	46
HS1710YUEP	46
HS1710YUF	46
HS1710YUFP	46
HS1710YUG	46
HS1710YUGP	46
HS1710YUH	46
HS1710YUHP	46
HS1710YUI	46
HS1710YUIP	46
HS1710YUL	46
HS1710YULP	46
HS1710YUM	46
HS1710YUMP	46
HS1710YUN	46
HS1710YUNP	46
HS1710YUO	46
HS1710YUOP	46
HS1710YUP	46
HS1710YUPP	46
HS1710YUQ	46
HS1710YUQP	46
HS1710YWA	46
HS1710YWAP	46
HS1710YWB	46
HS1710YWBP	46
HS1710YWC	46
HS1710YWCP	46
HS1710YWD	46
HS1710YWDP	46
HS1710YWE	46
HS1710YWEP	46
HS1710YWF	46
HS1710YWFP	46
HS1710YWG	46
HS1710YWGP	46
HS1710YWH	46
HS1710YWHP	46
HS1710YWI	46
HS1710YWIP	46
HS1710YWL	46

CODE	PAGE
HS1710YWLP	46
HS1710YWM	46
HS1710YWMP	46
HS1710YWN	46
HS1710YWNP	46
HS1710YWO	46
HS1710YWOP	46
HS1710YWP	46
HS1710YWPP	46
HS1710YWQ	46
HS1710YWQP	46
HS2510YUA	46
HS2510YUAP	46
HS2510YUB	46
HS2510YUBP	46
HS2510YUC	46
HS2510YUCP	46
HS2510YUD	46
HS2510YUDP	46
HS2510YUE	46
HS2510YUEP	46
HS2510YUF	46
HS2510YUFP	46
HS2510YUG	46
HS2510YUGP	46
HS2510YUH	46
HS2510YUHP	46
HS2510YUI	46
HS2510YUIP	46
HS2510YUL	46
HS2510YULP	46
HS2510YUM	46
HS2510YUMP	46
HS2510YUN	46
HS2510YUNP	46
HS2510YUO	46
HS2510YUOP	46
HS2510YUP	46
HS2510YUPP	46
HS2510YUQ	46
HS2510YUQP	46
HS2510YWA	46
HS2510YWAP	46
HS2510YWB	46
HS2510YWBP	46
HS2510YWC	46
HS2510YWCP	46
HS2510YWD	46
HS2510YWDP	46
HS2510YWE	46
HS2510YWEP	46
HS2510YWF	46
HS2510YWFP	46
HS2510YWG	46
HS2510YWGP	46

CODE	PAGE
HS2510YWH	46
HS2510YWHP	46
HS2510YWI	46
HS2510YWIP	46
HS2510YWL	46
HS2510YWLP	46
HS2510YWM	46
HS2510YWMP	46
HS2510YWN	46
HS2510YWNP	46
HS2510YWO	46
HS2510YWOP	46
HS2510YWP	46
HS2510YWPP	46
HS2510YWQ	46
HS2510YWQP	46
HX1022EB	46
HX1022EC	46
HX1022ED	46
HX1022EF	46
HX1022EG	46
HX1022EU	46
HX1022EW	46
HX1022EX	46
HX1022EZ	46
HX1031EB	46
HX1031EC	46
HX1031ED	46
HX1031EF	46
HX1031EG	46
HX1031EU	46
HX1031EW	46
HX1031EX	46
HX1031EZ	46
HX1040EB	46
HX1040EC	46
HX1040ED	46
HX1040EF	46
HX1040EG	46
HX1040EU	46
HX1040EW	46
HX1040EX	46
HX1040EZ	46
I82	45
I84	45
I85	45
IDC01D	44
IDC01F	44
IDC01G	44
IDC01U	44
IDC10D	44
IDC10F	44
IDC10FB	44
IDC10U	44
IH13B	45

CODE	PAGE
IH13C	45
IH13D	45
IH13F	45
IH13G	45
IH13U	45
IH13W	45
IH13X	45
IH13Z	45
IH25B	45
IH25C	45
IH25D	45
IH25F	45
IH25G	45
IH25U	45
IH25W	45
IH25X	45
IH25Z	45
IM21D	53
IM21F	53
IM21H	53
IM21M	53
IM22	53
IM22A	53
IM29A	53
IM29F	53
IM29M	53
IM30A	53
IR02	44
IR11	44
IR13	44
IR22	44
IR31	44
IT60D	44
IT60I	44
IX02	47
IX04	47
IX11	47
IX13	47
IX20	47
IX22	47
IX31	47
IX40	47
JA25A	45
JA25B	45
JA25C	45
JA25D	45
JA25E	45
JA25F	45
JA25G	45
JA25H	45
JA25I	45
JA25L	45
JA25M	45
JA25N	45
JA25O	45

CODE	PAGE
JA25P	45
JA25Q	45
JA46A	45
JA46B	45
JA46C	45
JA46D	45
JA46E	45
K10C14KIT	48
K10C3KIT	48
K10C6KIT	48
K10C9KIT	48
K12C25	48
K12C50	48
K12C75	48
K13C100	48
K13C142	48
K13C30	48
K13C74	48
K15A100	49
K15A1000	49
K15A25	49
K15A50	49
K15A500	49
K15A75	49
K17C102	48
K17C129	48
K17C29	48
K17C73	48
K17C82	48
K20A100	49
K20A25	49
K20A50	49
K20A500	49
K30A100	49
K30A25	49
K30A50	49
K40A100	49
K40A25	49
K40A50	49
K50	49
K50AL	49
K55A100	49
K65A100	49
KBE3	49
KFAN	49
KIT1	49
KIT2	49
KJSSP	49
KSUPP	49
L02A12B	50
L02AM2	50
L02B11A	50
L02BM1A	50
L02C11B	50
L02C12B	50

CODE	PAGE
L02CM1	50
L02CM2	50
L02DI1B	50
L02DI2B	50
L02DM1	50
L02DM2	50
L03BI1A	50
L03BI2A	50
L03BM1A	50
L03BM2A	50
L04BM2A	50
L12BM	50
L14BM	50
L22EI1A	51
L22EM1A	51
L23EM1A	51
L24EM2	51
LS120	51
LS123	51
LS130	51
LS140	51
LS150	51
LS160A	51
LT312U	50
M20B3	52
M20C5	52
M20C51	52
M20D5	52
M20E7	52
M23C13	52
M23D13	52
M23E20	52
M23F25	52
M23G35	52
M23H40	52
M23I50	52
M29C13	53
M29D13	53
M29E20	53
M29F25	53
M29G35	53
M29H40	53
M29I50	53
N70A	36
O24A	37
O24AUX	40
O24B	37
O33A	37
O33BF	37
O33BM	37
O33CF	37
O33CM	37
O34A	37
O40NANCM	33
O41NCMAUX	33

CODE	PAGE
OCM1A	55
OCR1	54
OCS1	54
OCSV1A	55
OCV1A	55
OCVP1	55
ODA02	56
ODA10C	56
ODAL1	58
ODAL2	58
ODD08	56
ODD20S	57
ODD40	57
ODD52T	57
ODD52V	57
ODD54	57
ODD80	56
ODD98	56
ODHW01	58
ODIPC1	58
ODIPC2	58
ODIPS1	58
ODIPS2	58
ODK01T	57
ODK02E	57
ODST01	57
ODSW02	58
ODTS2AL	58
ODTS4AL	58
ODTS5CR	58
ODUSB	58
OK10	54
OK20	54
OK35	54
OK50	54
OMC1	55
OMC2	55
OMC3	55
OMC4	55
OMC5	55
OT10	54
OT15	54
OT20	54
OT25	54
OT25MS	54
OT35	54
OT40	54
OT40MS	54
OT50MS	54
OTB1	54
P11	60
P12	60
P21	60
P22	60
P30A	59

CODE	PAGE
P61AE	60
P63	60
P71	60
P71B	60
P71C	60
P72	60
P73	60
P81	59
P82	59
PKD2115NA	62
PKD2115NC	62
PKD2120NA	62
PKD2120NC	62
PKD2125NA	62
PKD2215NA	62
PKD2220NA	62
PKD2225NA	62
S71	59
S72	59
S80	59
S81	59
S82	59
S83	59
S84	59
S85	59
S86	59
T01A	40
T01B	40
T01D	40
T01E	40
T01F	40
T01G	40
T01H	40
T01L	40
T01M	40
T01N	40
T01P	40
T01Q	40
T01R	40
T01S	40
T01T	40
T01U	40
T01Z	40
T02A	40
T02B	40
T02C	40
T02D	40
T02G	40
T02H	40
T04A	40
T04B	40
T04C	40
T04D	40
T04E	40
T04F	40

CODE	PAGE
T04G	40
T05A	40
T06A	40
TAUX	40
TCEV80	35
UA03Y	12
UH13Y	45
UH13YP	45
UH25Y	45
UH25YP	45
VM001A	64
VM001B	64
VM001C	64
VM063A	63
VM063MA	63
VM063RA	63
VM064A	63
VM064MA	63
VM064RA	63
VM322A	63
VM322MA	63
VM802A	63
VM802MA	63
VM802RA	63
VM803A	63
VM803MA	63
VM803RA	63
VM804A	63
VM804MA	63
VM804RA	63
W04C	64
Z42A	33
Z42M	33
Z43B	33
Z43M	33
Z52A	37
Z52B	37
Z52L	37
Z52M	37
Z53A	37
Z53B	37
Z53L	37
Z53M	37
Z61C	38
Z61D	38
Z61E	38
Z61F	38
Z61G	38
Z62A	38
Z62B	38
Z62C	38
Z62D	38
Z63C	38
Z63D	38
Z63E	38

CODE	PAGE
Z63F	38
Z63G	38
Z64A	38
Z64B	38
Z64C	38
Z64D	38
ZC3100	39
ZC3125	39
ZC3150	39
ZC340	39
ZC350	39
ZC365	39
ZC380	39
ZC3A	39
ZC3B	39
ZC3C	39
ZC3M	39
ZC4100	39
ZC440	39
ZC450	39
ZC465	39
ZC480	39
ZC4A	39
ZC4B	39
ZC4C	39
ZC4M	39
ZDEV10	61
ZDEV10F	61
ZDEV15	61
ZDEV15F	61
ZDEV20	61
ZDEV20F	61
ZDEV25	61
ZDEV25F	61
ZDEV32	61
ZDEV32F	61
ZDEV40	61
ZDEV40F	61
ZDEV50	61
ZDEV50F	61
ZDEVRF100	61
ZDEVRF100F	61
ZDEVRF65	61
ZDEVRF65F	61
ZDEVRF80	61
ZDEVRF80F	61
ZDEV32NA	61
ZDEV32NAF	61
ZDEV32NC	62
ZDEV32NCF	62
ZDEV40NA	61
ZDEV40NAF	61
ZDEV40NC	62
ZDEV40NCF	62
ZDEV50NA	61

CODE	PAGE
ZDEV50NAF	61
ZDEV50NC	62
ZDEV50NCF	62
ZDEVRF100NA	61
ZDEVRF100NAF	61
ZDEVRF100NC	62
ZDEVRF100NCF	62
ZDEVRF65NA	61
ZDEVRF65NAF	61
ZDEVRF65NC	62
ZDEVRF65NCF	62
ZDEVRF80NA	61
ZDEVRF80NAF	61
ZDEVRF80NC	62
ZDEVRF80NCF	62
ZDVGRM15NA	61
ZDVGRM15NAF	61
ZDVGRM15NC	62
ZDVGRM15NCF	62
ZDVGRM20NA	61
ZDVGRM20NAF	61
ZDVGRM20NC	62
ZDVGRM20NCF	62
ZDVGRM25NA	61
ZDVGRM25NAF	61
ZDVGRM25NC	62
ZDVGRM25NCF	62
ZL30A	39
ZL30B	39
ZL30C	39
ZL30D	39
ZL30E	39
ZL30F	39
ZL31A	40
ZL31B	40
ZL31C	40
ZL31D	40
ZL31E	40
ZL31F	40
ZL31G	40
ZL31H	40
ZL31I	40

LEVEL CONTROLS

Electronic level controls with probes for conductive liquids



- Adjustable detection range kΩ.
- Level differential adjustable



CODE	POWER SUPPLY	CONTACT RATING	OPERATING TEMPERATURE	PROTECTION DEGREE
A03F	24 Vac	5A - AC12	-10 ÷ 50 °C	IP20
A03M	230 Vac	5A - AC12	-10 ÷ 50 °C	IP20
A04F	24 Vac	5A - AC12	-10 ÷ 50 °C	IP20
A04M	230 Vac	5A - AC12	-10 ÷ 50 °C	IP20
UA03Y				

CODE	DESCRIPTION	MAXIMUM TEMPERATURE	WEIGHT
EA18	Identification probe in AISI 303 stainless steel, 10 bar	160 °C	48 gr
EA19	Ballasted PVC probe with electrode (cable not included)	80 °C	75 gr
EA20	Stainless steel electronic probe AISI 303, 35 bar.	250 °C	88 gr
EA21	Ballasted PVC probe with electrode.	50 °C	350 gr
2013347	Stainless steel electrode - 1mt. Length		
2013348	Stainless steel electrode - 2mt. Length		

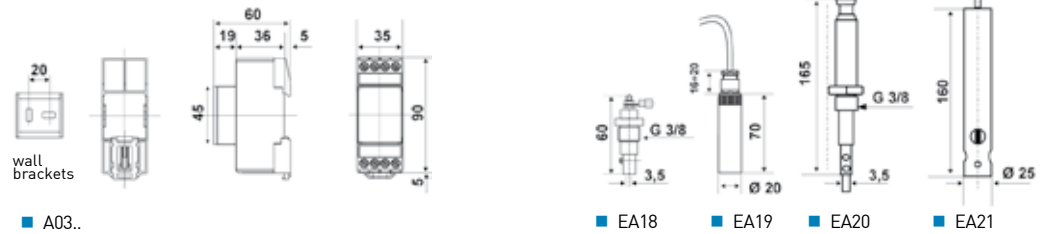

Magnetic level control for under pressure systems



- Operation by means of repulsion of two permanent opposed magnets.
- Maximum liquid temperature 150°C.



CODE	ADJUSTABLE LEVEL mm	MAXIMUM OPERATING PRESSURE	MATERIALS IN CONTACT WITH THE LIQUID	SPDT CONTACT RATING	FLANGE CONNECTION
AD22	25 ÷ 175	6 bar	steel	10(3)A 250Vac	PN6
AD23	20 ÷ 180	6 bar	steel	10(3)A 250Vac	PN6
AD23A	20 ÷ 180	6 bar	steel teflon-coated	10(15)A 250Vac	PN6
AD23B	20 ÷ 180	16 bar	steel	10(15)A 250Vac	PN16
AD23C	20 ÷ 180	16 bar	steel teflon-coated	10(15)A 250Vac	PN16

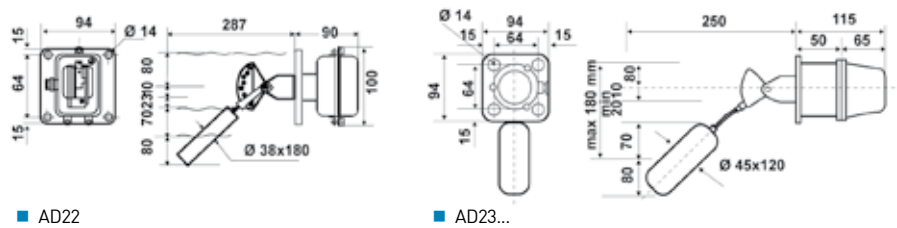

Magnetic level controls for under pressure systems



- Operation by means of repulsion of two permanent opposed magnets.



CODE	FLOAT TYPE	ADJUSTABLE LEVEL mm	MAXIMUM OPERATING PRESSURE	MAXIMUM LIQUID TEMPERATURE	SPDT CONTACT RATING	CONNECTION
AD52	steel	20 ÷ 55	10 bar	110 °C	10(3)A 250Vac	G 1 1/4
AD52P	plastic	20 ÷ 55	10 bar	100 °C •	10(3)A 250Vac	G 1 1/4
AD52PS1	plastic	20 ÷ 55	10 bar	100 °C •	10(3)A 250Vac	G 1

EAD01 Float in stainless steel Ø 38x115 mm.

- recommended for the control of water with maximum 85°C.

DIMENSIONS mm	FLOAT
AD52	Ø 38 x 115
AD52P	Ø 38 x 70
AD52PS	Ø 30 x 100

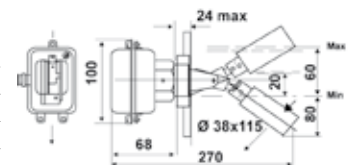

Magnetic level controls for under pressure systems



- Die-cast aluminium waterproof enclosure.
- Internal parts AISI 316.



CODE	ADJUSTABLE LEVEL mm	MAXIMUM OPERATING PRESSURE	MAXIMUM LIQUID TEMPERATURE	CONNECTION	SPDT CONTACT RATING
A42A	15 ÷ 50	16 bar	200 °C	thread G1	5(2)A 250Vac
A41A	25 ÷ 50	16 bar	200 °C	flange	5(2)A 250Vac
	25 ÷ 75	16 bar	200 °C	flange	5(2)A 250Vac
A41B	55 ÷ 210	16 bar	200 °C	flange	5(2)A 250Vac
	65 ÷ 305	16 bar	200 °C	flange	5(2)A 250Vac
	95 ÷ 370	16 bar	200 °C	flange	5(2)A 250Vac
	140 ÷ 570	16 bar	200 °C	flange	5(2)A 250Vac

	L
A41A	135 ÷ 325
A41B	335 ÷ 780

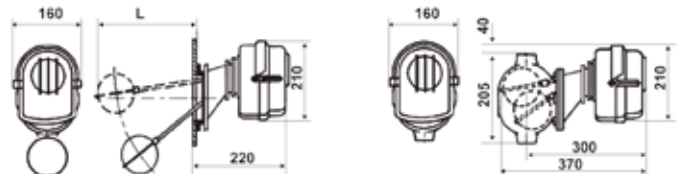

■ A41A-A41B

■ A42A

Electromechanical float switch for three-phase motor control



- For emptying and filling.



CODE	ADJUSTABLE LEVEL mm	NYLON CABLE LENGTH	MAXIMUM LIQUID TEMPERATURE	SPDT CONTACT RATING
A70	50 ÷ 750 •	1	50 °C	415Vac 20(9)A.

• Indicated level differential is obtained using the serial cables. With cables of different lengths it is possible to obtain level differentials of up to several meters.

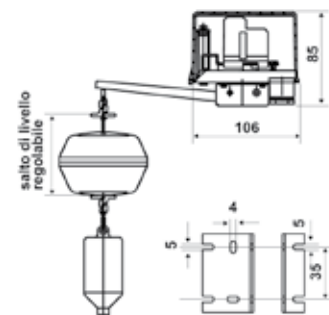

A

Electromechanical submersible level controls for clear or contaminated water



- A94 controls sewage.
- Moplen external body.



CODE	CABLE TYPE	CABLE LENGTH MT	SPDT CONTACT RATING	MAXIMUM IMMERSION PRESSURE	MAXIMUM LIQUID TEMPERATURE
A94C	PVC	5	10(4)A 250Vac	10 bar	60 °C
A94D	PVC	15	10(4)A 250Vac	10 bar	60 °C
A95A	PVC	3	10(4)A 250Vac	10 bar	60 °C
A95AS1	PVC	5	10(4)A 250Vac	10 bar	60 °C
A95B	PVC	10	10(4)A 250Vac	10 bar	60 °C
A95BS1	PVC	15	10(4)A 250Vac	10 bar	60 °C
A95AS2	neoprene	3	10(4)A 250Vac	10 bar	60 °C
A95AS3	neoprene	5	10(4)A 250Vac	10 bar	60 °C
A95BS4	neoprene	10	10(4)A 250Vac	10 bar	60 °C
A95BS5	neoprene	15	10(4)A 250Vac	10 bar	60 °C
A95BS6	neoprene	20	10(4)A 250Vac	10 bar	60 °C
A95BS7	neoprene	25	10(4)A 250Vac	10 bar	60 °C

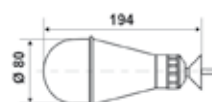

■ A94...

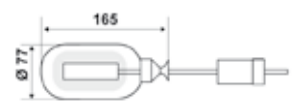

■ A95...

Electromechanical submersible level controls for hazardous areas liquids



CODE	CABLE TYPE	CABLE LENGTH MT	SPDT CONTACT RATING	MAXIMUM IMMERSION PRESSURE	MAXIMUM LIQUID TEMPERATURE
A96C	polyurethane	5	5A 250 Vac	4 bar	60 °C
A96D	polyurethane	15	5A 250 Vac	4 bar	60 °C
A96E	silicone	5	5A 250 Vac	4 bar	130 °C
A96G	silicone	15	5A 250 Vac	4 bar	130 °C

- External float body made of AISI 304 stainless steel.

IP68



Electronic level controls with internal safety barrier



CODE	POWER SUPPLY	INPUT(S) IN DANGER ZONE	OUTPUT(S) IN SAFE ZONE
EA31M	220Vac-50HZ	voltage free NA/NC unprotected contacts	2 relays with 1 switching contact 250V-2,5A - 100VA
EA32F	24Vdc	voltage free NA/NC unprotected contacts	2 relays with 1 switching contact 250V-2,5A - 100VA

IP40 230V 24V

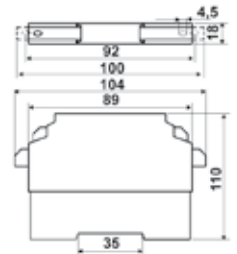

Bladed level controls for granules



CODE	TYPE	ADJUSTABLE LEVEL mm	OPERATING TEMPERATURE	SPDT CONTACT RATING
ASE	blades	50 fixed	-20 ÷ 80 °C	10(4)A 250Vac

- To control materials with a specific gravity of approximately 0,7 kg/dm³.

IP54 230V

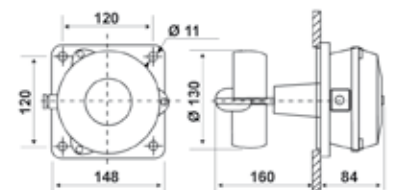

Bladed level controls for powders and granules



CODE	ADJUSTABLE LEVEL mm	LEVEL DIFFERENTIAL CONTROL AND CHANGE mm	OPERATING TEMPERATURE	SPDT CONTACT RATING
ASM2	50 ÷ 100 operation and stop 30 ÷ 50 release and start	20 ÷ 50	-20 ÷ 70 °C	10(3)A 250Vac

- To control materials with a specific gravity of approximately 0,7 kg/dm³
- 2 microswitches for control and alarm.

IP54

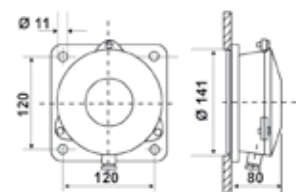

PRESSURE CONTROLS

Pressure switches up to 15 bar with non-adjustable differential



CODE	RANGE bar	DIFFERENTIAL* bar	SENSITIVE ELEMENT MAX. PRESSURE bar	CONNECTION G 1/4
B01A	0,7 ÷ 3	0,4	6	female
B01B	2 ÷ 5,5	0,6	7	female
B01C	3 ÷ 7	0,6	9	female
B01D	4 ÷ 15	1	18	female
B01A4	0,7 ÷ 3	0,4	6	male
B01B4	2 ÷ 5,5	0,6	7	male
B01C4	3 ÷ 7	0,6	9	male
B01D4	4 ÷ 15	1	18	male
B01AM	0,7 ÷ 3	0,4	6	female
B01BM ISPESEL	2 ÷ 5,5	0,6	7	female
B01CM	3 ÷ 7	0,6	9	female
B01DM	4 ÷ 15	1	18	female
B01AM4	0,7 ÷ 3	0,4	6	male
B01BM4	2 ÷ 5,5	0,6	7	male
B01CM4	3 ÷ 7	0,6	9	male
B01DM4	4 ÷ 15	1	18	male
B01ARI	0,7 ÷ 3	0,4	6	female
B01BRI	2 ÷ 5,5	0,6	7	female
B01CRI	3 ÷ 7	0,6	9	female
B01DRI	4 ÷ 15	1	18	female
B01A4RI	0,7 ÷ 3	0,4	6	male
B01B4RI	2 ÷ 5,5	0,6	7	male
B01C4RI	3 ÷ 7	0,6	9	male
B01D4RI	4 ÷ 15	1	18	male
303298LA	G1/2 cable gland in V0 self-extinguishing, shockproof thermoplastic material for output connections.			

- Elements in contact with fluid are in stainless steel, laser welded.
- Automatic and manual reset.
- Internal regulation
- SPDT contact rating 250Vac 10(2,5)A.

* The differential is to be deducted from the range value.

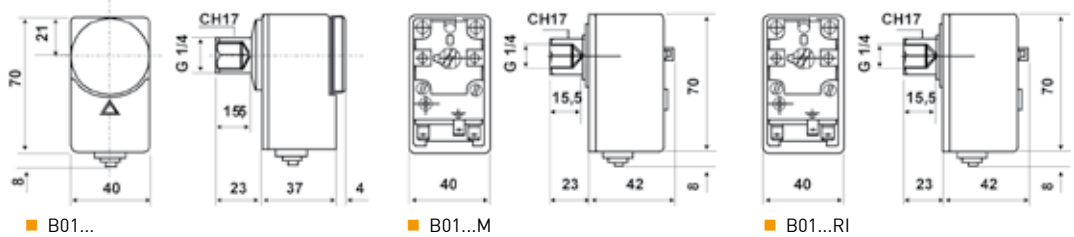

IP40 ISPESEL

Hydrostats, pressure and vacuum pressure switches up to 10 bar



CODE	RANGE bar	DIFFERENTIAL* bar	SENSITIVE ELEMENT MAX. PRESSURE BAR	CONNECTION G 1/4	PROTECTION DEGREE
B11AN	0,15 ÷ 1	0,1 fixed	20	female	IP40
B11AN4	0,15 ÷ 1	0,1 fixed	20	male	IP40
B11ANY	0,15 ÷ 1	0,1 fixed	20	female	IP65
B11AN4Y	0,15 ÷ 1	0,1 fixed	20	male	IP65
B12AN	-0,82 ÷ 0	0,1 fixed	2,5	female	IP40
B12AN4	-0,82 ÷ 0	0,1 fixed	2,5	male	IP40
B12BN	0,2 ÷ 2	0,1 ÷ 0,5	4	female	IP40
B12ANY	-0,82 ÷ 0	0,1 fixed	2,5	female	IP65
B12BNY	0,2 ÷ 2	0,1 ÷ 0,5	4	female	IP65
303298LA	G1/2 cable gland in V0 self-extinguishing, shockproof thermoplastic material for output connections.				
2593367	Protection casing IP44				

- Elements in contact with fluid are in stainless steel, laser welded.
- SPDT contact rating 250Vac 16(6)A.

* The differential is to be deducted from the range value.

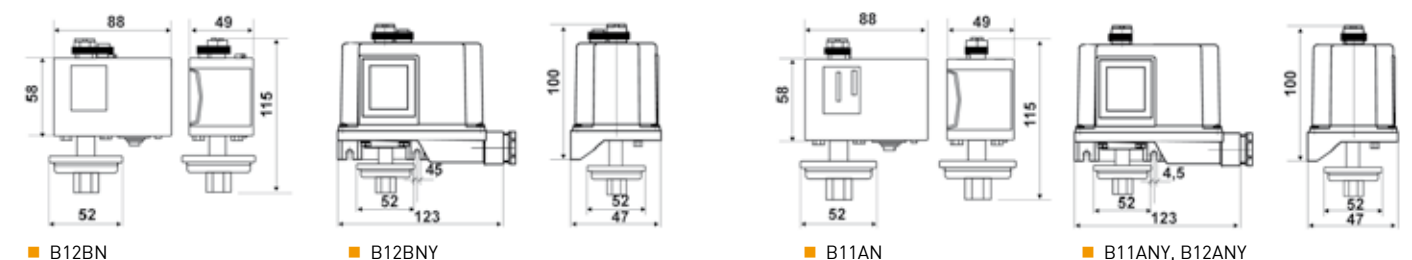

IP40 IP44 IP65

Pressure switches up to 10 bar with low adjustable differential



CODE	RANGE bar	DIFFERENTIAL* bar	SENSITIVE ELEMENT MAX. PRESSURE BAR	CONNECTION G 1/4
B13BN	0,3 ÷ 4	0,1 ÷ 0,5	6	male
B13CN	1 ÷ 10	0,3 ÷ 1,5	16	male
B13BNY	0,3 ÷ 4	0,1 ÷ 0,5	6	male
B13CNY	1 ÷ 10	0,3 ÷ 1,5	16	male

303298LA G1/2 cable gland in V0 self-extinguishing, shockproof thermoplastic material for output connections.

2593367 Protection casing IP44

* The differential is to be deducted from the range value.

- Metal bellow in copper alloys.
- SPDT contact rating 250Vac 16(6)A.

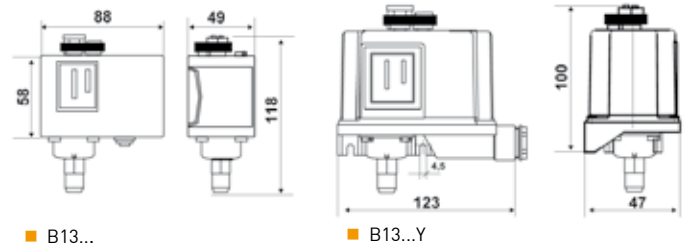

Pressure switches up to 28 bar



CODE	RANGE bar	DIFFERENTIAL* bar	SENSITIVE ELEMENT MAX. PRESSURE BAR	CONNECTION G 1/4
B12CN	-0,2 ÷ 8	0,6 ÷ 3	9	female
B12DN	5 ÷ 16	1 ÷ 3,5	18	female
B12EN	8 ÷ 28	2 ÷ 6	32	female
B12CRN	-0,2 ÷ 8	0,6 ÷ 3	9	SAE
B12ERN	8 ÷ 28	2 ÷ 6	32	SAE
B12CN4	-0,2 ÷ 8	0,6 ÷ 3	9	male
B12DN4	5 ÷ 16	1 ÷ 3,5	18	male
B12CMN	1 ÷ 8	0,6 ÷ 3	9	female
B12DMN	5 ÷ 16	1 ÷ 3,5	18	female
B12EMN	8 ÷ 28	2 ÷ 6	32	female
B12CNY	-0,2 ÷ 8	0,6 ÷ 3	9	female
B12DNY	5 ÷ 16	1 ÷ 3,5	18	female
B12ENY	8 ÷ 28	2 ÷ 6	32	female
B12CRNY	-0,2 ÷ 8	0,6 ÷ 3	9	SAE
B12ERNY	8 ÷ 28	2 ÷ 6	32	SAE

303298LA G1/2 cable gland in V0 self-extinguishing, shockproof thermoplastic material for output connections.

2593367 Protection casing IP44

* The differential is to be deducted from the range value.

- Elements in contact with fluid are in stainless steel, laser welded.
- SPDT contact rating 250Vac 16(6)A.

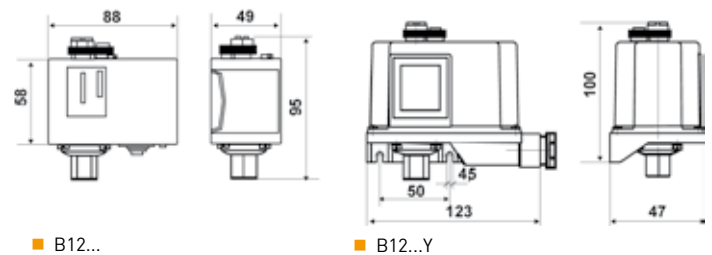

Pressure switches up to 300 bar



CODE	RANGE bar	DIFFERENTIAL* bar	SENSITIVE ELEMENT MAX. PRESSURE BAR	CONNECTION G 1/4
B12FN	12 ÷ 50	6 ÷ 15	60	male
B12GN	25 ÷ 150	12 ÷ 40	180	male
B12HN	60 ÷ 300	40 ÷ 80	350	male
B12FMN	12 ÷ 50	6 ÷ 15	60	male
B12GMN	25 ÷ 150	12 ÷ 40	180	male
B12HMN	60 ÷ 300	40 ÷ 80	350	male
B12FNY	12 ÷ 50	6 ÷ 15	60	male
B12GNY	25 ÷ 150	12 ÷ 40	180	male
B12HNY	60 ÷ 300	40 ÷ 80	350	male
B12MN ISPEL	1 ÷ 5 bar	0,6 fixed	9	female
B12MNY	1 ÷ 5 bar	0,6 fixed	9	female
303298LA	G1/2 cable gland in V0 self-extinguishing, shockproof thermoplastic material for output connections.			
2593367	Protection casing IP44			

■ SPDT contact rating 250Vac 16(6)A.



* The differential is to be deducted from the range value.

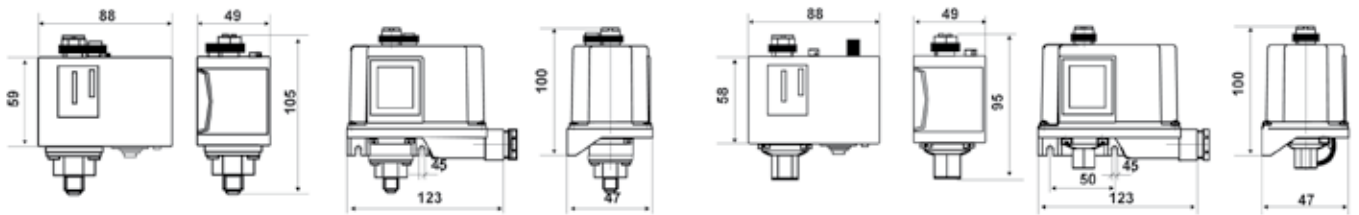

■ B12FN, B12GN, B12HN

■ B12FNY, B12GNY, B12HNY

■ B12MN

■ B12MNY

Pressure switches for single/two/three-phase motors direct control



CODE	RANGE bar	DIFFERENTIAL START OF SCALE bar	FULL SCALE	MAXIMUM DIFFERENTIAL bar	PROTECTION DEGREE	CONTROL
B70A	0,5 ÷ 7 bar	0,8 bar	1,8 bar	3,5	IP40	three-phase
B71A	1,5 ÷ 4,5 bar	1,0 ÷ 2,1 bar	1,2 ÷ 2,3 bar	2,3	IP20	single-phase / two-phase

- B70A SPDT contact rating 415Vac 20(9)A.
- B71A SPDT contact rating 415Vac 12(3)A.

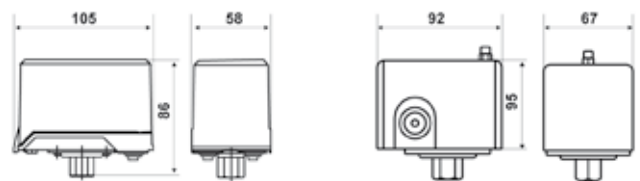

■ B70A

■ B71A

Accessories



CODE	
303298LA	G1/2 cable gland in V0 self-extinguishing, shockproof thermoplastic material for output connections.
2593367	Protection casing IP44

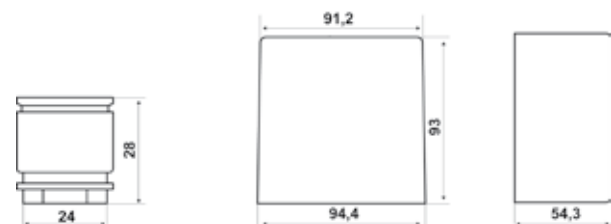

■ 303298LA

■ 2593367

TEMPERATURE CONTROLS

Strap-on pipe thermostat



CODE	TEMPERATURE RANGE	DIFFERENTIAL* K	ADMISSIBLE BODY TEMPERATURE	MAXIMUM BULB TEMPERATURE
C01A	20 ÷ 90 °C	8	120 °C	120 °C
C01B	10 ÷ 60 °C	8	120 °C	120 °C
C01AM	20 ÷ 90 °C	8	120 °C	120 °C
C01ARI	20 ÷ 90 °C	8	120 °C	120 °C

303298LA G1/2 cable gland in V0 self-extinguishing, shockproof thermoplastic material for output connections

* The differential is to be deducted from the range value.

- SPDT contact rating 15(6)A 250V~.
- AGcdO contacts.
- Faston connections.

IP40

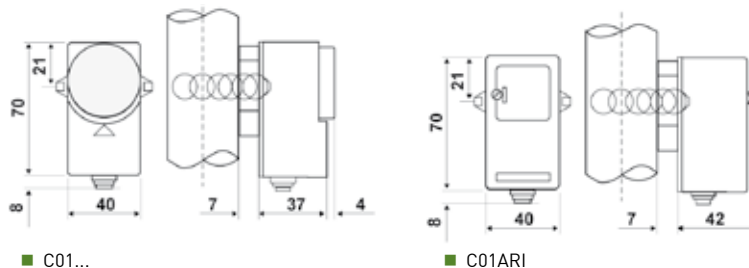

Rear panel thermostats for remote mounting



CODE	TEMPERATURE RANGE	DIFFERENTIAL* K	ADMISSIBLE BODY TEMPERATURE	MAXIMUM BULB TEMPERATURE	CAPILLARY LENGTH mt
C02A3	10 ÷ 90 °C	6 ± 1	120 °C	150 °C	1
C02B3	50 ÷ 300 °C	8 ± 2	120 °C	350 °C	1,5
C02C2	- 20 ÷ 40 °C	2 ± 0,5	60 °C	80 °C	1,5
C02D2	- 35 ÷ 20 °C	2 ± 0,5	50 °C	80 °C	1,5
C02E3	40 ÷ 120 °C	6 ± 2	120 °C	150 °C	1
C02F	50 ÷ 320 °C	10 ± 2	120 °C	330 °C	1

* The differential is to be deducted from the range value.

2554972 Metallic ring for thermoplastic control knobs.

2754975 Metallic ring for stainless steel control knobs.

2724259 Control knob for C02A3

2724260 Control knob for C02B3

2723094 Control knob for C02C2

2723095 Control knob for C02D2

2724261 Control knob for C02E3

2723856 Control knob for C02F

5677050 Group of range limiters, used for knobs

G28 Copper sheath Gc 1/2 PN10 bar, length 177 mm, including spring to mount the capillary

G23 Seal cap Gc 1/2, PN10 bar, without casing for C02-C04-C09

- SPDT contact rating 15(6)A 250V~.
- AGcdO contacts.
- Faston connections.

IP00



	L	D
C02A3	69	6,5
C02B3	65	5
C02C2	144	6
C02D2	144	6
C02E3	69	6,5
C02F	195	3,5

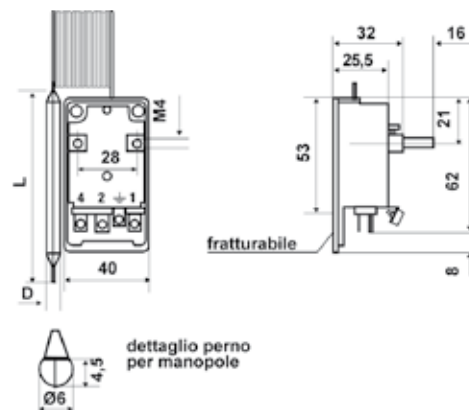

Immersion thermostats



CODE	TEMPERATURE RANGE	DIFFERENTIAL* K	CALIBRATION ACCURACY	ADMISSIBLE BODY TEMPERATURE	MAXIMUM BULB TEMPERATURE
C03A3 ISPESEL	10 ÷ 90 °C	6 ± 1	± 3 °C	120 °C	150 °C
C03B3	40 ÷ 120 °C	6 ± 1	± 3 °C	120 °C	150 °C
C03C3	10 ÷ 90 °C	6 ± 1	± 3 °C	120 °C	135 °C
C03A3RI	10 ÷ 90 °C	6 ± 1	± 3 °C	120 °C	150 °C
C03B3RI	40 ÷ 120 °C	6 ± 1	± 3 °C	120 °C	150 °C
C08A	0 ÷ 110 °C	6 ± 1 K	± 3 °C	120 °C	150 °C
C08B	90 ÷ 200 °C	6 ± 2 K	± 3 °C	120 °C	250 °C

* The differential is to be deducted from the range value.

- SPDT contact rating 15(6)A 250V~.
- AGcdO contacts.



G25	Copper sheath Gc 1/2 PN10 bar, length 220 mm, Ø 8mm.
G27	Copper sheath Gc 1/2 PN10 bar with length 145mm Ø 8mm.
G30	Copper sheath Gc 1/2 PN10 bar with length 100mm Ø 8mm.
303298LA	G1/2 cable gland in V0 self-extinguishing, shockproof thermoplastic material for output connections

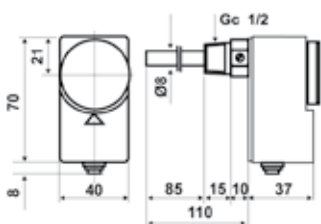

■ C03..

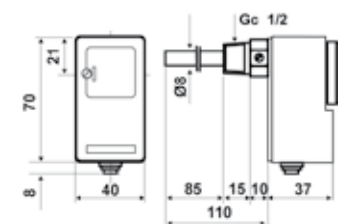

■ C03..RI

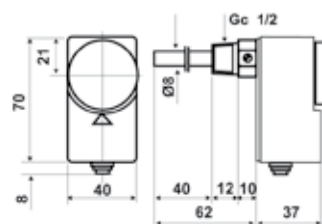

■ C03C3

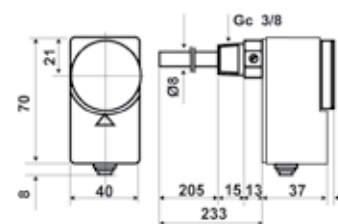

■ C08

Thermostats with capillary and bulb for remote mounting



CODE	TEMPERATURE RANGE	DIFFERENTIAL* K	CALIBRATION ACCURACY	MAXIMUM BULB TEMPERATURE	ADMISSIBLE BODY TEMPERATURE	CAPILLARY LENGTH mt
C04A3	10 ÷ 90 °C	6 ± 1	± 3 °C	120 °C	150 °C	1
C04B3	50 ÷ 300 °C	8 ± 2	± 3 °C	120 °C	350 °C	1,5
C04C2	- 20 ÷ 40 °C	2 ± 0,5	± 2 °C	60 °C	80 °C	1,5
C04D2	- 35 ÷ 20 °C	2 ± 0,5	± 2 °C	50 °C	80 °C	1,5
C04E3	40 ÷ 120 °C	6 ± 2	± 3 °C	120 °C	150 °C	1
C04A3RI	10 ÷ 90 °C	6 ± 1	± 3 °C	120 °C	150 °C	1
C04C2RI	- 20 ÷ 40 °C	2 ± 0,5	± 2 °C	60 °C	80 °C	1,5
C04A3Y	10 ÷ 90 °C	6 ± 1	± 3 °C	120 °C	150 °C	1
C04B3Y	50 ÷ 300 °C	8 ± 2	± 3 °C	120 °C	350 °C	1,5
C04C2Y	- 20 ÷ 40 °C	2 ± 0,5	± 2 °C	60 °C	80 °C	1,5
C04D2Y	- 35 ÷ 20 °C	2 ± 0,5	± 2 °C	50 °C	80 °C	1,5
C04E3Y	40 ÷ 120 °C	6 ± 2	± 3 °C	120 °C	150 °C	1
C04C2RIY	- 20 ÷ 40 °C	2 ± 0,5	± 2 °C	60 °C	80 °C	1,5

* The differential is to be deducted from the range value.

- SPDT contact rating 15(6)A 250V~.
- AGcdO contacts.



G28	Copper sheath Gc 1/2 PN10 bar, length 177 mm, including spring to mount the capillary
303298LA	G1/2 cable gland in V0 self-extinguishing, shockproof thermoplastic material for output connections

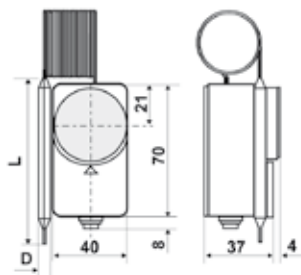

	L	D
C04A3	69	6,5
C04B3	65	5
C04C2	144	6
C04D2	144	6
C04E3	69	6,5

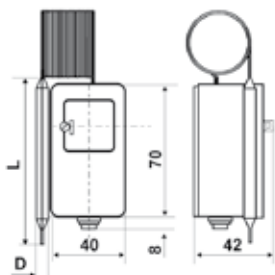

	L	D
C04A3RI	69	6,5
C04B3RI	87	5
C04C2RI	144	6
C04D2RI	144	6
C04E3RI	69	6,5

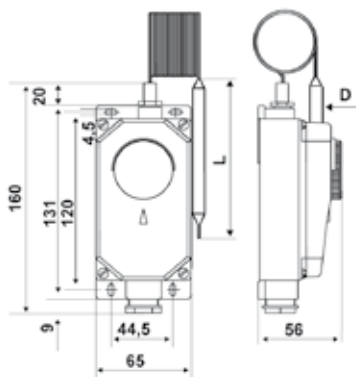

	L	D
C04A3Y	69	6,5
C04B3Y	65	5
C04C2Y	144	6
C04D2Y	144	6
C04E3Y	69	6,5

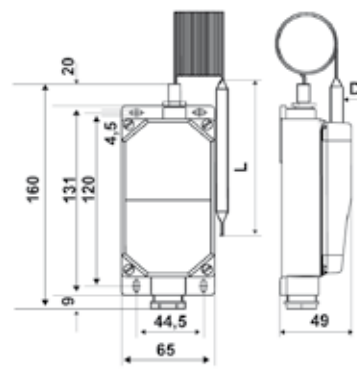

	L	D
C04A3RIY	69	6,5
C04A3RIY	87	5
C04C2RIY	144	6
C04D2RIY	144	6
C04E3RIY	69	6,5

C

Failure safe lockout immersion thermostats and bithermostat



CODE	TEMPERATURE RANGE	LOCKOUT ACTION	LOCKOUT ACTION TOLERANCE	ADMISSIBLE BODY TEMPERATURE	MAXIMUM BULB TEMPERATURE	PROTECTION DEGREE
C06A3M ISPESEL	100 °C fixed	100 °C	+ 0 - 6 °C	120 °C	150 °C	IP40
C06B3M	90 °C fixed	90 °C	+ 0 - 6 °C	120 °C	150 °C	IP40
C07A3M ISPESEL	10 ÷ 90 °C	100 °C	+ 0 - 6 °C	120 °C	130 °C	IP40
C09A3M ISPESEL	100 °C fixed	100 °C	+ 0 - 6 °C	120 °C	120 °C	IP00

G23	Seal cap Gc 1/2 PN10 bar, without sheath for C09					
G28	Copper sheath Gc 1/2 PN10 bar, length 177mm, supplied with spring to fix the capillary for C09A3M					
G29	Copper sheath Gc 1/2 PN10 bar with length 110mm Ø 8mm.					
G31	Copper sheath with length 100mm, Gc 1/2" PN10 for C07					
303298LA	G1/2 cable gland in V0 self-extinguishing, shockproof thermoplastic material for output connections.					

* The differential is to be deducted from the range value.

- SPDT contact rating 15(6)A 250V~.
- AGcdO contacts.

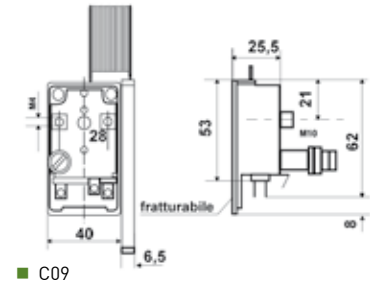
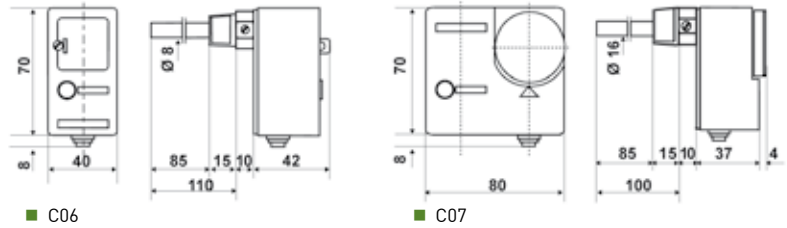

Thermostats with spiral capillary



CODE	TEMPERATURE RANGE	DIFFERENTIAL	ADMISSIBLE BODY TEMPERATURE	PROTECTION DEGREE
C10A2	0 ÷ 60 °C	2 ± 0,5 K	80 °C	IP40
C10B2	- 20 ÷ 40 °C	2 ± 0,5 K	60 °C	IP40
C10C2	- 35 ÷ 20 °C	2 ± 0,5 K	50 °C	IP40
C10A2RI	0 ÷ 60 °C	2 ± 0,5 K	80 °C	IP40
C10B2RI	- 20 ÷ 40 °C	2 ± 0,5 K	60 °C	IP40
C10C2RI	- 35 ÷ 20 °C	2 ± 0,5 K	50 °C	IP40
C10A2Y	0 ÷ 60 °C	2 ± 0,5 K	80 °C	IP65
C10B2Y	- 20 ÷ 40 °C	2 ± 0,5 K	60 °C	IP65
C10C2Y	- 35 ÷ 20 °C	2 ± 0,5 K	50 °C	IP65
C10A2RIY	0 ÷ 60 °C	2 ± 0,5 K	80 °C	IP65
C10B2RIY	- 20 ÷ 40 °C	2 ± 0,5 K	60 °C	IP65
C10C2RIY	- 35 ÷ 20 °C	2 ± 0,5 K	50 °C	IP65

303298LA G1/2 cable gland in V0 self-extinguishing, shockproof thermoplastic material for output connections

- SPDT contact rating 15(6)A 250V~.
- AGcdO contacts.

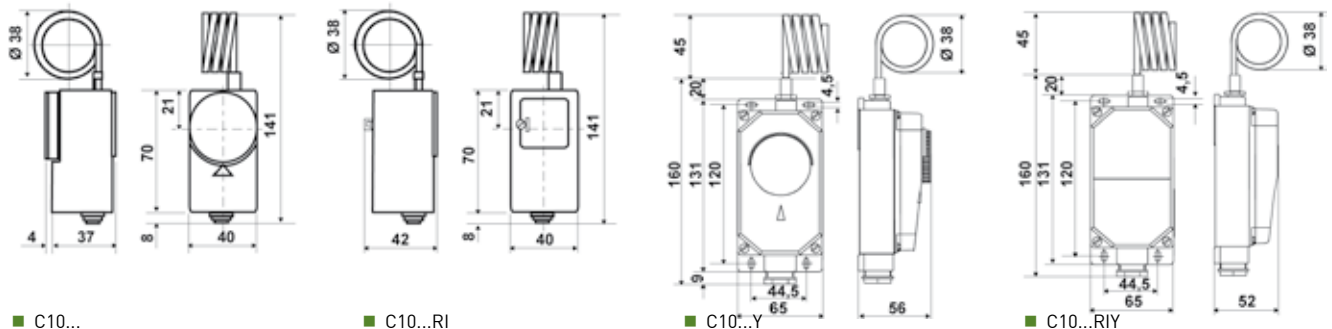

Electromechanical room thermostats with vapor expansion



CODE	TEMPERATURE RANGE	DIFFERENTIAL*	ADMISSIBLE BODY TEMPERATURE	SPDT CONTACT RATING
C16	10 ÷ 30 °C	0,8 K	-10 ÷ 50 °C	10(2,5)A 250Vac
C16L	WITH PILOT LIGHT			
C16I	WITH ON-OFF SWITCH			
C16IL	WITH ON-OFF SWITCH AND PILOT LIGHT			
C16EH	WITH SUMMER-WINTER SWITCH			
C16EHL	WITH SUMMER -WINTER SWITCH AND PILOT LIGHT			

* The differential is to be deducted from the range value.

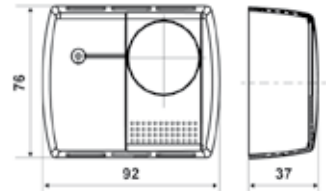

Room thermostats, wall mounting



CODE	TEMPERATURE RANGE	POWER SUPPLY	SPDT CONTACT RATING
C60	6 ÷ 30°C	230Vac	6(1,5)A 250Vac
C63	6 ÷ 30°C	3 batteries AAA 1,5 V	5(3)A-250Vac

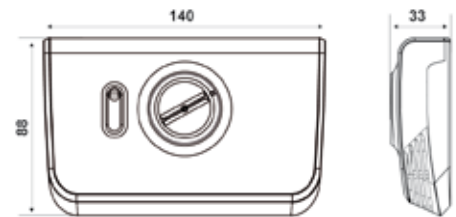

Flush-mounting room thermostats



CODE	COLOUR	TEMPERATURE RANGE	SPDT CONTACT RATING	POWER SUPPLY
C44	with display	anthracite	2 ÷ 40 °C	5(3)A-250Vac
C44B	with display	white	2 ÷ 40 °C	5(3)A-250Vac
C44C	with display	silver	2 ÷ 40 °C	5(3)A-250Vac
C47	with knob	anthracite	5 ÷ 30 °C	5(3)A-250Vac
C47B	with knob	white	5 ÷ 30 °C	5(3)A-250Vac
C47C	with knob	silver	5 ÷ 30 °C	5(3)A-250Vac
C47EH	with knob	anthracite	5 ÷ 30 °C	5(3)A-250Vac
C47EHB	with knob	white	5 ÷ 30 °C	5(3)A-250Vac
C48	with knob	anthracite	5 ÷ 30 °C	5(3)A-250Vac
C48B	with knob	white	5 ÷ 30 °C	5(3)A-250Vac
C48C	with knob	silver	5 ÷ 30 °C	5(3)A-250Vac
C50	with display	anthracite	8 ÷ 40°C	5(3)A-250Vac
C50B	with display	white	8 ÷ 40°C	5(3)A-250Vac
C50C	with display	silver	8 ÷ 40°C	5(3)A-250Vac

COMPATIBLE PLATES
 BTICINO Living International, Living transizione,
 Living-light round LNA and square LNB
 BTICINO Light, Light Tech
 BTICINO Axolute
 VIMAR Idea and Rondò
 VIMAR Plana, Eikon
 GEWISS Playbus and Playbus Young
 AVE sistema 45, Noir, Blanc
 AVE Banquise, Ave Yes
 SIEMENS Delta Futura Graphit
 LEGRAND Cross

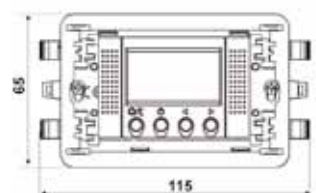

Room thermostats



CODE	COLOR	TEMPERATURE RANGE	POWER SUPPLY	SPDT CONTACT RATING
CH110	white	2 ÷ 40 °C	2 batteries AAA 1,5V	5(3)A 250Vac
CH111	silver	2 ÷ 40 °C	2 batteries AAA 1,5V	5(3)A 250Vac
CH112	anthracite	2 ÷ 40 °C	2 batteries AAA 1,5V	5(3)A 250Vac

- Possibility to visualize Celsius or Fahrenheit temperature values.

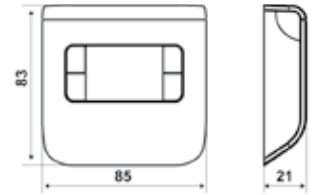

Room thermostats



CODE	COLOR	TEMPERATURE RANGE	POWER SUPPLY	SPDT CONTACT RATING
CH115	white	2 ÷ 40 °C	2 batteries AA 1,5V	5(3)A 250Vac
CH116	silver	2 ÷ 40 °C	2 batteries AA 1,5V	5(3)A 250Vac
CH117	anthracite	2 ÷ 40 °C	2 batteries AA 1,5V	5(3)A 250Vac
CH115-16	white	2 ÷ 40 °C	2 batteries AA 1,5V	16(4)A 250Vac
CH115RF	white	2 ÷ 40 °C	2 batteries AA 1,5V	5(3)A 250Vac
CH173D	receiver actuator, DIN rail mounting - power supply 230Vac 50Hz - contact rating 5(3)A 250Vac			

- Possibility to visualize Celsius or Fahrenheit temperature values.

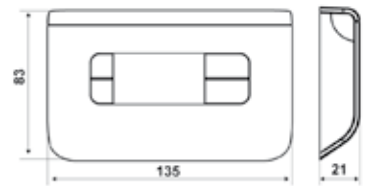

Room thermostats for fan-coils



CODE	DESCRIPTION	SPEEDS	TEMPERATURE RANGE	POWER SUPPLY
C61	for fan-coils	3 speeds	6 ÷ 30 °C	230V-50HZ
CH130RR	remote relay	3 speeds	2 ÷ 40 °C	actuator CH172D
CH130RFR	radio frequency	3 speeds	2 ÷ 40 °C	actuator CH172D
CH130ARR	remote relay	3 speeds + auto	2 ÷ 40 °C	2 batteries AA 1,5V
CH130ARFR	radio frequency	3 speeds + auto	2 ÷ 40 °C	2 batteries AA 1,5V
CH172DRF	radio frequency actuator for CH13...			
CH172DS	remote relay for CH13...			

- Possibility to visualize Celsius or Fahrenheit temperature values.

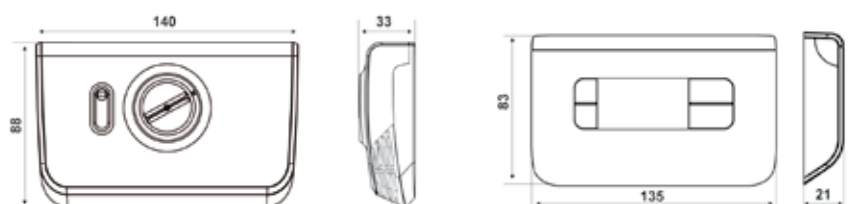

■ C63

■ CH130...

Weekly programmable thermostat



CODE	COMFORT AND ECONOMY TEMPERATURE RANGE	PRESET ANTIFREEZE TEMPERATURE	POWER SUPPLY	SPDT CONTACT RATING
C31	5 ÷ 40 °C	5 °C	3 batteries AA 1,5 V	5(3)A 250Vac

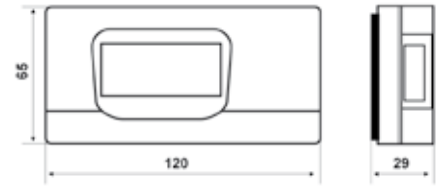

■ Six daily switching points.



Daily programmable thermostat with mechanical clock



CODE	COMFORT TEMPERATURE RANGE	ECONOMY TEMPERATURE RANGE	POWER SUPPLY	SPDT CONTACT RATING
C32	16 ÷ 34 °C	5 ÷ 23 °C	2 batteries AA 1,5 V	5(2)A 250Vac

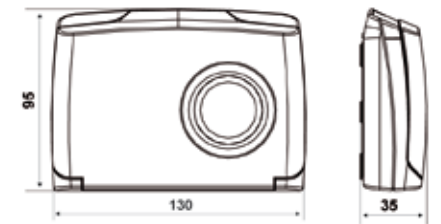

■ Test button to check battery charge status.



Weekly and daily programmable thermostats



CODE	PROGRAMME	COLOR	COMFORT AND ECONOMY TEMPERATURE RANGE	POWER SUPPLY	SPDT CONTACT RATING
C75A	weekly	white	2 ÷ 62 °C	2 batteries AA 1,5 V	5(3)A 250Vac
C76A	daily	white	2 ÷ 62 °C	2 batteries AA 1,5 V	5(3)A 250Vac
C75CT	weekly	white - red base	2 ÷ 62 °C	2 batteries AA 1,5 V	8(5)A 250Vac
C75ACT	weekly	white	2 ÷ 62 °C	2 batteries AA 1,5 V	5(3)A 250Vac
C76CT	daily	white - red base	2 ÷ 62 °C	2 batteries AA 1,5 V	8(5)A 250Vac

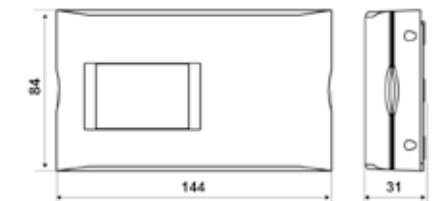

Weekly and daily programmable thermostats, with knobs



CODE	PROGRAMME	COLOR	COMFORT TEMPERATURE RANGE	ECONOMY TEMPERATURE RANGE	POWER SUPPLY	SPDT CONTACT RATING
C67	weekly	white	16 ÷ 34 °C	5 ÷ 23 °C	2 batteries AA 1,5 V	5(3)A 250Vac
C67C	weekly	silver	16 ÷ 34 °C	5 ÷ 23 °C	2 batteries AA 1,5 V	5(3)A 250Vac
C67N	weekly	anthracite	16 ÷ 34 °C	5 ÷ 23 °C	2 batteries AA 1,5 V	5(3)A 250Vac
C68	daily	white	16 ÷ 34 °C	5 ÷ 23 °C	2 batteries AA 1,5 V	5(3)A 250Vac
C68C	daily	silver	16 ÷ 34 °C	5 ÷ 23 °C	2 batteries AA 1,5 V	5(3)A 250Vac
C68N	daily	anthracite	16 ÷ 34 °C	5 ÷ 23 °C	2 batteries AA 1,5 V	5(3)A 250Vac

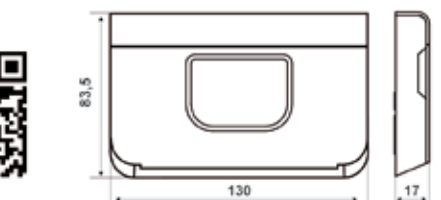

■ Temperature regulation with knobs.



■ Video instructions



Weekly and daily programmable thermostats



CODE	PROGRAMME	COLOR	COMFORT AND ECONOMY TEMPERATURE RANGE	POWER SUPPLY	SPDT CONTACT RATING
C57	weekly	white	2 ÷ 62 °C	2 batteries AA 1,5 V	5(3)A 250Vac
C57C	weekly	silver	2 ÷ 62 °C	2 batteries AA 1,5 V	5(3)A 250Vac
C57N	weekly	anthracite	2 ÷ 62 °C	2 batteries AA 1,5 V	5(3)A 250Vac
C58	daily	white	2 ÷ 62 °C	2 batteries AA 1,5 V	5(3)A 250Vac
C58C	daily	silver	2 ÷ 62 °C	2 batteries AA 1,5 V	5(3)A 250Vac
C58N	daily	anthracite	2 ÷ 62 °C	2 batteries AA 1,5 V	5(3)A 250Vac
C57CT	weekly	white	2 ÷ 62 °C	2 batteries AA 1,5 V	5(3)A 250Vac
C58CT	daily	white	2 ÷ 62 °C	2 batteries AA 1,5 V	5(3)A 250Vac
C57RFR	weekly, radio frequency KIT				
C58RFR	daily, radio frequency KIT				



■ Video instructions

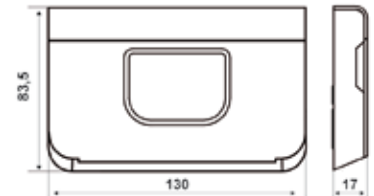

Weekly programmable thermostats



CODE	COLOR	TEMPERATURE RANGE	POWER SUPPLY	CONTACT RATING
CH150	white	2 ÷ 40 °C	2 batteries AA 1,5V	5(3)A 250Vac
CH151	silver	2 ÷ 40 °C	2 batteries AA 1,5V	5(3)A 250Vac
CH152	anthracite	2 ÷ 40 °C	2 batteries AA 1,5V	5(3)A 250Vac
CH150-16	relay 16A	white	2 batteries AA 1,5V	16(4)A 250Vac
CH150RF	radio frequency	white	2 batteries AA 1,5V	5(3)A 250Vac
CH150TS	touchscreen	white	2 batteries AA 1,5V	5(3)A 250Vac
CH150R	remote relay	white	from remote relay	5(3)A 250Vac
CH170D	radio frequency actuator for CH150RF, 230V-50HZ, 5(3)A 250Vac			
CH171D	remote relay for CH150R, 230V-50HZ, 5(3)A 250Vac			
EC18	external probe			
EC19	floor probe			
EC20	ambient probe			

- Wide display.
- Graphic icones
- Humidity displayed range 20 ÷ 90 %RH.

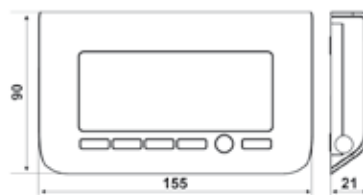

■ CH15...



■ CH150TS

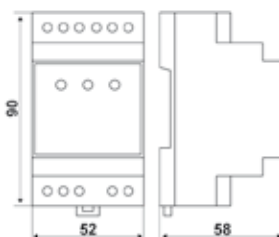

■ CH170D - CH171D

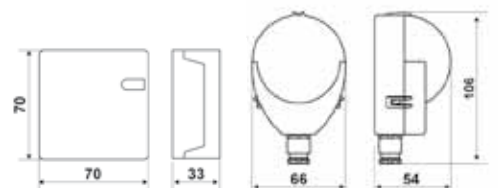

■ EC20

■ EC18

Weekly programmable thermostats with 3 points or bistage control



CODE	TEMPERATURE RANGE	DIFFERENTIAL	POWER SUPPLY	TEMPERATURE DISPLAYED RANGE	HUMIDITY DISPLAYED RANGE
CH150REV	2 ÷ 40 °C	0,25 K	from actuator	-30 ÷ 60 °C	20 ÷ 90 %RH
CH174	actuator, 6 modules DIN rail mounting - 230Vac - contact rating 5(3)A 250Vac				
CH150RBS	2 ÷ 40 °C	0,25 K	2 batteries AA 1,5V	-30 ÷ 60 °C	20 ÷ 90 %RH
CH171DBS	actuator, 3 modules DIN rail mounting - 230Vac - contact rating 5(3)A 250Vac				

- Wide display.
- Graphic icons

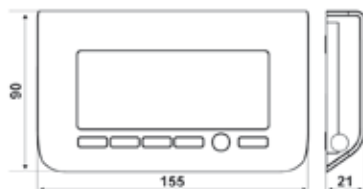

■ CH15...

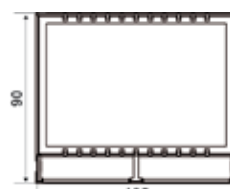

■ CH174...



■ CH171DBS

Programmable thermostats MiA



CODE	COLOR	TEMPERATURE RANGE	POWER SUPPLY FROM THE BUS	SPDT CONTACT RATING
CH150MB	white	2 ÷ 40 °C	24Vdc 50mA	5(3)A 250Vac
CH151MB	silver	2 ÷ 40 °C	24Vdc 50mA	5(3)A 250Vac
CH152MB	anthracite	2 ÷ 40 °C	24Vdc 50mA	5(3)A 250Vac
CH150TSMB	white	2 ÷ 40 °C	24Vdc 50mA	5(3)A 250Vac
CH141MB	white-silver-anthracite	2 ÷ 40 °C	24Vdc 50mA	5(3)A 250Vac

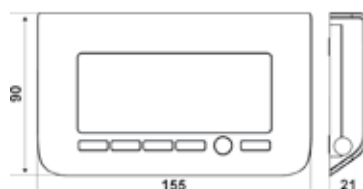

■ CH15...



■ CH150TSMB

- Wide display.
- Graphic icons

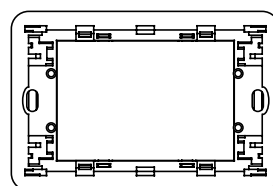

■ CH141MB
2 FRAMES
to provide compatibility with the most common plates

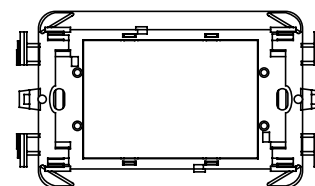

COMPATIBLE PLATES

Bticino Living International and transizione flat
 Bticino Living-light round LNA and square LNB
 Bticino Light, Light tech
 Bticino Axolute
 Bticino Matix
 Vimar Idea and Rondò
 Vimar Plana and Eikon
 Gewiss Chorus One, Lux, Art
 Ave Sistema 45, Banquise, Noir, Blanc, Yes
 Ave Sistema 44 Zama, Personal
 Legrand cross, Vela square, Vela round

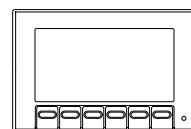

3 COVERS
white
silver
anthracite

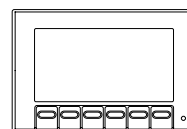

3 SPECIAL COVERS for
Bticino Axolute and Ave
Sistema 44
white
silver
anthracite



3 COLOURED PAIRS
OF ADAPTERS
white
silver
anthracite

Flush mounting weekly and daily programmable thermostats



CODE	PROGRAMME	COLOUR	POWER SUPPLY	COMFORT AND ECONOMY TEMPERATURE RANGE	SPDT CONTACT RATING
C51AT	weekly	anthracite	2 batteries AAA 1,5V	2 ÷ 62 °C	5(3)A 250Vac
C51ABT	weekly	white	2 batteries AAA 1,5V	2 ÷ 62 °C	5(3)A 250Vac
C51ACT	weekly	silver	2 batteries AAA 1,5V	2 ÷ 62 °C	5(3)A 250Vac
C52AT	daily	anthracite	2 batteries AAA 1,5V	2 ÷ 62 °C	5(3)A 250Vac
C52ABT	daily	white	2 batteries AAA 1,5V	2 ÷ 62 °C	5(3)A 250Vac
C51A	weekly	anthracite	2 batteries AA 1,5V	2 ÷ 62 °C	5(3)A 250Vac
C51AB	weekly	white	2 batteries AA 1,5V	2 ÷ 62 °C	5(3)A 250Vac
C53A	weekly	anthracite	230V-50HZ	2 ÷ 62 °C	5(3)A 250Vac
C53AB	weekly	white	230V-50HZ	2 ÷ 62 °C	5(3)A 250Vac
C52A	daily	anthracite	2 batteries AA 1,5V	2 ÷ 62 °C	5(3)A 250Vac
C52AB	daily	white	2 batteries AA 1,5V	2 ÷ 62 °C	5(3)A 250Vac
C54A	daily	anthracite	230V-50HZ	2 ÷ 62 °C	5(3)A 250Vac
C54AB	daily	white	230V-50HZ	2 ÷ 62 °C	5(3)A 250Vac
CTI5X	Interface for telecontrol CT3A or CT3AM				

- For C5..T it is not possible to connect to GSM phone activators CT3A and CT3AM.
- Flush mounting in 3-module 503 embedded boxes.

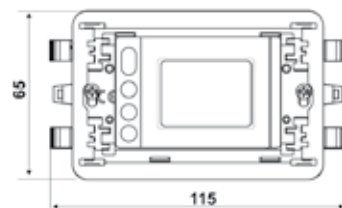
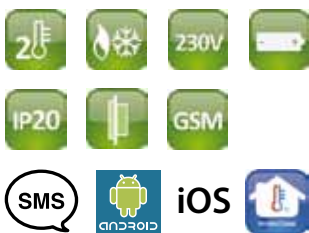

COMPATIBLE PLATES

BTICINO Living International, Living transizione, Living-light round LNA and square LNB
 BTICINO Axolute (only C5...T)
 BTICINO Light, Light Tech
 VIMAR Idea and Rondò, VIMAR Plana, Eikon
 GEWISS Playbus and Playbus Young
 AVE sistema 45, Noir, Blanc, AVE Banquise, Ave Yes
 SIEMENS Delta Futura Graphit
 LEGRAND Cross

Flush mounting weekly programmable thermostats



CODE	TEMPERATURE RANGE	POWER SUPPLY	SPDT CONTACT RATING
CH141	2 ÷ 40 °C	2 batteries AAA 1,5 V	5(3)A 250Vac
CH143	2 ÷ 40 °C	230V 50Hz	5(3)A 250Vac

- LED, back lighting (blue) display.
- Compatibility KIT for the most common plates.
- Flush mounting in 3-module 503 embedded boxes.

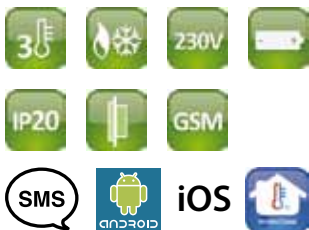

COMPATIBLE PLATES

Bticino Living International and transizione flat
 Bticino Living-light round LNA and square LNB
 Bticino Light, Light tech
 Bticino Axolute
 Bticino Matix
 Vimar Idea and Rondò
 Vimar Plana and Eikon
 Gewiss Chorus One, Lux, Art
 Ave Sistema 45, Banquise, Noir, Blanc, Yes
 Ave Sistema 44 Zama, Personal
 Legrand cross, Vela square, Vela round

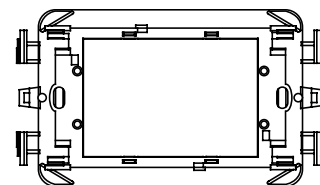
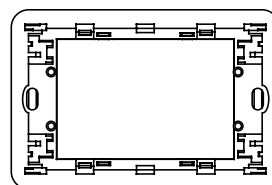

2 FRAMES
to provide compatibility with the most common plates

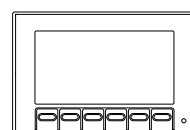

3 COVERS
white
silver
anthracite

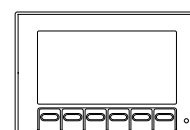

3 SPECIAL COVERS for
Bticino Axolute and Ave
Sistema 44
white
silver
anthracite

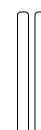

3 COLOURED PAIRS
OF ADAPTERS
white
silver
anthracite

Weekly programmable thermostat with integrated GSM



CODE	TEMPERATURE RANGE	POWER SUPPLY	SPDT CONTACT RATING
CH140GSM	2 ÷ 40 °C	230V 50Hz	5(3)A 250Vac

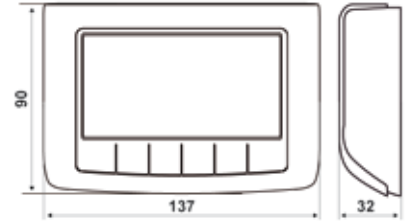

- Integrated GSM modem
- LED, back lighting (blue) display.
- SIM card not included.
- 2 auxiliary inputs for alarms (dry contacts).
- 2 outputs:
 - thermoregulation, control via sms;
 - summer thermoregulation winter thermoregulation;
 - thermoregulation, management logic inputs.

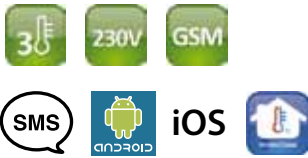

Electronic room hygrostat



CODE	RELATIVE HUMIDITY RANGE	DIFFERENTIAL	POWER SUPPLY	SPDT CONTACT RATING
D40	30 ÷ 90 RH%	5 RH%	230Vac 50Hz	6(3)A 250Vac

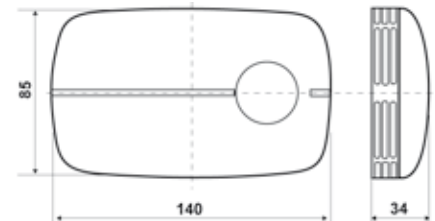

WATER METERING SYSTEMS

Calculation master units for heat metering systems and temperature probes



CODE	POWER SUPPLY	TEMPERATURE RANGE	DETECTION	PRECISION RESISTOR	M-BUS OUTPUT	PORTE OPZIONALI
ECCM	battery	0 ÷ 190 °C	calories	Pt500	1	2 outputs
ECCM2I	battery	0 ÷ 190 °C	calories	Pt500	1	2 inputs
ECCM2IS1	battery	0 ÷ 190 °C	calories / refrigeration	Pt500	1	2 inputs

CODE	DESCRIPTION	PN	TEMPERATURE RANGE
EC85P	pair of sensors PT500, 85 mm + probe holder	PN25	0 ÷ 180 °C
EC45	pair of sensors PT500, 45 mm	PN16	0 ÷ 140 °C
EC45P	probe holder for EC45		
EC45KPS	kit made of EC45 + EC45P	PN16	0 ÷ 140 °C
EC45PD	probe holder M10 for EC45		
EC45PS	probe holder M8 fo EC45KPS		

- Detection 5 ÷ 60 sec.
- Compliance with MID.

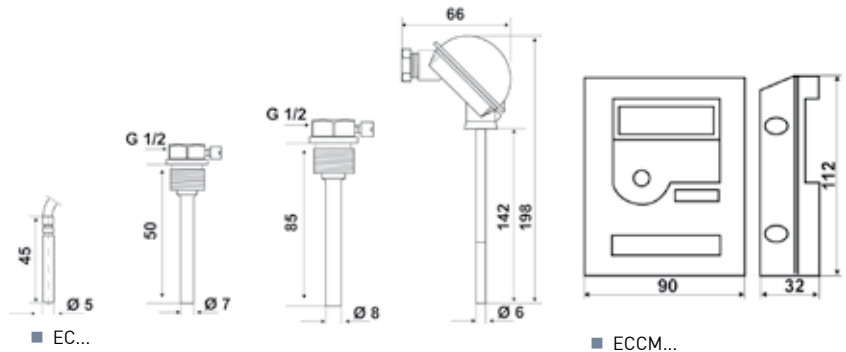

Compact multiple jet heat meters



CODE	NOMINAL SIZE INCH - DN	NOMINAL FLOW RATE QN	DETECTION	INPUTS	OUTPUTS	TEMPERATURE RANGE
ECC15AC	1/2" - 15 mm	0,6 m ³ /h	calories	-	2 pulses	5 ÷ 90 °C
ECC15C	1/2" - 15 mm	1,5 m ³ /h	calories	-	2 pulses	5 ÷ 90 °C
ECC20C	3/4" - 20 mm	2,5 m ³ /h	calories	-	2 pulses	5 ÷ 90 °C
ECC15C2I	1/2" - 15mm	1,5 m ³ /h	calories	2 pulses	M-Bus	5 ÷ 90 °C
ECC20C2I	3/4" - 20mm	2,5 m ³ /h	calories	2 pulses	M-Bus	5 ÷ 90 °C
ECC15HC2I	1/2" - 15mm	1,5 m ³ /h	calories / cooling calories	2 pulses	M-Bus	5 ÷ 90 °C
ECC20HC2I	3/4" - 20mm	2,5 m ³ /h	calories / cooling calories	2 pulses	M-Bus	5 ÷ 90 °C

- 10 litres/pulse.
- Temperature range master unit: 1 ÷ 130 °C.
- Heat meter separable with 30 cm of cable connection.
- Compliance with MID.



	A	A1	B	C	D
ECC15AC	110	190	75x110	76	95
ECC15C	110	190	75x110	76	95
ECC20C	130	228	75x110	76	97,5

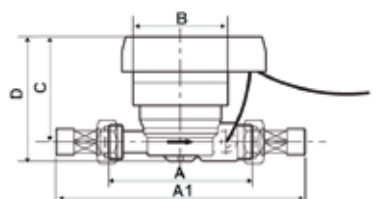

Single-jet volumetric meters up to 120 °C, and multiple-jet up to 130 °C



- 10 litres/pulse.
- IP68.
- Compliance with MID.



CODE	NOMINAL SIZE Inch - DN	NOMINAL FLOW RATE Q _n	MAXIMUM FLOW RATE Q _{max}	MINIMUM FLOW RATE Q _{min}	MAXIMUM TEMPERATURE
ECC15AGS	1/2" - 15 mm	0,6 m³/h	1,2 m³/h	12 l/h	120 °C
ECC15GS	1/2" - 15 mm	1,5 m³/h	3 m³/h	30 l/h	120 °C
ECC20GS	3/4" - 20 mm	2,5 m³/h	5 m³/h	50 l/h	120 °C
ECC15GSF	1/2" - 15 mm	1,5 m³/h	3 m³/h	30 l/h	120 °C
ECC20GSF	3/4" - 20 mm	2,5 m³/h	5 m³/h	50 l/h	120 °C
ECC15GM	1/2" - 15 mm	1,5 m³/h	3 m³/h	30 l/h	130 °C
ECC20GM	3/4" - 20 mm	1,5 m³/h	3 m³/h	30 l/h	130 °C
ECC20AGM	3/4" - 20 mm	2,5 m³/h	5 m³/h	50 l/h	130 °C
ECC25GM	1" - 25 mm	3,5 m³/h	7 m³/h	70 l/h	130 °C
ECC32GM	1 1/4" - 32 mm	6 m³/h	12 m³/h	120 l/h	130 °C
ECC40GM	1 1/2" - 40 mm	10 m³/h	20 m³/h	200 l/h	130 °C
ECC50GM	2" - 50 mm	15 m³/h	30 m³/h	300 l/h	130 °C

	A	B	C	D
ECC15AGS	110	72	108	18
ECC15GS	110	72	108	18
ECC20GS	130	72	108	18

	A	B	C
ECC15GM	165	143	100
ECC20GM	220	149	109
ECC25GM	260	159	116
ECC32GM	260	159	116
ECC40GM	300	185	139
ECC50GM	300	199	142

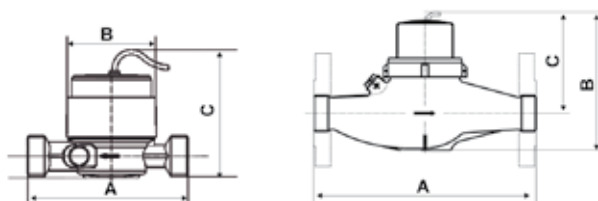

■ ECC ..GS

■ ECC ..GM

Single-jet and multiple-jet volumetric meters for hot and cold water



- 10 litres/pulse.
- Compliance with MID.



CODE	MAXIMUM TEMPERATURE	NOMINAL SIZE Inch - DN	NOMINAL FLOW RATE Q _n	MAXIMUM FLOW RATE Q _{max}	MINIMUM FLOW RATE Q _{min}
ECCF15GS	30°C	1/2" - 15 mm	1,6 m³/h	64 l/h	2,0 m³/h
ECCF20GS	30°C	3/4" - 20 mm	2,5 m³/h	100 l/h	3,125 m³/h
ECCS15GS	90°C	1/2" - 15 mm	1,6 m³/h	64 l/h	2,0 m³/h
ECCS20GS	90°C	3/4" - 20 mm	2,5 m³/h	100 l/h	3,125 m³/h
ECCS15GM	90°C	1/2" - 15 mm	1,5 m³/h	30 l/h	3 m³/h
ECCS20AGM	90°C	3/4" - 20 mm	1,5 m³/h	30 l/h	3 m³/h
ECCS20GM	90°C	3/4" - 20 mm	2,5 m³/h	50 l/h	5 m³/h
ECCS25GM	90°C	1" - 25 mm	3,5 m³/h	70 l/h	7 m³/h
ECCS32GM	90°C	1 1/4" - 32 mm	6 m³/h	120 l/h	12 m³/h
ECCS40GM	90°C	1 1/2" - 40 mm	10 m³/h	200 l/h	20 m³/h
ECCS50GM	90°C	2" - 50 mm	15 m³/h	300 l/h	30 m³/h
ECCF15GM	50°C	3/4" - 15 mm	1,5 m³/h	0,03 m³/h	3 m³/h
ECCF20GM	50°C	3/4" - 20 mm	2,5 m³/h	0,025 m³/h	5 m³/h
ECCF20AGM	50°C	3/4" - 20 mm	1,5 m³/h	0,03 m³/h	3 m³/h
ECCF25GM	50°C	1" - 25 mm	3,5 m³/h	0,035 m³/h	7 m³/h
ECCF32GM	50°C	1 1/4" - 32 mm	6 m³/h	0,06 m³/h	12 m³/h
ECCF40GM	50°C	1 1/2" - 40 mm	10 m³/h	0,1 m³/h	20 m³/h
ECCF50GM	50°C	2" - 50 mm	15 m³/h	0,15 m³/h	30 m³/h

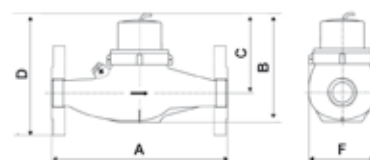
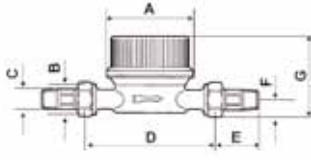
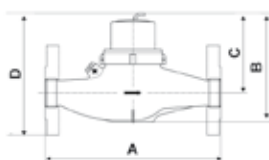

	A	B	C	D
ECCS15GM	165	143	100	-
ECCS20AGM	220	149	109	-
ECCS20GM	220	149	109	156
ECCS25GM	260	159	116	168
ECCS32GM	260	159	116	178
ECCS40GM	300	185	139	208
ECCS50GM	300	199	142	220

	A	B	C	D
ECCF15GM	220	116	76	87
ECCF20GM	220	116	76	88
ECCF25GM	220	135	89	103
ECCF32GM	260	135	89	103
ECCF40GM	300	149	103	135
ECCF50GM	300	163	106	150

	A	B	C	D	E	F	G
ECCF15GS	70	G 3/4B	R 1/2	110	40	17	69
ECCF20GS	70	G 1B	R 3/4	130	50	21	72
ECCS15GS	70	G 3/4B	R 1/2	110	40	17	69
ECCS20GS	70	G 1B	R 3/4	130	50	21	72

Woltmann volumetric meters for hot and cold water



■ 100 litres/pulse.



CODE	MAXIMUM TEMPERATURE	NOMINAL FLOW RATE DIN	NOMINAL FLOW RATE Q _n	MAXIMUM FLOW RATE Q _{max}	MINIMUM FLOW RATE Q _{min}
ECC50W	130°C	50 mm	15 m ³ /h	30 m ³ /h	0,6 m ³ /h
ECC65W	130°C	60 mm	25 m ³ /h	60 m ³ /h	1 m ³ /h
ECC80W	130°C	80 mm	40 m ³ /h	90 m ³ /h	1,4 m ³ /h
ECC100W	130°C	100 mm	70 m ³ /h	140 m ³ /h	2 m ³ /h
ECC125W	130°C	125 mm	100 m ³ /h	200 m ³ /h	3,5 m ³ /h
ECC150W	130°C	150 mm	150 m ³ /h	300 m ³ /h	4,5 m ³ /h
ECC200W	130°C	200 mm	250 m ³ /h	500 m ³ /h	80 m ³ /h
ECC250W	130°C	250 mm	500 m ³ /h	1000 m ³ /h	20 m ³ /h
ECC300W	130°C	300 mm	600 m ³ /h	1200 m ³ /h	25 m ³ /h
ECCF50W	30°C	50 mm	15 m ³ /h	30 m ³ /h	0,45 m ³ /h
ECCF65W	30°C	60 mm	25 m ³ /h	50 m ³ /h	0,75 m ³ /h
ECCF80W	30°C	80 mm	40 m ³ /h	80 m ³ /h	1,2 m ³ /h
ECCF100W	30°C	100 mm	70 m ³ /h	120 m ³ /h	1,8 m ³ /h
ECCF125W	30°C	125 mm	100 m ³ /h	200 m ³ /h	3 m ³ /h
ECCF150W	30°C	150 mm	150 m ³ /h	300 m ³ /h	4,5 m ³ /h
ECCF200W	30°C	200 mm	250 m ³ /h	500 m ³ /h	7,5 m ³ /h
ECCF250W	30°C	250 mm	500 m ³ /h	1000 m ³ /h	12 m ³ /h
ECCF300W	30°C	300 mm	600 m ³ /h	1200 m ³ /h	18 m ³ /h

		A	B	C
ECC50W	ECCF50W	120	73	200
ECC65W	ECCF65W	120	85	200
ECC80W	ECCF80W	150	95	225
ECC100W	ECCF100W	150	105	250
ECC125W	ECCF125W	160	118	250
ECC150W	ECCF150W	167	135	300
ECC200W	ECCF200W	206	162	350
ECC250W	ECCF250W	231	194	450
ECC300W	ECCF300W	256	226	500

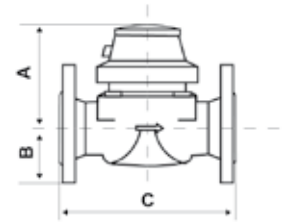

Unit, radio modem and M-BUS concentrators for heat metering systems



CODE	DESCRIPTION
ECC20CON	M-BUS concentrator, up to 20 slaves, DIN rail mounting
ECC60CON	M-BUS concentrator, up to 60 slaves, wall mounting
ECCR	Radio unit
ECCRR25	Radio repeater 25mW
ECCRR500	Radio repeater 500mW
ECCMR	Radio modem

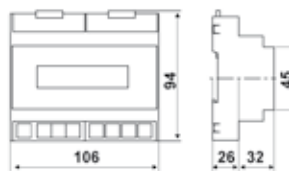

■ ECC20CON

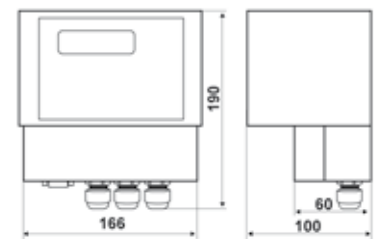

■ ECC60CON

Heat metering modules



- ECMR heating hydraulic modules.
- ECMS hydraulic modules for hot/cold sanitary water.
- EMC complete modules.
- Customized version on request.

CODE		NOMINAL FLOW RATE Q _n	BRACKETS	CONNECTION	INPUTS
ECMC001	-			male	left
ECMC010	-			male	right
ECMC002	2-way zone valve			male	left
ECMC003	2-way zone valve			male	right
ECMC006	3-way by-pass zone valve			male	left
ECMC007	3-way by-pass zone valve			male	right
ECMS001	-	1,5 m ³ /h	lateral	male	left
ECMS002	-	1,5 m ³ /h	lateral	male	right
ECMS005	-	1,5 m ³ /h	lateral	female	left
ECMS006	-	1,5 m ³ /h	lateral	female	right
ECMS007	-	2,5 m ³ /h	lateral	male	left
ECMS008	-	2,5 m ³ /h	lateral	male	right
ECMS009	-	2,5 m ³ /h	lateral	female	left
ECMS010	-	2,5 m ³ /h	lateral	female	right
ECMS011	-	1,5 m ³ /h	-	female	left
ECMS012	-	1,5 m ³ /h	-	female	left
ECMR001	-	2,5 m ³ /h	lateral	male	left
ECMR002	-	2,5 m ³ /h	lateral	male	right
ECMR003	2-way zone valve	2,5 m ³ /h	lateral	male	left
ECMR004	2-way zone valve	2,5 m ³ /h	lateral	male	right
ECMR007	-	2,5 m ³ /h	-	female	left
ECMR008	2-way zone valve	2,5 m ³ /h	-	female	left
ECMR065	-	2,5 m ³ /h	lateral	female	left
ECMR066	-	2,5 m ³ /h	lateral	female	right
ECMR067	2-way zone valve	2,5 m ³ /h	lateral	female	left
ECMR068	2-way zone valve	2,5 m ³ /h	lateral	female	right
ECMR073	-	2,5 m ³ /h	lateral	male	left
ECMR074	-	2,5 m ³ /h	lateral	male	right
ECMR075	-	2,5 m ³ /h	lateral	female	left
ECMR076	-	2,5 m ³ /h	lateral	female	right
ECMR077	2-way zone valve	2,5 m ³ /h	lateral	male	left
ECMR078	2-way zone valve	2,5 m ³ /h	lateral	male	right
ECMR079	2-way zone valve	2,5 m ³ /h	lateral	female	left
ECMR080	2-way zone valve	2,5 m ³ /h	lateral	female	right
ECMR085	-	2,5 m ³ /h	lateral	male	left
ECMR086	-	2,5 m ³ /h	lateral	male	right
ECMR087	2-way zone valve	2,5 m ³ /h	lateral	male	left
ECMR088	2-way zone valve	2,5 m ³ /h	lateral	male	right
ECMR089	-	2,5 m ³ /h	lateral	female	left
ECMR090	-	2,5 m ³ /h	lateral	female	right
ECMR091	2-way zone valve	2,5 m ³ /h	lateral	female	left
ECMR092	2-way zone valve	2,5 m ³ /h	lateral	female	right
ECMR093	-	2,5 m ³ /h	lateral	male	left
ECMR094	-	2,5 m ³ /h	lateral	male	right
ECMR095	-	2,5 m ³ /h	lateral	female	left
ECMR096	-	2,5 m ³ /h	lateral	female	right
ECMR097	2-way zone valve	2,5 m ³ /h	lateral	male	left
ECMR098	2-way zone valve	2,5 m ³ /h	lateral	male	right
ECMR099	2-way zone valve	2,5 m ³ /h	lateral	female	left
ECMR100	3-way by-pass zone valve	2,5 m ³ /h	lateral	female	right
ECMR005	3-way by-pass zone valve	2,5 m ³ /h	lateral	male	left
ECMR006	3-way by-pass zone valve	2,5 m ³ /h	lateral	male	right
ECMR011	3-way by-pass zone valve	2,5 m ³ /h	-	female	left
ECMR013	3-way by-pass zone valve	2,5 m ³ /h	-	female	left
ECMR014	3-way by-pass zone valve	2,5 m ³ /h	-	female	right
ECMR063	3-way by-pass zone valve	2,5 m ³ /h	lateral	male	left
ECMR064	3-way by-pass zone valve	2,5 m ³ /h	lateral	male	right
ECMR069	3-way by-pass zone valve	2,5 m ³ /h	lateral	female	left
ECMR070	3-way by-pass zone valve	2,5 m ³ /h	lateral	female	right
ECMR071	3-way by-pass zone valve	2,5 m ³ /h	lateral	female	left
ECMR072	3-way by-pass zone valve	2,5 m ³ /h	lateral	female	right

CODE		NOMINAL FLOW RATE Q _n	BRACKETS	CONNECTION	INPUTS
ECMR081	3-way by-pass zone valve	2,5 m ³ /h	lateral	male	left
ECMR082	3-way by-pass zone valve	Q _n 2,5	lateral	male	right
ECMR083	3-way by-pass zone valve	Q _n 2,5	lateral	female	left
ECMR084	3-way by-pass zone valve	Q _n 2,5	lateral	female	right
ECMR101	3-way by-pass zone valve	Q _n 2,5	lateral	male	left
ECMR102	3-way by-pass zone valve	Q _n 2,5	lateral	male	right
ECMR103	3-way by-pass zone valve	Q _n 2,5	lateral	female	left
ECMR104	3-way by-pass zone valve	Q _n 2,5	lateral	female	right

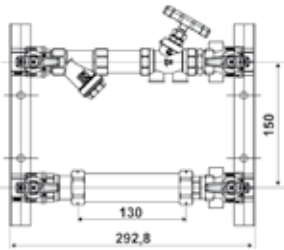

■ ECMR001

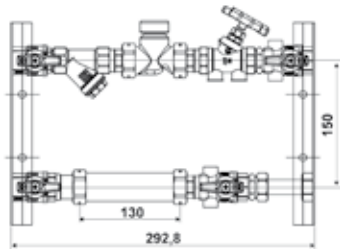

■ ECMR003

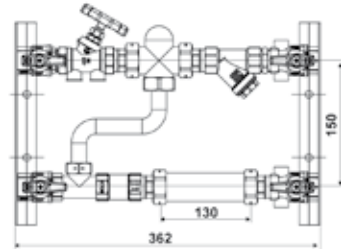

■ ECMR005

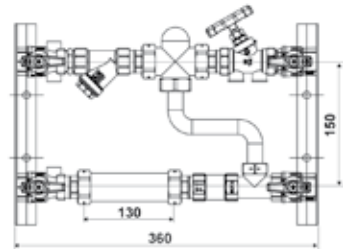

■ ECMR006

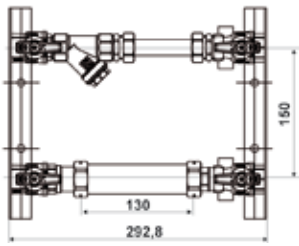

■ ECMR073

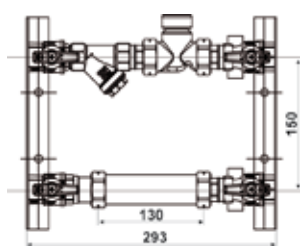

■ ECMR077

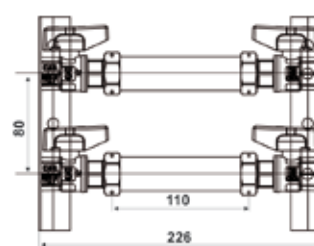

■ ECMS001

Electrothermal actuators



CODE	POWER SUPPLY 50/60HZ	RUNNING TIME	MAX STROKE	INTEGRATED AUXILIARY CONTACT	WITHOUT TENSION VALVE
O40NANCM	230V	3 min	4,5 mm	no	closed (open)
O41NCMAUX	230V	4 min	4,5 mm	yes	closed

- Operating power consumption 2,5W.
- Starting power consumption 36W.
- Axial torque 125N.
- M30x1,5 coupling.

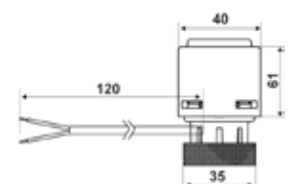

Zone control valves with male thread connection



CODE	NOMINAL SIZE DN	TYPE	KVS	CONNECTION	STROKE
Z42M	15	2-way	3,5	G3/4B	4 mm
Z42A	20	2-way	4,5	G1B	4 mm
Z43M	15	3-way	4,0	G3/4B	3,7 mm
Z43A	20	3-way	5,0	G1B	3,7 mm
1592022	threaded connection with flat gasket 1/2" M 3/4"F				
1592023	threaded connection with flat gasket 3/4" M 1"F				

- Nominal pressure PN 16.
- 2-way valve in bronze.
- 3-way valve in nickel-plated brass.

DN	D	L1	L2	C
Z42M	15	G 3/4	36,5	65
Z42A	20	G 1	30	65

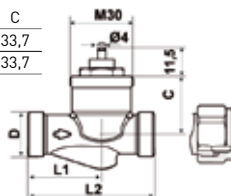

■ Z42...

DN	A	C	G	L
Z43M	15	30	27	G 3/4
Z43A	20	30	27	G 1

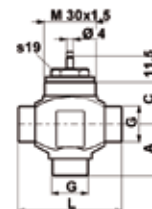

■ Z43...

Galvanized sheet box, flush-mounting



CODE	DIMENSIONS
	mm
CAS05	500 x 500 x 110
CAS10	662 x 500 x 110

- Telescopic frame galvanized steel body
- Front cover made of epoxy coated galvanized steel.
- White colour with lock.

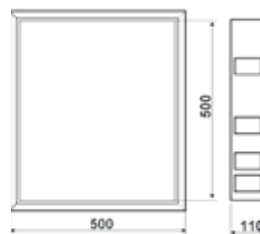

■ CAS05

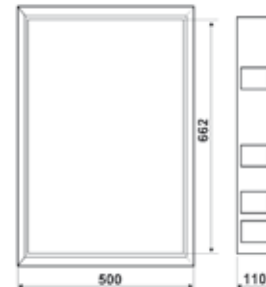

■ CAS10

Software for water metering systems

CODE	DESCRIPTION
ECCRSW	Radio unit configuration software
ECCSW	Software for management of heat metering systems

CLIMATIC THERMOREGULATION SYSTEMS

Control unit for thermal solar panel systems and solar cooling



CODE	POWER SUPPLY	CONTACT RATING	OPERATING TEMPERATURE	CONSUMPTION VA	PROTECTION DEGREE
EV40	230V 50Hz	5(3)A - 250Vac	0 ÷ 50 °C	5	IP40 (back panel)
EC21	Probe for high temperatures.				

- DIN-rail mounting (6 modules).
- 8 types of preconfigured systems.
- 3 probe inputs.
- 2 optoisolated inputs.
- 3 output relays.

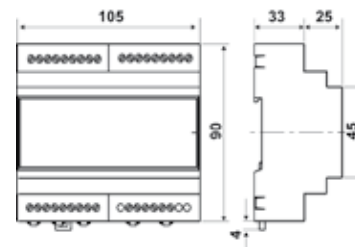

Control unit for floor heating and cooling systems



CODE	POWER SUPPLY	CONTACT RATING	OPERATING TEMPERATURE	CONSUMPTION VA	PROTECTION DEGREE
EV84	230V 50Hz	5(3)A - 250Vac	0 ÷ 50 °C	4	IP40 (back panel)
EV84A	230V 50Hz	5(3)A - 250Vac	0 ÷ 50 °C	4	IP40 (back panel)
EC10	Ambient probe				
EC14	External probe				
EC15	Contact flow probe				
EC16A	Immersion flow probe				
EC17	Well probe				

- DIN-rail mounting (6 modules).
- Humidity regulation.
- 3 output relays.
- 3 analog inputs to control the external, limit and flow temperature.
- 1 correction probe ± 3 °C.
- 1 humidistat input for EV84A.
- 1 digital input summer/winter.

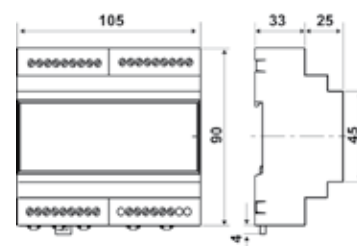

Analog control unit for climate temperature regulation



CODE	PROGRAMME	CONTACT RATING	OPERATING TEMPERATURE	CONSUMPTION VA	PROTECTION DEGREE
EV02F	daily	5(3)A - 250Vac	0 ÷ 50 °C	4	IP40 (back panel)
EV05M	weekly	5(3)A - 250Vac	0 ÷ 50 °C	4	IP40 (back panel)
EC11	External probe				
EC12	Contact flow probe				
EC13A	Immersion flow probe				

- Flush, wall or rear panel mounting
- Mechanical clock.
- Potentiometers to select the heating curve and for regulation of the comfort and energy saving temperatures.

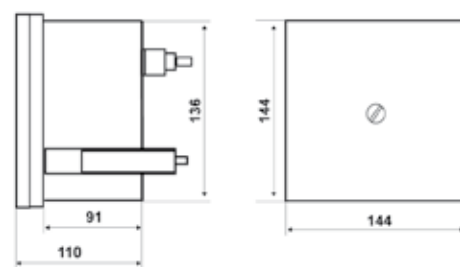

Digital controller for climatic systems with remote control



CODE	MOUNTING	CONTACT RATING	OPERATING TEMPERATURE	CONSUMPTION VA	PROTECTION DEGREE
EV80	box 144mm	5(3)A - 250Vac	0 ÷ 50 °C	7	IP40 (back panel)
EV85	DIN-rail mounting, 9 mod.	5(3)A - 250Vac	0 ÷ 50 °C	7	IP40 (back panel)
TCEV80	RS232 cable, controller modem				

- Mixing valve control.
- Circulation pump control.
- Aux control.
- 2 generic alarm inputs.
- Probe inputs: external, flow, limit and ambient.

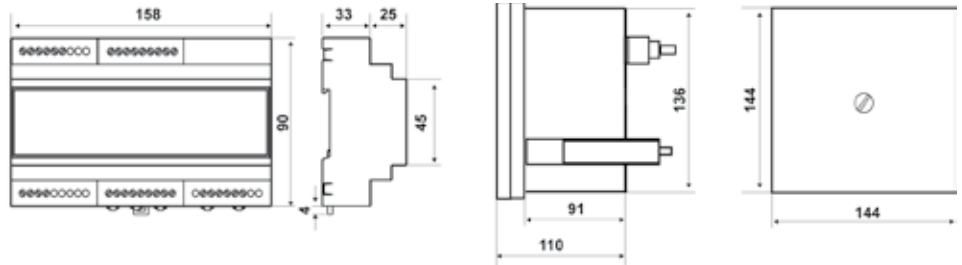

■ EV85

■ EV80

Regulation control unit for climatic systems



CODE	MOUNTING	CONTACT RATING	OPERATING TEMPERATURE	CONSUMPTION VA	PROTECTION DEGREE
EV83	DIN-rail mounting, 6 mod.	5(3)A - 250Vac	0 ÷ 50 °C	3	IP40 (back panel)
EV60	DIN-rail mounting, 6 mod.	5(3)A - 250Vac	0 ÷ 50 °C	5	IP40 (back panel)

- EV83
- Circulation pump control.
 - Mixing valve or burner control.
 - Probe inputs: external, flow and ambient..

- EV60
- Circulation pump control.
 - Mixing valve control.
 - Temperature probe input.

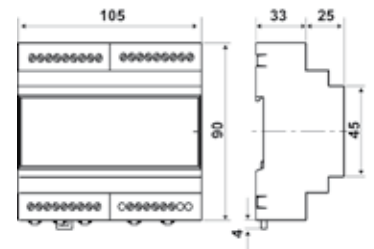

EV

Multifunction expandable digital controller for climatic systems



CODE	MOUNTING	CONTACT RATING	OPERATING TEMPERATURE	CONSUMPTION VA	PROTECTION DEGREE
EV87	DIN-rail mounting, 6 mod.	5(3)A - 250Vac	0 ÷ 45 °C	5	IP40 (back panel)
EV90	box 144mm	5(3)A - 250Vac	0 ÷ 50 °C	5	IP40 (back panel)

- 4 output relays:
 - mixing valve and pump;
 - multistage burner (from 2 to 4);
 - cascade boilers (2 to 4)
 - 2 cascade boilers
- 2 digital inputs can be used as alarms.
- 1 input 4..20mA (only EV87).
- 1 output 0..10V (only EV87).

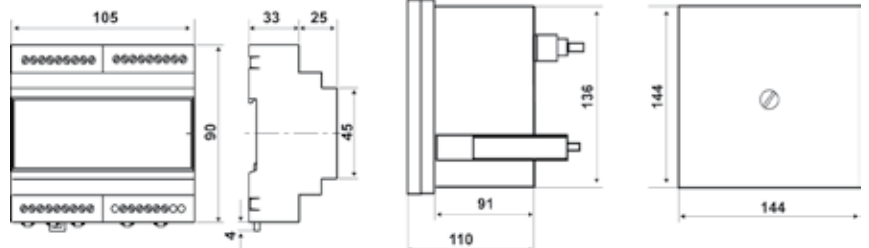

■ EV87

■ EV90

Expansion modules for digital controllers EV87 and EV90



CODE		CONTACT RATING	CONSUMPTION VA
EV91A	temperature control module with external probe	5(3)A - 250Vac	7
EV91B	fixed point temperature control module for sanitary hot water	5(3)A - 250Vac	5
EV91C	control module for 2 or more boilers in cascade	5(3)A - 250Vac	5
EV91D	generic output module	5(3)A - 250Vac	3
EV92	digital input module	5(3)A - 250Vac	3

- DIN-rail mounting, 6 modules.
- Operating temperature 0 ÷ 50 °C

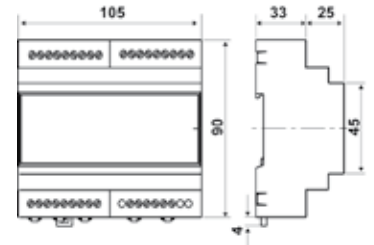

Temperature probes for electronic control units



CODE	TYPE	SUITABLE FOR	PROTECTION DEGREE
EC10	ambient probe	EV80 - EV83 - EV84 - EV85 - EV87	IP55
EC11	external probe	EV02F - EV05M	IP55
EC12	contact flow probe	EV02F - EV05M	IP55
EC13A	immersion flow probe	EV02F - EV05M	IP55
EC14	external probe	EV60 - EV83 - EV70A - EV70D - EV80 - EV84 EV85 - EV87 - EV90 - EV91	IP55
EC15	contact flow probe	EV60 - EV83 - EV70A - EV70D - EV80 - EV80E - EV84 EV85 - EV85E - EV87 - EV90 - EV91	IP55
EC16A	immersion flow probe	EV60 - EV83 - EV70A - EV70D - EV80 - EV80E - EV84 EV85 - EV85E - EV87 - EV90 - EV91	-
EC17	well probe	EV60 - EV84	-
EC21	probe for high temperatures	EV40	-

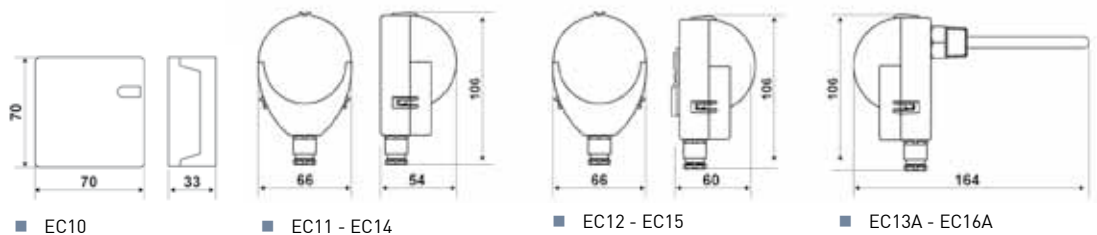

Modem and accessories for remote control



CODE	TYPE	SUITABLE FOR
EM70S	GSM modem with power supply and antenna	EV40 - EV70A - EV70D - EV80 EV87 - EV85 - EV90
1590029	rechargeable battery 12v-1,2ah	EV40 - EV70A - EV80 - EV85 EV87 - EV90 - CT3M - CT3MA
N70A	power supply and battery charger	EV40 - EV70D - EV80 - EV85 EV87 - EV90 - CT3M - CT3MA

Electric servocontrols



CODE	SUITABLE FOR	ROTATION TIME	RATED TORQUE NM	PROTECTION DEGREE
O33A	zone valves	90 seconds for 90°	4	IP40
O34A	mixing valves	280 seconds for 90°	10	IP40
O24A	mixing valves	10 minutes for 90°	15	IP40
O24B	mixing valves	5 minutes for 90°	18	IP40

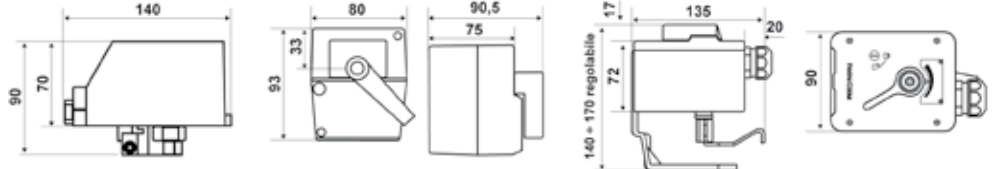

■ O33A ■ O34A - O35A ■ O24A - O24B

Electric servocontrols with ON-OFF or 3 contact control



CODE	ROTATION TIME	ON/OFF CONTROL	MODULATING CONTROL	MICRO AUX	POWER SUPPLY	POWER CONSUMPTION
O33BM	45 seconds for 90°	yes	no	yes	230V 50Hz	3.8 VA
O33BF	45 seconds for 90°	yes	no	yes	24V 50Hz	5.2 VA
O33CM	45 seconds for 90°	yes	yes	yes	230V 50Hz	3.8 VA
O33CF	45 seconds for 90°	yes	yes	yes	24V 50Hz	5.2 VA

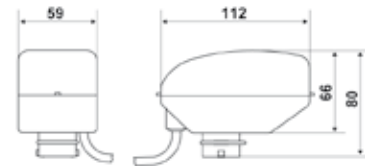

Motorized ball valves



CODE	WAY	DN	BORE	MALE CONNECTION	VALVE OPEN Kv m³/h	ADDITIONAL SHANK
Z52M	2-way	DN15	1/2"	1/2"	13	yes
Z52L	2-way	DN20	1/2"	3/4"	13	no
Z52A	2-way	DN25	3/4"	1"	17	no
Z52B	2-way	DN32	1"	1" 1/4	32	no
Z53M	3-way+bypass	DN15	1/2"	1/2"	4,9	yes
Z53L	3-way+bypass	DN20	1/2"	3/4"	4,9	no
Z53A	3-way+bypass	DN25	3/4"	1"	7,3	no
Z53B	3-way+bypass	DN32	1"	1" 1/4	1,6	no



Dimensions (servocontrol included)

	Ø	A	B	C	D	E
Z52M	1/2"	115	99	17	64	118
Z52L	3/4"	115	99	17	64	-
Z52A	1"	122	103	19	67	-
Z52B	1" 1/4	130	106	24	77	-

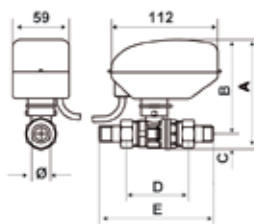

■ Z52...

Dimensions (servocontrol included)

	Ø	A	B	C	D	E
Z53M	1/2"	164	99	66	64	118
Z53L	3/4"	135	99	36	64	-
Z53A	1"	141	103	38	67	-
Z53B	1" 1/4	147	106	41	77	-

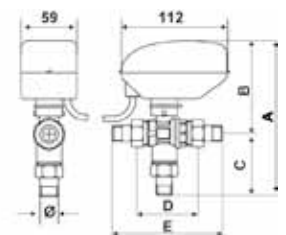

■ Z53...

3-way and 4-way rotor mixing valves



CODE	WAY	KV m³/h	CONNECTION	CONNECTION TYPE	SUITABLE FOR	WEIGHT KG
Z61C	3	41	40 DN	flange PN 6	024-034	5,77
Z61D	3	65	50 DN	flange PN 6	024-034	8,16
Z61E	3	100	65 DN	flange PN 6	024-034	11,16
Z61F	3	185	80 DN	flange PN 6	024-034	15,03
Z61G	3	310	100 DN	flange PN 6	024-034	21,69
Z62A	3	17	G 1	female threaded	024-034	0,8
Z62B	3	25	G 1 1/4	female threaded	024-034	2,41
Z62C	3	41	G 1 1/2	female threaded	024-034	2,47
Z62D	3	65	G 2	female threaded	024-034	5,23
Z63C	4	41	40 DN	flange PN 6	024-034	5,77
Z63D	4	65	50 DN	flange PN 6	024-034	8,16
Z63E	4	100	65 DN	flange PN 6	024-034	11,16
Z63F	4	185	80 DN	flange PN 6	024-034	15,03
Z63G	4	310	100 DN	flange PN 6	024-034	21,69
Z64A	4	17	G 1	female threaded	024-034	0,8
Z64B	4	25	G 1 1/4	female threaded	024-034	2,41
Z64C	4	41	G 1 1/2	female threaded	024-034	2,47
Z64D	4	65	G 2	female threaded	024-034	5,23

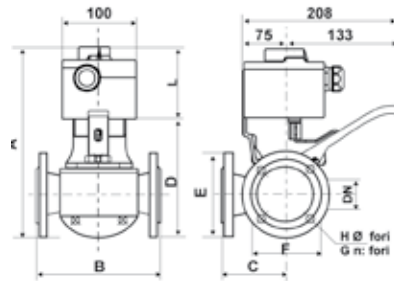

■ Z61+ T01A + 024

DIN	A	B	C	D	E	F	G	H
40	258	180	90	168	130	100	4	14
50	268	200	100	178	140	110	4	14
65	282	200	100	192	160	130	4	14
80	305	234	117	215	190	150	4	18
100	330	260	130	240	210	170	4	18

Dimensions (servocontrol included)

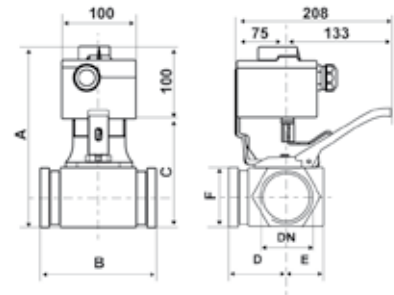

■ Z62 + T01A + 024

DIN	A	B	C	D	E	F
G1	205	85	115	42,5	27	42
G1 1/4	222	122	132	61	39	60
G1 1/2	225	135	135	67,5	40	65
G2	236	180	146	90	53	82

Dimensions (servocontrol included)

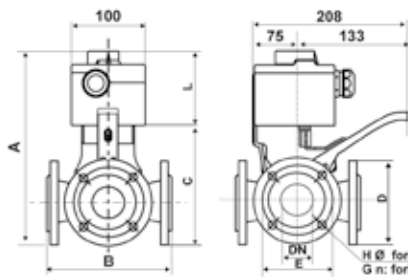

■ Z63+ T01A + 024

DIN	A	B	C	D	E	F	G
40	258	180	168	130	100	4	14
50	268	200	178	140	110	4	14
65	282	200	192	160	130	4	14
80	305	234	215	190	150	4	18
100	330	260	240	210	170	4	18

Dimensions (servocontrol included)

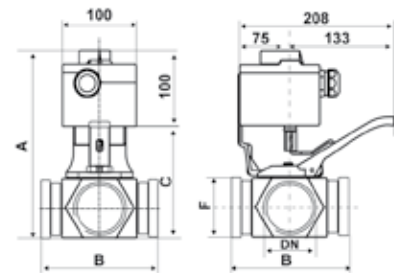

■ Z62 + T01A + 024

DIN	A	B	C	D
G1	205	85	115	42
G1 1/4	222	122	132	60
G1 1/2	225	135	135	65
G2	236	180	146	90

Dimensions (servocontrol included)

3-way and 4-way sector mixing valves



CODE	KV m³/h	CONNECTION	CONNECTION TYPE	SUITABLE FOR	WEIGHT KG
ZC3M	10	G 3/4	female threaded PN6	024-034	1,95
ZC3A	15	G 1	female threaded PN6	024-034	2,50
ZC3B	20	G 1 1/4	female threaded PN6	024-034	3,47
ZC3C	40	G 1 1/2	female threaded PN6	024-034	3,67
ZC340	40	DN 40	flange PN 6	024-034	6,17
ZC350	60	DN 50	flange PN 6	024-034	8,15
ZC365	100	DN 65	flange PN 6	024-034	11,23
ZC380	185	DN 80	flange PN 6	024-034	18,40
ZC3100	300	DN 100	flange PN 6	024	23,75
ZC3125	525	DN 125	flange PN 6	035A (on request)	41,48
ZC3150	825	DN 150	flange PN 6	035A (on request)	49,17
ZC4M	11	G 3/4	female threaded PN6	024-034	2,67
ZC4A	20	G 1	female threaded PN6	024-034	2,92
ZC4B	30	G 1 1/4	female threaded PN6	024-034	4,55
ZC4C	60	G 1 1/2	female threaded PN6	024-034	4,75
ZC440	60	DN 40	flange PN 6	024-034	8,15
ZC450	80	DN 50	flange PN 6	024-034	9,88
ZC465	150	DN 65	flange PN 6	024-034	13,43
ZC480	200	DN 80	flange PN 6	024-034	22,86
ZC4100	300	DN 100	flange PN 6	024	29,34

CONNECTION	A	B	C	D	E	F	G
3/4"	110	105	55	26	25	-	-
1"	110	117	55	35	31	-	-
1 1/4"	130	126	63	37	40	-	-
1 1/2"	130	130	65	40	45	-	-
40 DN	180	155	90	65	130	100	14
50 DN	180	170	90	70	140	110	14
60 DN	200	185	100	80	160	130	14
80 DN	230	205	112	95	190	150	18
100 DN	260	225	130	105	210	170	18
125 DN	320	305	160	120	240	200	18
150 DN	350	340	175	132	265	225	18

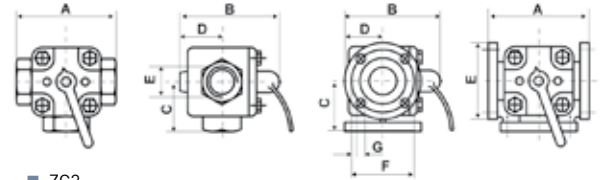

■ ZC3...

CONNECTION	A	B	C	D	E	F	G
3/4"	110	122	55	40	25	-	-
1"	110	122	55	40	31	-	-
1 1/4"	130	145	65	55	40	-	-
1 1/2"	130	145	65	55	45	-	-
40	180	155	90	65	130	100	14
50	180	165	90	70	140	110	14
65	200	185	100	80	160	130	14
80	230	205	115	95	190	150	18
100	260	225	130	105	210	170	18
125 DN	320	305	160	120	240	200	18
150 DN	350	340	175	132	265	225	18

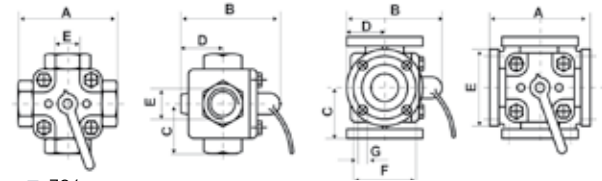

■ ZC4...

3-way threaded motorized globe valves



CODE	KV m³/h	DN	CONNECTION	TRACE TIME sec/mm	RATED TRACE mm	WEIGHT KG
ZL30A	4	15	G 1 1/8	7,5	20	2,67
ZL30B	6,3	20	G 1 1/4	7,5	20	2,92
ZL30C	10	25	G 1 1/2	7,5	20	4,55
ZL30D	16	32	G 2	7,5	20	4,75
ZL30E	25	40	G 2 1/4	7,5	20	8,15
ZL30F	40	50	G 2 3/4	7,5	20	9,88

DN	L	B	H	G
15	80	55	46	1" 1/8
20	90	55	46	1" 1/4
25	110	55	52	1" 1/2
32	120	55	56	2
40	130	60	65	2" 1/4
50	150	65	65	2" 3/4

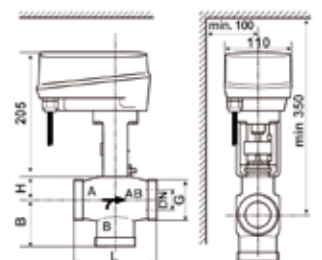

3-way flanged motorized globe valves



CODE	KV m³/h	DIN	MAX. DIFFERENTIAL PRESSURE bar	TRACE TIME sec/mm	RATED TRACE mm	WEIGHT KG
ZL31A	10	25	4	7,5	20	6,8
ZL31B	16	32	4	7,5	20	8,8
ZL31C	25	40	4	7,5	20	12,5
ZL31D	40	50	3	7,5	20	16
ZL31E	63	65	4	8	20	19,9
ZL31F	100	80	2,7	8	20	31,5
ZL31G	145	100	1,6	8	20	34,06
ZL31H	220	125	0,9	8	20	60,9
ZL31I	320	150	0,5	8	20	84,5

■ from ZL31A to ZL31D

DN	L	H	D	K	d	C
25	160	52	115	85	4X14	18
32	180	56	140	100	4X19	18
40	200	64	150	110	4X19	20
50	230	64	165	125	4X19	22

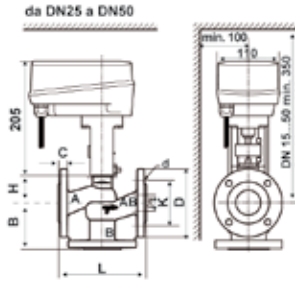

■ from ZL31A to ZL31D

DN	L	H	D	K	d	C
25	160	52	115	85	4X14	18
32	180	56	140	100	4X19	18
40	200	64	150	110	4X19	20
50	230	64	165	125	4X19	22

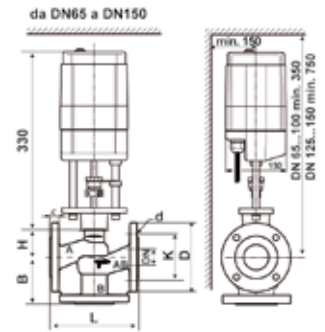

Linkage kits for mixing valves with servocontrols

CODE	SUITABLE FOR
T01A	for O23A-O24 Fantini-Buche
T01B	for O23A-O24 Honeywell Ø24
T01D	for O23A-O24 Fantini Landis GyrØ12 -Lazzari Ø12
T01E	for O23A-O24 Zentra Ø20,8
T01F	for O23A-O24 Vilb Ø11
T01G	for O23A-O24 STARK Ø12
T01H	for O23A-O24 LOEL Ø20
T01L	for O23A-O24 Wimat Ø14
T01M	for O23A-O24 Vema Ø12
T01N	for O23A-O24 Besser Ø12
T01P	for O23A-O24 Coster75 Ø16
T01Q	for O23A-O24 Coster73 Ø12
T01R	for O23A-O24 Ivk Ø14
T01S	for O23A-O24 Sauter Ø16
T01T	for O23A-wayssmann 6
T01U	for O23A-wayssmann 9
T01Z	for O23A-O24 Mixette Ø12
T02A	for O23A-O24 Vema Ø10
T02B	for O23A-O24 Vilb Ø25
T02C	for O23A-O24 Jucker Ø14
T02D	for O23A Tam Stadler Ø12
T02G	for O23A-O24 Esbe Hoval-Elesta
T02H	for O23A-O24 for Majmar 12
T04A	for O34A Fantini Cosmi
T04B	for O34A Mut
T04C	for O34A Siemens
T04D	for O34A L&S serie 2
T04E	for O34A Fantini - Lazzari
T04F	for O34A Centra
T04G	for O34A Esbe
T05A	for O35A Fantini - Lazzari
T06A	KIT manual operation
O24AUX	KIT for mounting an auxiliary contact
TAUX	KIT for an auxiliary contact mounting

TELECONTROL SYSTEMS

GSM remote control



CODE	ANTENNA	POWER SUPPLY	CONSUMPTION W	PROTECTION DEGREE
CT3M	integrated	10 ÷ 20 Vdc o Vac	10 max	IP40 (back panel)
CT3MA	external	10 ÷ 20 Vdc o Vac	10 max	IP40 (back panel)
1560053	Litio battery back-up to send alarm messages in case of power failure			

- 1 output relay 4(2)A-250Vac.
- 2 alarm inputs
- LED signal intensity.



iOS

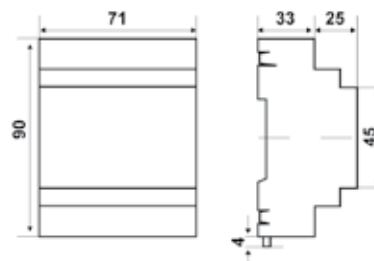

Interface for remote control



CODE	MOUNTING	REMOTE RELAY POWER SUPPLY	INPUTS 1	INPUTS 2	PROTECTION DEGREE
CTIRM	flush mounting 2-3 modules	12 ÷ 24Vac-Vdc	summer/winter	economy/comfort	IP00

- Interface for remote control of programmable thermostats with serial CT input economy/comfort/summer-winter remote controls

Remote control and monitoring system, via SMS and PC



CODE	COMPOSITION	POWER SUPPLY	PROTECTION DEGREE
EV70A	control unit + connection cable + software CD	230Vac 50Hz	IP40 (back panel)
EV70D	control unit with display + connection cable + software CD	230Vac 50Hz	IP40 (back panel)
EV70AK	Assembly kit including control unit, GSM modem EM70S, modem connection cable, power supply, antenna and software CD		
EV70AQ	Board with EV70A control unit completely wired		
EV70AQB	Board with EV70A control unit completely wired and with battery backup		
EV70DK	Assembly kit including control unit, GSM modem EM70S, modem connection cable, power supply, antenna and software CD		
EV70DQ	Board with EV70A control unit completely wired		
EV70DQB	Board with EV70A control unit completely wired and with battery backup		

- 4 digital inputs ON-OFF.
- 3 digital inputs for temperature probes.
- 1 digital input for probe 4-20 mA.
- 4 output relays
- RS232 serial port.
- FANBUS serial port.

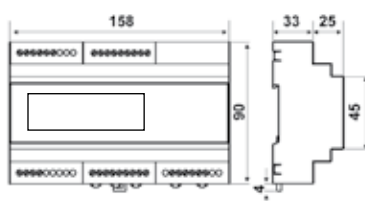

■ EV70D

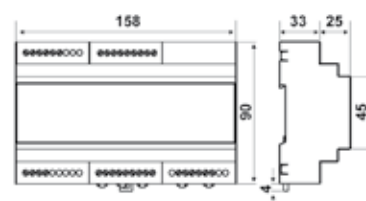

■ EV70A

FLOW CONTROLS

Air flow switch, with stainless steel blade



CODE	DUCT SURFACE cm ²	MAXIMUM INCREASING FLOW SPEED	MAXIMUM DECREASING FLOW SPEED	OPERATING TEMPERATURE	PROTECTION DEGREE
FF71A	160	1,4 m/sec	0,6 m/sec	-20 ÷ 70 °C	IP54
	320	2,2 m/sec	1,2 m/sec	-20 ÷ 70 °C	IP54
	640	3 m/sec	1,6 m/sec	-20 ÷ 70 °C	IP54
	1280	3 m/sec	1,7 m/sec	-20 ÷ 70 °C	IP54

- AISI 301 flexible stainless steel blade.

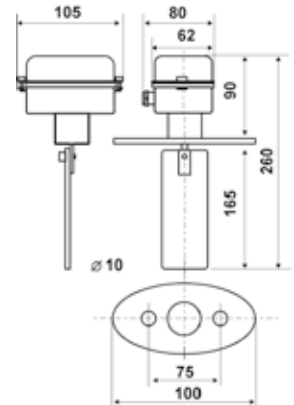

Liquid flow switch, with stainless steel blade



CODE	PIPE DIAMETER	MINIMUM CALIBRATION VALUE (dm ³ /sec) WITH FLOW:		MAXIMUM CALIBRATION VALUE (dm ³ /sec) WITH FLOW:		PROTECTION DEGREE
		INCREASING	DECREASING	INCREASING	DECREASING	
FF81	G 1	0,26	0,16	0,58	0,53	IP54
	G 2	0,8	0,6	1,6	1,7	IP54
	G 3	1,7	1,2	3,2	3	IP54
	G 4	2,2	1,7	5,1	4,8	IP54
FF84	G 6	4,7	3,4	9	8,5	IP54
	G 8	12,9	10,7	26	25,2	IP54
	G 10	26,5	22	43,5	41	IP54

- Operating temperature -20 ÷ 70 °C.



	FF81	FF84
A	105	98
B	62	54
C	80	72
D	204	354
L1	35	
L2	60	
L3	90	
L4	110	
L6		160
L8		210
L10		260

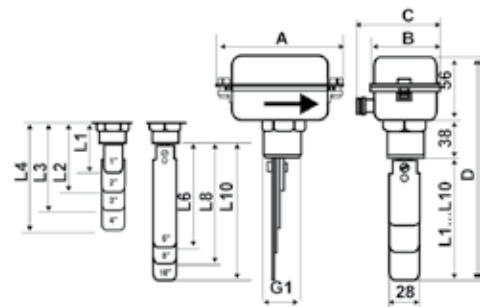

Liquid flow switch, with plastic housing and blade



- Operating temperature 0 ÷ 100 °C.
- SPDT contact rating 10(3)A 250Vac.

CODE	PIPE DIAMETER	MINIMUM CALIBRATION VALUE (dm ³ /sec) WITH FLOW:		MAXIMUM CALIBRATION VALUE (dm ³ /sec) WITH FLOW:		PROTECTION DEGREE
		INCREASING	DECREASING	INCREASING	DECREASING	
FF81P	G 1	0,26	0,16	0,58	0,53	IP54
	G 2	0,87	0,65	1,65	1,74	IP54
	G 3	1,85	1,3	3,49	3,27	IP54
	G 4	2,39	1,85	5,56	5,23	IP54
FF91P	G 1/2	0,13	0,8	0,29	0,26	IP54
	G 1	0,26	0,16	0,58	0,53	IP54
	G 1 1/2	0,39	0,24	0,87	0,79	IP54
	G 2	0,8	0,6	1,7	1,6	IP54



Dimensions blades mm	
G1	35
G2	60
G3	90
G4	110

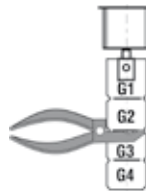

	FF81P	FF91P
B	38	27
C	110	60
D	204	143
G	G1	G1/2

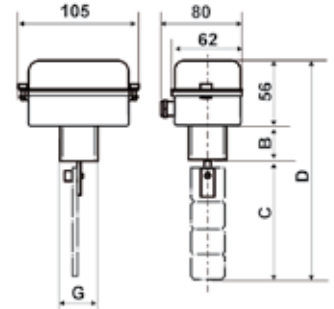

Liquid flow switch, with plastic housing and stainless steel blade



- Operating temperature -20÷ 10 °C.
- Contact rating 16(6)A 250Vac.



CODE	PIPE DIAMETER	BLADE LENGTH mm	MINIMUM CALIBRATION VALUE (m ³ /h) WITH FLOW:		MAXIMUM CALIBRATION VALUE (m ³ /h) WITH FLOW:	
			INCREASING	DECREASING	INCREASING	DECREASING
FF82	G 1	35	1	0,5	2	1,9
	G 1 1/4	35	1,2	0,7	2,9	2,7
	G 1 1/2	58	1,6	1	3,9	3,6
	G 2	58	2,9	2,1	6,1	5,7
	G 2 1/2	89	4	2,7	7	6,5
	G 3	89	6,1	4,3	11,4	10,7
	G 4	89	14,7	11,3	28,9	27,6
	*	167	7,9	6,1	18,4	17,3
	G 5	89	28,3	22,8	55,5	53
	*	167	12,8	9,2	26,7	25
	G 6	89	43	35,8	85	81,6
	*	167	16,8	12,2	32,5	30,5
	G 8	89	85	72,4	172,3	165,5
	*	167	46,4	38,5	94	90,7

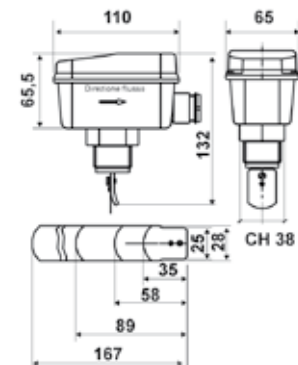

CONTACTORS AND THERMAL RELAYS

Three-pole contactors



CODE	RATED THERMAL CURRENT I _{th}	RATED CURRENT IN AC3-380V- I _e	CONTROLLABLE POWERS OF THREE-PHASE MOTORS IN CATEGORY AC2-AC3			
			220-240V	380-415V	440V	660V
HR0910N <input type="checkbox"/>	25A	9A	2.2 kW 3 HP	4 kW 5.5 HP	4.5 kW 6 HP	4.5 kW 6 HP
HR0901N <input type="checkbox"/>						
HR1310N <input type="checkbox"/>	25A	13A	3.2 kW 4.5 HP	6 kW 8 HP	6.5 kW 8.8 HP	6.5 kW 8.8 HP
HR1301N <input type="checkbox"/>						
HR1710N <input type="checkbox"/>	40A	17A	4 kW 5.5 HP	7.5 kW 10.5 HP	8.5 kW 11.5 HP	8.5 kW 11.5 HP
HR1701N <input type="checkbox"/>						
HR2510N <input type="checkbox"/>	40A	25A	6 kW 8 HP	11 kW 15 HP	12.5 kW 17 HP	12.5 kW 17 HP
HR2501N <input type="checkbox"/>						
HR33N <input type="checkbox"/>	72A	33A	7.5 kW 10 HP	15 kW 20 HP	18,5 kW 25 HP	22 kW 30 HP
HR33NW <input type="checkbox"/>	72A	33A	7.5 kW 10 HP	15 kW 20 HP	18,5 kW 25 HP	22 kW 30 HP
HR40N <input type="checkbox"/>	72A	40A	11 kW 15 HP	18,5 kW 25 HP	20 kW 27 HP	30 kW 40 HP
HR46N <input type="checkbox"/>	90A	46A	15 kW 20 HP	22 kW 30 HP	25 kW 34 HP	37 kW 50 HP
HR55N <input type="checkbox"/>	110A	55A	18.5 kW 25 HP	30 kW 40 HP	33 kW 45 HP	35 kW 60 HP

CONTROL COIL CODES

CODES	F	G	D	U	X	C	W	B	Z
50 Hz-V		48	110	220	220 ÷ 240	366	380	440	480 ÷ 500
60 Hz-V	24	58	115	230		440	400	528	

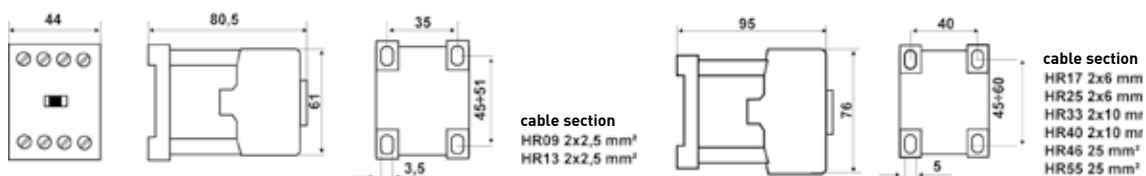

Auxiliary contact blocks



CODE	TIPO	RATED THERMAL CURRENT I _{th}	RATED CURRENT AC-15					
			220V-240V	380-415V	500V			
IR02	instantaneous	10A	3A	1,5A	1A			
IR11	instantaneous							
IR22	instantaneous							
IR13	instantaneous							
IR31	instantaneous							
IT60D	time-delayed	10A	6A	6A	3A			
IT60I	time-delayed							
IDC01D	d.c. control							
IDC01F	d.c. control	10A	3A	1,5A	1A			
IDC01G	d.c. control							
IDC01U	d.c. control							
IDC10D	d.c. control							
IDC10F	d.c. control							
IDC10FB	d.c. control							
IDC10U	d.c. control							
I85	mechanical					Mechanical interlock		

Waterproof insulating housings IP65



CODE

UH13Y	with blind cover and reset button standard, for contactors HR09-HR13 and direct starters HS09Y - HS13Y
UH13YP	with run-stop/reset buttons for direct starters HS09Y..P - HS13Y..P
UH25Y	with blind cover and reset button standard, for contactors HR17-HR25 and direct starters HS17Y - HS25Y
UH25YP	with run-stop/reset buttons for direct starters HS17Y..P - HS25Y..P

	A	B	C	E
UH13Y	90	155	100	140
UH13YP	90	155	121	140
UH25Y	100	180	112	165
UH25YP	100	180	138	165

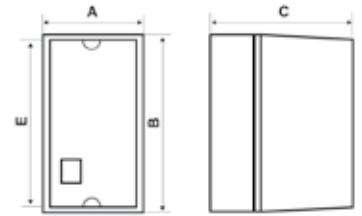

Control coils



CODE

IH13
IH25

CONTROL COIL CODES

CODES	F	G	D	U	X	C	W	B	Z
50 Hz-V	24	48	110	220	220 ÷ 240	366	380	440	480 ÷ 500
60 Hz-V		58	115	230		440	400		

Thermal relay for contactor



CODE	REGULATION RANGE A	RATED THERMAL CURRENT I _{th}	RATED CURRENT I _e			
			Vac	Vdc		
			220-240V	380-415V	500V	W
JA25	0.15 ÷ 26	10A	3A	1,5A	1A	50
JA25Q	0.15 ÷ 26	10A	3A	1,5A	1A	50
JA46	0.15 ÷ 65	10A	6A	3A	1,5A	100
I82	support for separate mounting of thermal relay JA46					
I84	support for separate mounting of thermal relay JA25					

SELECTION TABLE JA25

	A	B	C	D	E	F	G	H	I	L	M	N	O	P	Q
REGULATION RANGE CODES	0.15	0.22	0.3	0.42	0.6	0.85	1.2	1.7	2.5	3.6	5.3	7.3	10	13.5	18
	÷	÷	÷	÷	÷	÷	÷	÷	÷	÷	÷	÷	÷	÷	÷
	0.25	0.33	0.45	0.63	0.9	1.27	1.75	2.6	3.7	5.4	7.5	10.2	15.7	20	26
PROTECTION FUSES (A)	AM	0.5	0.5	1	1	2	2	4	6	8	10	12	16	25	40
	gl	-	-	2	2	4	4	4	6	10	16	20	25	50	63

SELECTION TABLE JA46

	A	B	C	D	E	
REGULATION RANGE CODES	15	20	28	35	46	
	÷	÷	÷	÷	÷	
	23	33	42	50	65	
PROTECTION FUSES (A)	AM	25	40	50	63	80
	gl	50	63	80	100	100

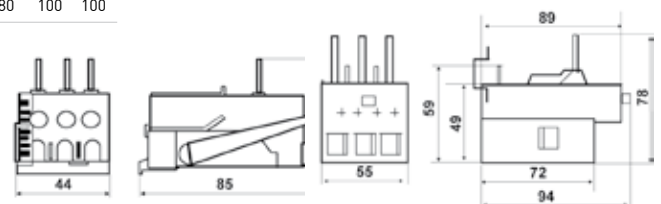

Direct starters in IP65 waterproof insulating housing



CODE	RATED THERMAL CURRENT I _{th}	RATED CURRENT IN AC3 380V I _e	CONTROLLABLE POWERS OF THREE-PHASE MOTORS IN CATEGORY AC2-AC3			COMPOSITION
			220-240V	380-415V	500V	
DIRECT STARTER WITH RESET BUTTON						
HS0910Y □ □	25A	9A	2.2 kW 3 HP	4 kW 5.5 HP	5.5 kW 7.5 HP	HR0910+JA25+UH13Y
HS1310Y □ □	25A	13A	3.2 kW 4.5 HP	6 kW 8 HP	8 kW 11 HP	HR1310+JA25+UH13Y
HS1710Y □ □	40A	17A	4 kW 5.5 HP	7.5 kW 10.5 HP	10 kW 14 HP	HR1710+JA25+UH25Y
HS2510Y □ □	40A	25A	6 kW 8 HP	11 kW 15 HP	15 kW 20 HP	HR2510+JA25+UH25Y
DIRECT STARTER WITH RUN-STOP/RESET BUTTON						
HS0910Y □ □ P	25A	9A	3.2 kW 4.5 HP	6 kW 8 HP	8 kW 11 HP	HR0910+JA25+UH13YP
HS1310Y □ □ P	25A	13A	3.2 kW 4.5 HP	6 kW 8 HP	8 kW 11 HP	HR1310+JA25+UH13YP
HS1710Y □ □ P	40A	17A	4 kW 5.5 HP	7.5 kW 10.5 HP	8 kW 11 HP	HR1710+JA25+UH25YP
HS2510Y □ □ P	40A	25A	6 kW 8 HP	11 kW 15 HP	15 kW 20 HP	HR2510+JA25+UH25YP

THERMAL CALIBRATION CODES JA25

	A	B	C	D	E	F	G	H	I	L	M	N	O
REGULATION RANGE CODES	0.15 ÷	0.22 ÷	0.3 ÷	0.42 ÷	0.6 ÷	0.85 ÷	1.2 ÷	1.7 ÷	2.5 ÷	3.6 ÷	5.3 ÷	7.3 ÷	10 ÷
PROTECTION FUSES (A)	0.5	0.5	1	1	2	2	2	4	6	8	10	12	16
	AM												
	gI	-	-	2	4	4	4	4	6	10	16	20	25

CONTROL COIL CODES

	U	W
50 - 60 Hz	220	380
V	÷	÷
	230	400

	A	B	C	E
HS09Y	90	155	100	140
HS09YP	90	155	121	140
HS17Y	90	155	100	140
HS17YP	90	155	121	140
HS13Y	100	180	112	165
HS13YP	100	180	138	165
HS25Y	100	180	112	165
HS25YP	100	180	138	165

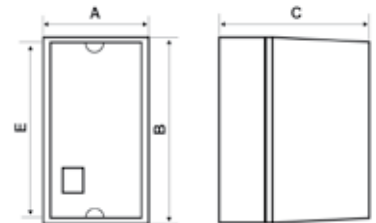

Auxiliary contactors



CODE	CONTACTS NUMB. NO NC	RATED THERMAL CURRENT I _{th}	CONTROL IN ALTERNATING CURRENT AC-15			CONTROL IN DIRECT CURRENT DC-13		
			220-240V	380-415V	500V			
HX1040E	4 0							
HX1031E	3 1	10A	3A	1,5A	1A	0,5A	3,5A	0,25A
HX1022E	2 2							

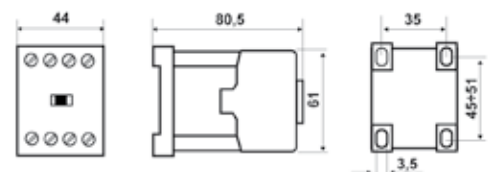

Instantaneous auxiliary contact blocks



CODE	NO. OF CONTACTS NA NC	RATED THERMAL CURRENT ITH	RATED CURRENT Ie		
			AC-15		
			220-240V	380-415V	500V
IX02	0 2				
IX11	1 1				
IX20	2 0				
IX04	0 4	10A	3A	1,5A	1A
IX13	1 3				
IX22	2 2				
IX31	3 1				
IX40	4 0				

HEATING CABLES

Constant power cables



- Power supply 230Vac 50Hz.
- Output power ~17W/m.
- Cables shall be provided with control thermostats, code L03BI1A



CODE	REEL LENGTH	SURFACE HEATED WITH 130W	TOTAL ABSORBED POWER AT 230V	MAXIMUM SUSTAINED TEMPERATURE
K17C29	29 mt	3 m ²	500 W	65 °C
K17C73	73,5 mt	6 m ²	1250 W	65 °C
K17C82	82,3 mt	7 m ²	1400 W	65 °C
K17C102	102,9 mt	9 m ²	1750 W	65 °C
K17C129	129,4 mt	11 m ²	2200 W	65 °C

Constant power cables



- Power supply 230Vac.
- Output power ~15W/m.
- Cables shall be provided with control thermostats, code L03BI1A



CODE	REEL LENGTH	SURFACE HEATED WITH 130W	TOTAL ABSORBED POWER AT 230V	MINIMUM SUSTAINED TEMPERATURE	MAXIMUM TEMPERATURE NOT POWERED
K13C30	30 mt	3,5 m ²	450 W	-20 °C	90 °C
K13C74	74 mt	8,5 m ²	1100 W	-20 °C	90 °C
K13C100	100 mt	13 m ²	1150 W	-20 °C	90 °C
K13C142	142 mt	17 m ²	2191 W	-20 °C	90 °C

Constant power cables



- Power supply 230Vac.
- Output power ~10W/m.
- Maximum length of heating circuit from supply point 80mt.



CODE	REEL LENGTH	MINIMUM SUSTAINED TEMPERATURE	MAXIMUM TEMPERATURE NOT POWERED	MAXIMUM TEMPERATURE WHEN POWERED
K12C25	25 mt	-30 °C	80 °C	65 °C
K12C50	50 mt	-30 °C	80 °C	65 °C
K12C75	75 mt	-30 °C	80 °C	65 °C

Heating cables with integrated thermostat and plug



- Schuko plug.
- Termostato integrato.
- Power tolerance ±2.5W.
- Thermostat temperature range ON +5°C OFF +15°C.



CODE	REEL LENGTH	MINIMUM INSTALLATION TEMPERATURE	MAXIMUM TEMPERATURE NOT POWERED	MAXIMUM TEMPERATURE WHEN POWERED
K10C3KIT	3 mt	-35 °C	60 °C	60 °C
K10C6KIT	6 mt	-35 °C	60 °C	60 °C
K10C9KIT	9 mt	-35 °C	60 °C	60 °C
K10C14KIT	14 mt	-35 °C	60 °C	60 °C

Self-regulating heating cables



- Power supply 230Vac 50Hz.
- Output power ~15W/m at 5°C.
- Conductors 0,57 mm².
- Calibration of protective circuit 16A x 100 mt at 0°C.



CODE	REEL LENGTH	MINIMUM SUSTAINED TEMPERATURE	MAXIMUM TEMPERATURE NOT POWERED	MAXIMUM LENGTH OF HEATING CIRCUIT FROM POWER POINT
K15A25	25 mt	-30 °C	80 °C	100 mt
K15A50	50 mt	-30 °C	80 °C	100 mt
K15A75	75 mt	-30 °C	80 °C	100 mt
K15A100	100 mt	-30 °C	80 °C	100 mt
K15A500	500 mt	-30 °C	80 °C	100 mt
K15A1000	1000 mt	-30 °C	80 °C	100 mt

Self-regulating heating cables



- Power supply 230Vac 50Hz.
- Calibration of protective circuit at 0°C for 100m:
 - K20A, 25A max length 155mt.
 - K30A, 32A max length 120mt.
 - K40A, 32A max length 100mt.



CODE	REEL LENGTH	OUTPUT POWER AT 10°C W/M	MINIMUM SUSTAINED TEMPERATURE	MAXIMUM TEMPERATURE NOT POWERED	MAXIMUM LENGTH OF HEATING CIRCUIT FROM POWER POINT
K20A25	25 mt	24	-30 °C	80 °C	155 mt
K20A50	50 mt	24	-30 °C	80 °C	155 mt
K20A100	100 mt	24	-30 °C	80 °C	155 mt
K20A500	500 mt	24	-30 °C	80 °C	155 mt
K30A25	25 mt	36	-30 °C	80 °C	120 mt
K30A50	50 mt	36	-30 °C	80 °C	120 mt
K30A100	100 mt	36	-30 °C	80 °C	120 mt
K40A25	25 mt	48	-30 °C	80 °C	100 mt
K40A50	50 mt	48	-30 °C	80 °C	100 mt
K40A100	100 mt	48	-30 °C	80 °C	100 mt

Self-regulating heating cables



- Power supply 230Vac 50Hz.
- Calibration of protective circuit:
 - K55A100 50 meters 10A, 80 meters 16A, 120 meters 20A.
 - K65A100 100 meters 20A.



CODE	REEL LENGTH	OUTPUT POWER AT 10°C W/M	MINIMUM SUSTAINED TEMPERATURE	MAXIMUM TEMPERATURE NOT POWERED	MAXIMUM LENGTH OF HEATING CIRCUIT FROM POWER POINT
K55A100	100 mt	9	-30 °C	100 °C	120 mt
K65A100	100 mt	13	-30 °C	100 °C	100 mt

Accessories

CODE		SUITABLE FOR
KBE3	Junction box	K15A - K12C - K13C - K17C - K20A - K30A - K40A - K55A - K65A
KSUPP	Support for junction box	K15A - K12C - K13C - K17C - K20A - K30A - K40A - K55A - K65A
K50	Fixing tape for pipes	K15A - K12C - K20A - K30A - K40A - K55A - K65A
K50AL	Fixing tape for plastic pipes	K15A - K12C - K20A - K30A - K40A - K55A - K65A
KJSSP	1 mt PVC spacer	K13C - K17C
KFAN	Adhesive yellow labels	K15A - K12C - K20A - K30A - K40A - K55A - K65A
KIT1	Sealing kit for constant power cables	K12C
KIT2	Sealing kit for self-regulating cables	K15A - K20A - K30A - K40A - K55A - K65A
L23EM1A	ON/OFF humidistat, see page 50	K13C - K17C
LS160A	humidistat probe, see page 50	K13C - K17C
L03BI1A	ON/OFF thermostat - P.I.D. 1 output, see page 49	K13C - K17C - K20A - K30A - K40A - K55A - K65A
C03A3	Immersion thermostat for pipes, see page 19	K12C - K20A - K30A - K40A - K55A - K65A

DIGITAL THERMOSTATS AND INSTRUMENTS

ON/OFF - P.I.D. thermostats with 1 or 2 outputs and temperature alarms management



CODE	SENSOR	POWER SUPPLY	OUTPUTS NO.	MEASUREMENT RANGE	PROBE PRECISION
L02AI2B	1 probe NTC 10K* LS130 included	12Vac/dc	2	-40 ÷ 105 °C	±0.3°C(-40÷100), ±1°C
L02AM2	1 probe NTC 10K* LS130 included	115÷230Vac 50Hz	2	-40 ÷ 105 °C	±0.3°C(-40÷100), ±1°C
L02CI1B	1 probe PT 100 LS140 excluded	12Vac/dc	1	0 ÷ 400 °C	±0.3°C(-50÷150), ±1°C
L02CI2B	1 probe PT 100 LS140 excluded	12Vac/dc	2	0 ÷ 400 °C	±0.3°C(-50÷150), ±1°C
L02CM1	1 probe PT 100 LS140 excluded	115÷230Vac 50Hz	1	0 ÷ 400 °C	±0.3°C(-50÷150), ±1°C
L02CM2	1 probe PT 100 LS140 excluded	115÷230Vac 50Hz	2	0 ÷ 400 °C	±0.3°C(-50÷150), ±1°C
L02DI1B	1 thermoc. J LS150 excluded	12Vac/dc	1	0 ÷ 450 °C	±3°C IP
L02DI2B	1 thermoc. J LS150 excluded	12Vac/dc	2	0 ÷ 450 °C	±3°C IP
L02DM1	1 thermoc. J LS150 excluded	115÷230Vac 50Hz	1	0 ÷ 450 °C	±3°C IP
L02DM2	1 thermoc. J LS150 excluded	115÷230Vac 50Hz	2	0 ÷ 450 °C	±3°C IP
L02BI1A	1 probe NTC 10K LS130 included	12Vac/dc	1	-40 ÷ 105 °C	±0.3°C(-40÷100), ±1°C
L02BM1A	1 probe NTC 10K LS130 included	230Vac 50Hz	1	-40 ÷ 105 °C	±0.3°C(-40÷100), ±1°C

- Flush mounting.
- Resolution 0,1(-19.9÷99.9), 1.



LT312U power supply transformer, 230Vac - 12Vac

* Possibility to connect PT1000 (LS120, not included) instead of NTC 10K.
Attention: L02C-- e L02D-- models can reach respectively a temperature range of -100÷850°C ("C" mod.) and -50÷750°C ("D" mod.) if connected with PT100 or J thermocouple suitable to support such temperatures.

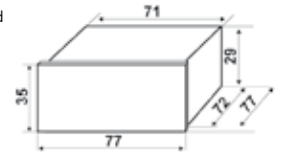

ON/OFF - P.I.D. thermostats with 1 or 2 outputs and temperature alarms management



CODE	SENSOR	POWER SUPPLY	OUTPUTS NO.	MEASUREMENT RANGE	PROBE PRECISION
L03BI1A	1 probe NTC 10K LS130* included	12Vac/dc	1	-40 ÷ 105	±0.3°C(-40÷100), ±1°C
L03BI2A	1 probe NTC 10K LS130* included	12Vac/dc	2	-40 ÷ 105	±0.3°C(-40÷100), ±1°C
L03BM1A	1 probe NTC 10K LS130* included	230Vac 50Hz	1	-40 ÷ 105	±0.3°C(-40÷100), ±1°C
L03BM2A	1 probe NTC 10K LS130* included	230Vac 50Hz	2	-40 ÷ 105	±0.3°C(-40÷100), ±1°C

- DIN rail mounting
- Resolution 0,1(-19.9÷99.9), 1 °C



LT312U power supply transformer, 230Vac - 12Vac

* Possibility to connect PT1000 (LS120, not included) instead of NTC 10K.

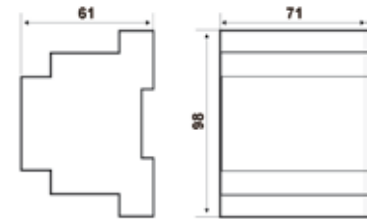

ON/OFF thermostat with 2 outputs



CODE	SENSOR	POWER SUPPLY	OUTPUTS NO.	MEASUREMENT RANGE	PROBE PRECISION
L04BM2A	1 probe NTC 10K LS130 included	230Vac	2	-40 ÷ 105 °C	±0.3°C(-40÷100), ±1°C
LT312U	power supply transformer, 230Vac - 12Vac				

- Wall mounting.
- Resolution 0,1(-19.9÷99.9 °C), 1 for the rest of range.

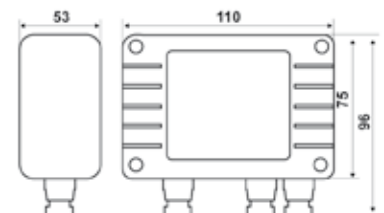

Thermometers



- Flush mounting.
- Operating temperature -10÷50°C.



CODE	SENSOR	MEASUREMENT RANGE	RESOLUTION	PROBE PRECISION	INSTRUMENT PRECISION
L12BM	1 probe PTC1000 LS120 excluded	-40 ÷ 105	< ±0,1 -20 a 100 °C	±1,5 a 25 °C	± 0,2 (-20 ÷ 100)
	1 probe PTC100 LS140 excluded	0 ÷ 400	1 °C for the rest of the range	±0,3 a 0 °C	±0,2 (0÷100) ± 1(100÷400)
L14BM	1 probe PTC1000 LS120 included	-40 ÷ 105	1 °C	±1,5 a 25 °C	± 0,75

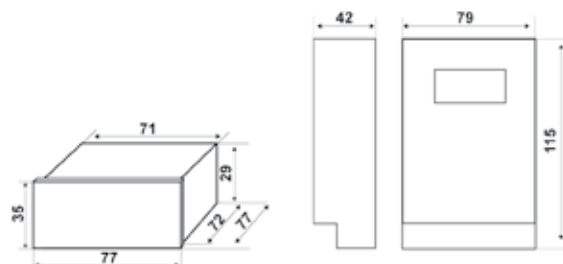

■ L12BM

■ L14BM

Humidistats



- Flush mounting.
- Measurement range 0÷100 RH%.
- Resolution 1 RH%..



CODE	SENSOR	POWER SUPPLY	OUTPUTS NO.	INSTRUMENT PRECISION (0÷100 RH%) RH%	PROTECTION DEGREE
L22E1A	1 probe LS160A excluded	12Vac/dc	1	< ± 0,7	IP55
L22EM1A	1 probe LS160A excluded	230Vac	1	< ± 0,7	IP55
L23EM1A	1 probe LS160A excluded	230Vac	1	< ± 0,7	IP40 (back panel)
L24EM2	1 probe LS160A excluded	230Vac	2	< ± 0,7	IP55

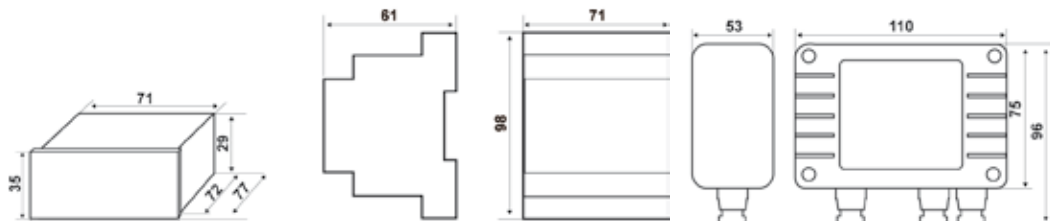

■ L22...

■ L23EM1A

■ L24EM2

Temperature and humidity probes



CODE	MEASUREMENT RANGE	PRECISION K	TIP	PROTECTION DEGREE	CONDUCTORS mm ²
LS120 (PTC1000)	-40 ÷ 105 °C	± 1,5 at 25°C	∅ 6x34	IP67	2 x 0,4
LS123 (PTC1000)	-40 ÷ 105 °C	± 1,5 at 25°C	∅ 6x34	IP67	2 x 0,4 + shield
LS140 (PT100)	0 ÷ 400 °C	± 0,3 at 0°C	∅ 6x160 steel AISI 316	IP65	3 x 0,2
LS150 (thermoc. J)	0 ÷ 450 °C	± 2,5	∅ 6x160 steel AISI 316	IP65	2 x 0,5
LS130 (NTC10K)	-40 ÷ 105 °C	± 1,5 at 25°C	∅ 6x34	IP67	2 x 0,4

CODE	MEASUREMENT RANGE RH%	PRECISION RH%	PROTECTION DEGREE
LS160A	0 ÷ 100%	< ± 0,7 (0÷100%RH)	IP65

SOLENOID VALVES

Direct acting solenoid normally closed valve bodies



CODE	ORIFICE DIAMETER	FEMALE CONNECTION	Kv m ³ /h	MAXIMUM DIFFERENTIAL PRESSURE		TESTING PRESSURE (DIN2401) PN bar
				VN	0,85VN	
M20B3	3 mm	G 1/4	0,27	16	10	25
M20C5	5 mm	G 3/8	0,612	6	2	25
M20D5	5 mm	G 1/2	0,612	6	2	25
M20E7	7 mm	G 3/4	1	2,5	1,8	25

CODE	CONTROL COIL 24V	CONNECTOR	PASSAGE ORIFICE mm	FEMALE CONNECTION
M20C51	IM22	1578501	5	G 3/8

- Closing time 10 msec.
- The control coils are supplied separately from valve bodies.



	A	B	C
M20B3	40	74	17
M20C5	53	78,5	26
M20D5	53	78,5	26
M20E7	60	94	52

N.B. Dimensions and weights are including the coils.

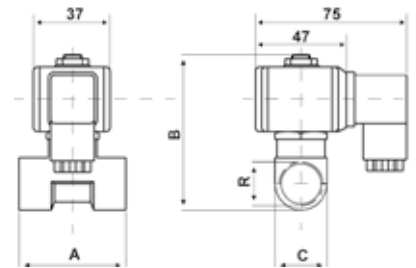

Direct operation solenoid valve bodies, normally-closed



CODE	ORIFICE DIAMETER	FEMALE CONNECTION	KV m ³ /h	CLOSING TIME DP OF 1 BAR	MAXIMUM DIFFERENTIAL PRESSURE	MINIMUM DIFFERENTIAL PRESSURE	TEST PRESSURE (DIN2401) PN
M23C13	13 mm	G 3/8	3	1 sec.	20 bar	0,1 bar	25 bar
M23D13	13 mm	G 1/2	3	1 sec.	20 bar	0,1 bar	25 bar
M23E20	20 mm	G 3/4	8,4	1,5 sec.	20 bar	0,1 bar	25 bar
M23F25	25 mm	G 1	9,6	1,5 sec.	20 bar	0,1 bar	25 bar
M23G35	35 mm	G 1 1/4	25,2	2,5 sec.	10 bar	0,1 bar	16 bar
M23H40	40 mm	G 1 1/2	30	3 sec.	10 bar	0,1 bar	16 bar
M23I50	50 mm	G 2	37,2	3,5 sec.	10 bar	0,1 bar	16 bar

Kv = water flow in m³/h with pressure drop of 1 bar (1 bar = 100kPa).

- The control coils are supplied separately from valve bodies.



	A	B	C
M23C13	69	2,5	40
M23D13	72	94,5	40
M23E20	100	100	65
M23F25	104	105,5	65
M23G35	145	127	102
M23H40	145	127	102
M23I50	173	141	118

N.B. Dimensions and weights are including the coils.

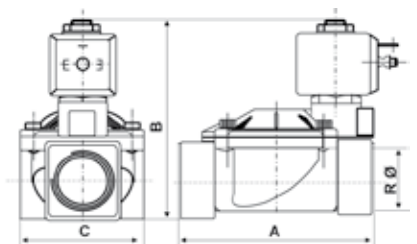

Servo-assisted diaphragm valve bodies, normally-open



- The control coils are supplied separately from valve bodies.



CODE	ORIFICE DIAMETER	FEMALE CONNECTION	KV m ³ /h	CLOSING TIME DP OF 1 BAR	MAXIMUM DIFFERENTIAL PRESSURE	MINIMUM DIFFERENTIAL PRESSURE	TEST PRESSURE (DIN2401) PN
M29C13	13 mm	G 3/8	3	1	20 bar	0,1 bar	25 bar
M29D13	13 mm	G 1/2	3	1	20 bar	0,1 bar	25 bar
M29E20	20 mm	G 3/4	8,4	1,5	20 bar	0,1 bar	25 bar
M29F25	25 mm	G 1	9,6	1,5	20 bar	0,1 bar	25 bar
M29G35	35 mm	G 1 1/4	25,2	2,5	10 bar	0,1 bar	16 bar
M29H40	40 mm	G 1 1/2	30	3	10 bar	0,1 bar	16 bar
M29I50	50 mm	G 2	37,2	3,5	10 bar	0,1 bar	16 bar

Kv = water flow in m³/h with pressure drop of 1 bar (1 bar = 100kPa).

	A	B	C
M29C13	69	2,5	40
M29D13	72	94,5	40
M29E20	100	100	65
M29F25	104	105,5	65
M29G35	145	127	102
M29H40	145	127	102
M29I50	173	141	118

N.B. Dimensions and weights are including the coils.

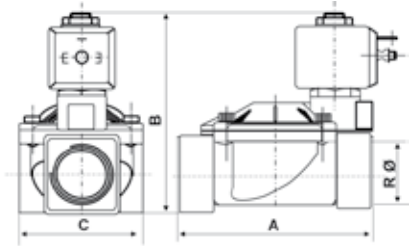

Control coils for solenoid valve bodies, IM2 series



CODE	SUITABLE FOR	POWER SUPPLY	COIL ABSORPTION		ACTIVE POWER W
			START VA	STOP VA	
IM21F	M20 - M23	24 Vac 50/60Hz	25	16	9
IM21H	M20 - M23	115 Vac 50/60Hz	25	16	9
IM21M	M20 - M23	230 Vac 50/60 Hz	25	16	9
IM21D	M20 - M23	12 Vac 50/60 Hz	25	16	9
IM22	M20 - M23	24 Vdc			12
IM22A*	M20 - M23	12 Vdc			14
IM29A	M29	12 Vac 50/60 Hz	33	25	14
IM29F	M29	24 Vac	33	25	14
IM29M	M29	230Vac 50/60Hz	33	25	14
IM30A	M29	12 Vac 50/60 Hz			16

1578501 Quick connector DIN 43650 suitable for all IM2 coils.

* not suitable for M20E7

HOME AUTOMATION

Electromechanical geared motors for roller shutters and sunblinds



- Full scale turns 0 ÷ 27.
- Power supply 230V 50Hz.



CODE	TORQUE NM	EXIT SPEED RPM	POWER W	ELECTRICAL INPUT A	MAX LOAD KG*
OT10	10	17	140	0,61	19
OT15	15	17	180	0,78	29
OT20	20	17	195	0,84	39
OT25	25	17	215	0,93	48
OT35	35	17	260	1,14	68
OT40	40	12	265	1,14	78
MOTOR WITH OVER RIDE					
OT25MS	25	17	215	0,93	48
OT40MS	40	12	265	1,14	78
OT50MS	50	12	300	1,28	98
MOTOR - ROLLER - ACCESSORIES					
OK10	10	17	140	0,61	19
OK20	20	17	195	0,84	39
OK35	35	17	260	1,14	68
OK50	50	12	300	1,28	98

* Load calculated with roller diameter 60 cm

CODE	DESCRIPTION
OTB1	telescopic roller shutters wrap
1573001	motor wall bracket
1573005	motor support bracket
1573007	adjustable motor wall bracket

	L
OT10	405 mm
OT15	425 mm
OT20	425 mm
OT25	425 mm
OT35	485 mm
OT40	485 mm
OT50	485 mm
OK10	405 mm
OK20	425 mm
OK35	485 mm
OK50	485 mm

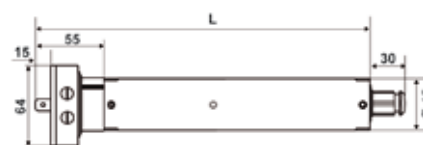

Sequential control and RF unit for motorized rolling shutters



CODE	POWER SUPPLY	OPERATING TEMPERATURE	PROTECTION DEGREE
OCR1	230Vac 50Hz	-10 ÷ 60 °C	IP55
OCS1	230Vac 50Hz	-10 ÷ 60 °C	IP55
1573505	expansion module for the sequential control of an additional motor		

- OCR1 radio control receiver for the RF motor control (max. 6).
- OCS1 sequential control unit from 2 to 10 motors.
- Power supply 230V 50Hz.

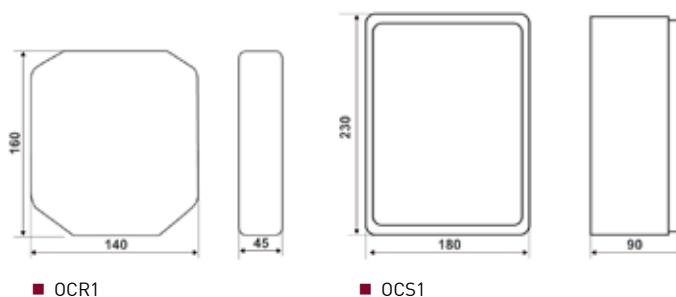

■ OCR1

■ OCS1

Climate sensors, sun, wind and rain



CODE	CONTROL	WIND ALARM REGULATION RANGE	BRIGHTNESS REGULATION RANGE	OPERATING TEMPERATURE	PROTECTION DEGREE
OCV1A	wind	1 Km/h ÷ 35 Km/h	-	-10 ÷ 60 °C	IP56
OCSV1A	sun and wind	5 ÷ 40 Km/h	0 ÷ 50 lux	-10 ÷ 60 °C	IP56
OCM1A	sun, wind and rain	5 ÷ 40 Km/h	0 ÷ 50 lux	-10 ÷ 60 °C	IP56
OCVP1	wind and rain	1 Km/h ÷ 35Km/h	-	-10 ÷ 60 °C	IP56
1582021	spare part wind sensor				
1582022	spare part sun-wind sensor				
1582023	spare part rain sensor				

- Power supply 230Vac 50Hz.
- Maximum relay rating (4A inductive 250Vac) 10(4)Vac.

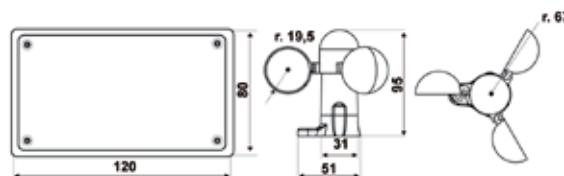

Control unit from 1 to 5 motors



CODE	NUMBER OF CONTROLLED MOTORS	POWER SUPPLY	SWITCH CONTACT RATING	OPERATING TEMPERATURE	PROTECTION DEGREE
OMC1	1	230Vac 50Hz	10(4)A 250Vac	-20 ÷ 60 °C	IP44
OMC2	2	230Vac 50Hz	10(4)A 250Vac	-20 ÷ 60 °C	IP44
OMC3	3	230Vac 50Hz	10(4)A 250Vac	-20 ÷ 60 °C	IP44
OMC4	4	230Vac 50Hz	10(4)A 250Vac	-20 ÷ 60 °C	IP44
OMC5	5	230Vac 50Hz	10(4)A 250Vac	-20 ÷ 60 °C	IP56

- Power supply 230Vac 50Hz.

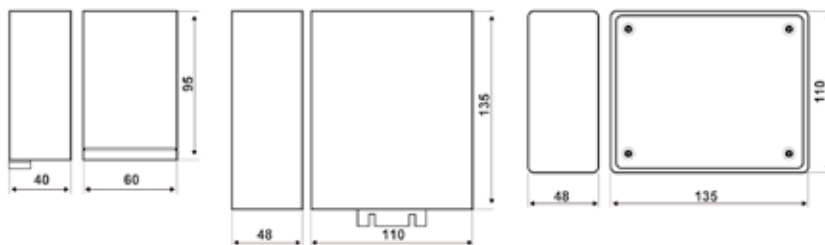

■ OMC1

■ OMC2 - OMC3 - OMC4

■ OMC5

Modules equipped with digital inputs and relay outputs



CODE	INPUTS	OUTPUTS	POWER SUPPLY FROM BUS	MOUNTING
ODD08	-	8 relays (230Vac - 12A - AC1)	24Vdc - 180mA	DIN rail 5 modules
ODD80	8 digital	-	24Vdc - 75mA	DIN rail 4 modules
ODD98	9 digital	8 relays (230Vac - 6A - cosφ 1)	24Vdc - 120mA	DIN rail 4 modules

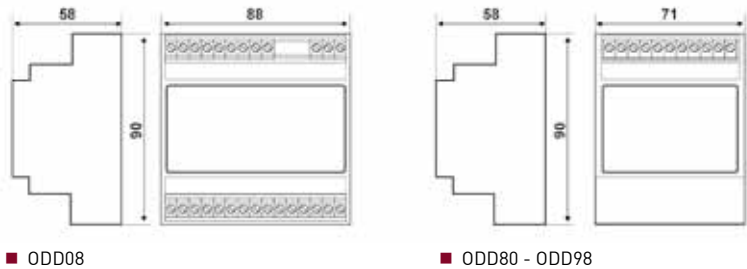

0÷10V modules



CODE	INPUTS	OUTPUTS	POWER SUPPLY FROM BUS	MOUNTING
ODA02	-	2 outputs 0÷10V (max 4mA)	24Vdc - 45mA	DIN rail 1 module

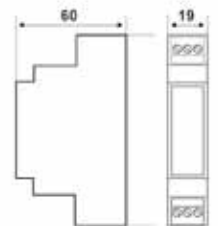

Module for electric load monitoring



CODE	INPUTS	OUTPUTS	POWER SUPPLY FROM BUS	MOUNTING
ODA10C	1 (TA internal transformer max 40A)	-	24Vdc - 20mA	DIN rail 2 modules

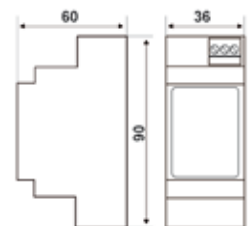

Modules equipped with digital inputs and outputs at 24 Vdc



CODE	INPUTS	OUTPUTS	POWER SUPPLY FROM BUS	MOUNTING
ODD40	12 (4 digital + 8 virtual)	-	24Vdc - 18mA	flush mounting
ODD54	5 physical	4 live, "available" (24 Vdc - 50 mA)	24Vdc - 20mA	flush mounting

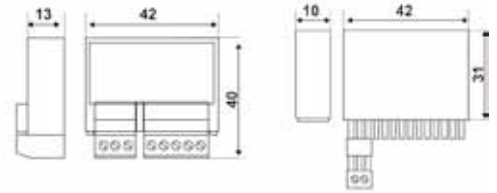

■ ODD40

■ ODD54

Automation modules for roller shutters and venetian blinds



CODE	INPUTS	OUTPUTS	POWER SUPPLY FROM BUS	MOUNTING
ODD52T	5 digital (shutter automation)	2 relays (230Vac - 250W max)	24Vdc - 30mA	flush mounting
ODD52V	5 digital (venetian blind automation)	2 relays (230Vac - 250W max)	24Vdc - 30mA	flush mounting



CODE	COMPONENTS	POWER SUPPLY
ODK01T	1 power source (24 Vdc, 300 mA) 5 modules ODD52T	Power source: 230 Vca, 50 Hz, 10 W Modules: 24 Vdc, 30 mA each
ODK02E	2 modules ODD52T	Modules: 24 Vdc, 30 mA each

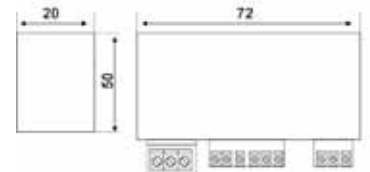

Modules for temperature monitoring



CODE	INPUTS	OUTPUTS	POWER SUPPLY FROM BUS
ODD20S	1 digital data (only for ODST01)	-	24Vdc - 8mA
ODST01	-	1 digital data (only for ODD20S)	24Vdc - 5mA

■ Flush mounting.

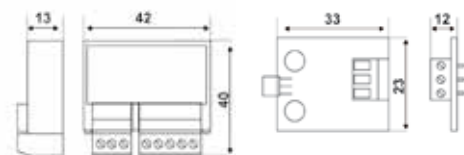

■ ODD20S

■ ODST01

Power supply modules



CODE	POWER SUPPLY	OUTPUTS	POWER SUPPLY TO BUS
ODAL2	230Vac - 50Hz - 60W	1 MiA-BUS data port (only for ODUSB)	24Vdc - 2A
ODAL1*	230Vac - 50Hz - 60W	-	24Vdc - 0,3A

* Note: the ODAL1 power source is the spare part code for the power adapter included in the ODK01T shutter automation kit – it cannot be used with other applications since it is not supervised and suitable for connection in parallel with other bus power supply sources.

■ DIN rail mounting, 4 modules.

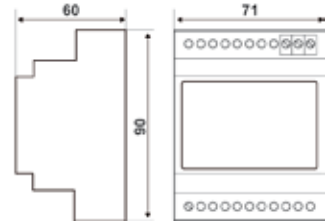

Supervision products and software

CODE	DESCRIPTION FLUSH MOUNTING	INPUTS	OUTPUTS	POWER SUPPLY FROM BUS
ODUSB	Flush mounting USB data interface	1 Bus data port	1 USB data port	24Vdc - 20mA
CODE	DESCRIPTION			
ODHW01	The multi-client MiA system (inclusive of the HW) for the supervision with redundancies through a PC, Touch-PC etc.			
ODSW02	The stand-alone MiA software licence pre-installed on PC for the supervision on a single PC or Touch-PC.			
ODSCF1	MiA-Make bus software configuration.			

Touch-PC



CODE	DESCRIPTION	SCREEN FORMAT	FRAME FINISH
ODTS2AL	Wall-mounted touch-PC	1:10 inches 800x600	aluminium
ODTS4AL	Wall-mounted touch-PC	4:15 inches 1024x768	aluminium
ODTS5CR	Wall-mounted touch-PC	5:15 inches 1024x768	crystal



Magnetic supports with recharge



CODE	DESCRIPTION
ODIPS1	wall-mounted support compatible with iPad2
ODIPS2	table-mounted support compatible with iPad2
ODIPC1	black case compatible with iPad2
ODIPC2	white case compatible with iPad2



GAS DETECTORS

Electronic control unit for gas leak detection



CODE	POWER SUPPLY	CONTACT RATING	CONNECTED SENSORS	MOUNTING	PROTECTION DEGREE
P30A	230Vac - 50Hz o 12Vdc	5A - 250Vac	3	wall or backpanel	IP40
P81	12 Vac o 12/14 Vdc	5A - 250Vac	1	DIN rail 6 modules	IP40
P82	12Vac/dc ± 10%	8A - 250Vac	4	DIN rail 9 modules	IP40

■ P81 and P82 4÷20mA sensors.

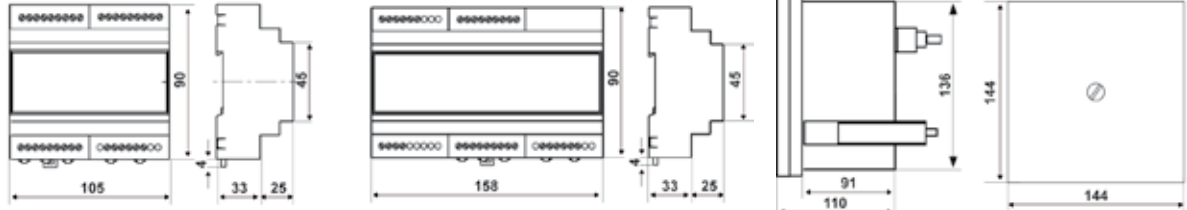

■ P81

■ P82

■ P30

Gas detection sensors for electronic control units



CODE	GAS TYPE	POWER SUPPLY	PROTECTION DEGREE
S71	METHANE gas, or other light gases	from P30A unit	IP54
S72	LPG gas (cylinder liquid gas) or other heavy gases	from P30A unit	IP54
S81	METHANE gas, or other light gases	from P81 or P82 unit	IP44
S82	LPG gas (cylinder liquid gas) or other heavy gases	from P81 or P82 unit	IP44
S83	CO carbon monoxide	from P81 or P82 unit	IP44
S84 *	METHANE gas, or other light gases	11 ÷ 28Vdc	IP65
S85 *	LPG gas (cylinder liquid gas) or other heavy gases	11 ÷ 28Vdc	IP65
S86 *	CO carbon monoxide	11 ÷ 28Vdc	IP65

■ * ATEX Certificate II 2G Ex d IIC T6.



1590080	optional board 4 relays outputs with fixed threshold for probes S84-S85-S86
---------	---

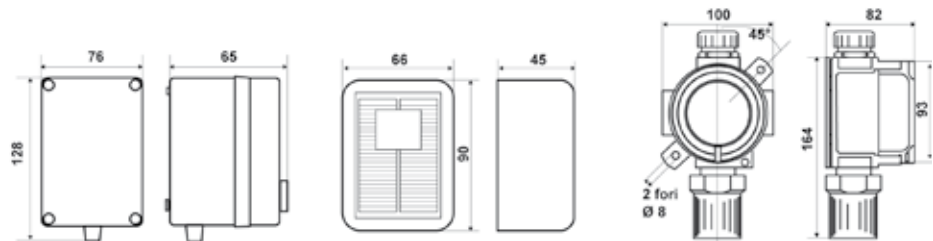

■ S71 - S72

■ S81 - S82 - S83

■ S84 - S85 - S86

Acoustic and light signaling device



CODE	SIGNAL TYPE	POWER SUPPLY	PROTECTION DEGREE
S80	acoustic and visual	240V 50Hz	IP30

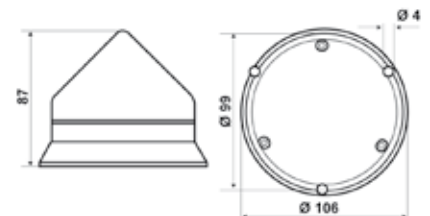

P

Gas leak detectors for methane gas, LPG and CO carbon monoxide



CODE	SENSOR	GAS TYPE	POWER SUPPLY	CONTACT RATING	CONSUMPTION	PROTECTION DEGREE
P11	semiconductor	METHANE	230Vac - 50Hz	6(2)A - 250Vac	4 VA	IP42
P12	semiconductor	LPG	230Vac - 50Hz	6(2)A - 250Vac	4 VA	IP42
P21	catalytic	METHANE	230Vac - 50Hz	6(2)A - 250Vac	4 VA	IP42
P22	catalytic	LPG	230Vac - 50Hz	6(2)A - 250Vac	4 VA	IP42
EP11	Replacement semiconductor sensor for P21 - methane					
EP12	Replacement semiconductor sensor for P22 - LPG					
EP21	Replacement catalytic sensor for P21 - methane					
EP22	Replacement catalytic sensor for P22 - LPG					

- P21 and P222 relays (pre-alarm).

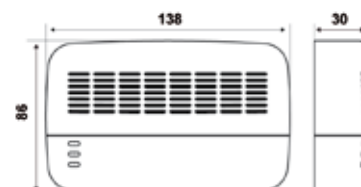

Gas leak detectors for methane gas and CO carbon monoxide



CODE	SENSOR	GAS TYPE	POWER SUPPLY	CONTACT RATING	CONSUMPTION	PROTECTION DEGREE
P61AE	semiconductor	METHANE	230Vac - 50Hz	6(2)A - 250Vac	4 VA	IP42
P63	semiconductor	CO carbon monoxide	230Vac - 50Hz	6(2)A - 250Vac	4 VA	IP42

- P61AE, without silencer button
IMQ homologation.

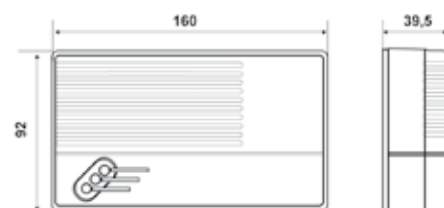

Gas leak detectors for methane gas, LPG and CO carbon monoxide



CODE	GAS TYPE	COLOR	POWER SUPPLY	CONTACT RATING	OPERATING TEMPERATURE	PROTECTION DEGREE
P71	METHANE	anthracite	230Vac - 50Hz	5(3)A - 250Vac	0 ÷ 40 °C	IP42
P71B	METHANE	white	230Vac - 50Hz	5(3)A - 250Vac	0 ÷ 40 °C	IP42
P71C	METHANE	silver	230Vac - 50Hz	5(3)A - 250Vac	0 ÷ 40 °C	IP42
P72	LPG	anthracite	230Vac - 50Hz	5(3)A - 250Vac	0 ÷ 40 °C	IP42
P73	CO carbon monoxide	anthracite	230Vac - 50Hz	5(3)A - 250Vac	0 ÷ 40 °C	IP42

- With button/pull cord for alarm silencing.
- Flush mounting in 3-module 503 embedded boxes.



COMPATIBLE PLATES
 BTICINO Living International, Living transizione,
 Living-light round LNA and square LNB
 BTICINO Light, Light Tech
 BTICINO Axolute
 VIMAR Idea and Rondò
 VIMAR Plana, Eikon
 GEWISS Playbus and Playbus Young
 AVE sistema 45, Noir, Blanc
 AVE Banquise, Ave Yes
 SIEMENS Delta Futura Graphit
 LEGRAND Cross.

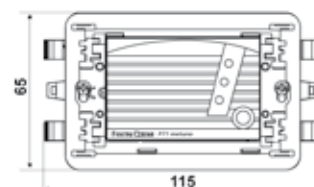

Normally closed electromagnetic safety valves for air and gas



CODE	CONNECTION TYPE	PASSAGE DN	POWER SUPPLY	BODY	MAXIMUM PRESSURE Mbar	ABSORPTION W
ZDEV10	threaded RP 3/8	10	230Vac 50/60Hz	brass	200	16
ZDEV15	threaded RP 1/2	15	230Vac 50/60Hz	brass	200	16
ZDEV20	threaded RP 3/4	20	230Vac 50/60Hz	aluminum	360	45
ZDEV25	threaded RP 1	25	230Vac 50/60Hz	aluminum	360	45
ZDEV32	threaded RP 1 1/4	32	230Vac 50/60Hz	aluminum	360	20/80*
ZDEV40	threaded RP 1 1/2	40	230Vac 50/60Hz	aluminum	360	20/80*
ZDEV50	threaded RP 2	50	230Vac 50/60Hz	aluminum	360	20/80*
ZDEVRF65	flanged DN 65	65	230Vac 50/60Hz	aluminum	200	45/180*
ZDEVRF80	flanged DN 80	80	230Vac 50/60Hz	aluminum	200	45/180*
ZDEVRF100	flanged DN 100	100	230Vac 50/60Hz	aluminum	200	45/180*
ZDEV10F	threaded RP 3/8	10	24Vac	brass	200	16
ZDEV15F	threaded RP 1/2	15	24Vac	brass	200	16
ZDEV20F	threaded RP 3/4	20	24Vac	aluminum	360	45
ZDEV25F	threaded RP 1	25	24Vac	aluminum	360	45
ZDEV32F	threaded RP 1 1/4	32	24Vac	aluminum	360	20/80*
ZDEV40F	threaded RP 1 1/2	40	24Vac	aluminum	360	20/80*
ZDEV50F	threaded RP 2	50	24Vac	aluminum	360	20/80*
ZDEVRF65F	flanged DN 65	65	24Vac	aluminum	200	45/180*
ZDEVRF80F	flanged DN 80	80	24Vac	aluminum	200	45/180*
ZDEVRF100F	flanged DN 100	100	24Vac	aluminum	200	45/180*

* on opening

A	B	C	D	Int	h
30	58	95	110	-	-
30	58	95	110	-	-
88	96	150	164	-	-
88	96	150	164	-	-
120	153	188	220	-	-
120	153	188	220	-	-
106	156	192	230	145	4x18
200	305	266	355	160	8x18
200	305	266	355	160	8x18
252	350	352	492	180	8x18

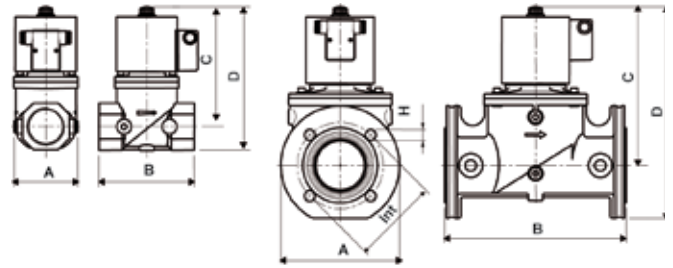

■ ZDEV...15 ÷ 50

■ ZDEV...65 ÷ 100

Normally open electromagnetic safety valves for air and gas with manual reset



CODE	CONNECTION TYPE	PASSAGE DN	POWER SUPPLY	BODY	MAXIMUM PRESSURE Mbar	ABSORPTION W
ZDVGRM15NA	threaded RP 1/2	15	230Vac 50/60Hz	brass	500	16
ZDVGRM20NA	threaded RP 3/4	20	230Vac 50/60Hz	brass	500	16
ZDVGRM25NA	threaded RP 1	25	230Vac 50/60Hz	brass	500	16
ZDEVRM32NA	threaded RP 1 1/4	32	230Vac 50/60Hz	aluminum	500	16
ZDEVRM40NA	threaded RP 1 1/2	40	230Vac 50/60Hz	aluminum	500	16
ZDEVRM50NA	threaded RP 2	50	230Vac 50/60Hz	aluminum	500	16
ZDEVRMF65NA	flange DN 65	65	230Vac 50/60Hz	aluminum	500	19
ZDEVRMF80NA	flange DN 80	80	230Vac 50/60Hz	aluminum	500	19
ZDEVRMF100NA	flange DN 100	100	230Vac 50/60Hz	aluminum	500	19
ZDVGRM15NAF	threaded RP 1/2	15	24Vac	brass	500	16
ZDVGRM20NAF	threaded RP 3/4	20	24Vac	brass	500	16
ZDVGRM25NAF	threaded RP 1	25	24Vac	brass	500	16
ZDEVRM32NAF	threaded RP 1 1/4	32	24Vac	aluminum	500	16
ZDEVRM40NAF	threaded RP 1 1/2	40	24Vac	aluminum	500	16
ZDEVRM50NAF	threaded RP 2	50	24Vac	aluminum	500	16
ZDEVRMF65NAF	flange DN 65	65	24Vac	aluminum	500	19
ZDEVRMF80NAF	flange DN 80	80	24Vac	aluminum	500	19
ZDEVRMF100NAF	flange DN 100	100	24Vac	aluminum	500	19

A	B	C	D	Int	h
70	77	130	148	-	-
85	96	138	165	-	-
85	96	138	165	-	-
120	153	162	195	-	-
120	153	162	195	-	-
106	156	167	205	-	-
200	305	2601	3501	145	4x18
200	305	2601	3501	160	8x18
252	350	2801	4101	180	8x18

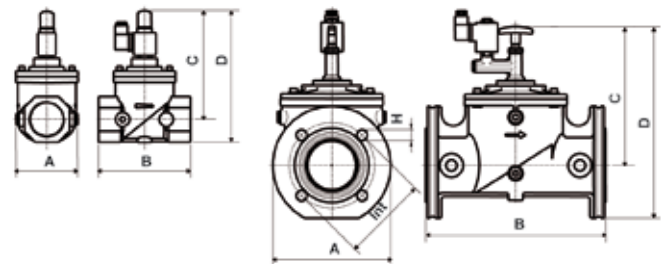

■ ZDVGRM...15 ÷ 50

■ ZDEVRMF... 65÷100

Normally closed electromagnetic safety valves for air and gas with manual reset



CODE	CONNECTION TYPE	PASSAGE DN	POWER SUPPLY	BODY	MAXIMUM PRESSURE Mbar	ABSORPTION W
ZDVGRM15NC	threaded RP 1/2	15	230Vac 50/60Hz	brass	500	8
ZDVGRM20NC	threaded RP 3/4	20	230Vac 50/60Hz	brass	500	8
ZDVGRM25NC	threaded RP 1	25	230Vac 50/60Hz	brass	500	8
ZDEVRM32NC	threaded RP 1 1/4	32	230Vac 50/60Hz	aluminum	500	12
ZDEVRM40NC	threaded RP 1 1/2	40	230Vac 50/60Hz	aluminum	500	12
ZDEVRM50NC	threaded RP 2	50	230Vac 50/60Hz	aluminum	500	12
ZDEVRMF65NC	flange DN 65	65	230Vac 50/60Hz	aluminum	500	25
ZDEVRMF80NC	flange DN 80	80	230Vac 50/60Hz	aluminum	500	25
ZDEVRMF100NC	flange DN 100	100	230Vac 50/60Hz	aluminum	500	45
ZDVGRM15NCF	threaded RP 1/2	15	24Vac	brass	500	8
ZDVGRM20NCF	threaded RP 3/4	20	24Vac	brass	500	8
ZDVGRM25NCF	threaded RP 1	25	24Vac	brass	500	8
ZDEVRM32NCF	threaded RP 1 1/4	32	24Vac	aluminum	500	12
ZDEVRM40NCF	threaded RP 1 1/2	40	24Vac	aluminum	500	12
ZDEVRM50NCF	threaded RP 2	50	24Vac	aluminum	500	12
ZDEVRMF65NCF	flange DN 65	65	24Vac	aluminum	500	25
ZDEVRMF80NCF	flange DN 80	80	24Vac	aluminum	500	25
ZDEVRMF100NCF	flange DN 100	100	24Vac	aluminum	500	45

A	B	C	D	Int	h
30	55	113	130	-	-
35	58	115	130	-	-
40	62	115	137	-	-
120	153	188	220	-	-
120	153	188	220	-	-
106	156	192	230	-	-
200	305	2621	3521	145	4x18
200	305	2621	3521	160	8x18
252	350	3051	4351	180	8x18

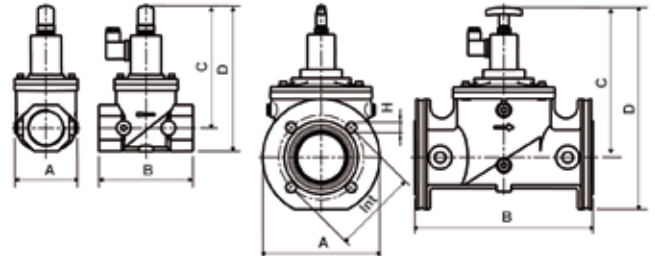

Kit including a gas leak detector and a manual reset gas valve



CODE	COMPONENTS
PKD2115NA	Detector P21 + normally open electromagnetic safety valves with manual reset G1/2"
PKD2115NC	Detector P21 + normally closed electromagnetic safety valves with manual reset G1/2"
PKD2120NA	Detector P21 + normally open electromagnetic safety valves with manual reset G3/4"
PKD2120NC	Detector P21 + normally closed electromagnetic safety valves with manual reset G3/4"
PKD2125NA	Detector P21 + normally open electromagnetic safety valves with manual reset G1"
PKD2215NA	Detector P22 + normally open electromagnetic safety valves with manual reset G1/2"
PKD2220NA	Detector P22 + normally open electromagnetic safety valves with manual reset G3/4"
PKD2225NA	Detector P22 + normally open electromagnetic safety valves with manual reset G1"

ENERGY METERING AND DIGITAL TIMERS

Energy metering compact single phase 32A - 2-wire



CODE	POWER SUPPLY	IMAX	IREF (Ib)	ITR	Imin	Ist	OPTIONS
VM322MA	230V 50Hz - 2-wire	32A	5A	500mA	250mA	20mA	MID homologation
VM322A	230V 50Hz - 2-wire	32A	5A	500mA	250mA	20mA	-

- Consumption 0,8 VA max.
- DIN rail mounting, 1 module.

230V MID

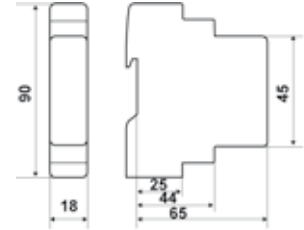

Energy metering compact single phase 80A - 2-wire



CODE	POWER SUPPLY	I _{max}	IREF (I _b)	ITR	I _{min}	I _{st}	OPTIONS
VM802MA	230V 50Hz - 2-wire	80A	5A	500mA	250mA	20mA	MID homologation
VM802A	230V 50Hz - 2-wire	80A	5A	500mA	250mA	20mA	-
VM802RA	230V 50Hz - 2-wire	80A	5A	500mA	250mA	20mA	total resettable meter

- DIN rail mounting, 2 modules.
- Consumption ≤ 1 VA.

230V IP51 MID

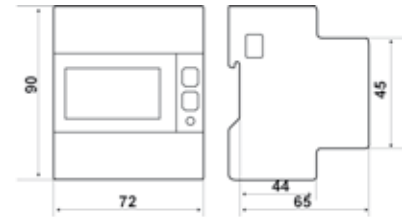

W

Energy metering compact three phase 6A/80A - 3 or 4-wire



CODE	POWER SUPPLY	I _{max}	IREF (I _b)	ITR	I _{min}	I _{st}	OPTIONS
VM063MA	3x400V 50Hz 3-wire	6A	1A	50mA	10mA	2mA	MID homologation
VM063A	3x400V 50Hz 3-wire	6A	1A	50mA	10mA	2mA	-
VM063RA	3x400V 50Hz 3-wire	6A	1A	50mA	10mA	2mA	total resettable meter
VM064MA	3x230/400V 50Hz 4-wire	6A	1A	50mA	10mA	2mA	MID homologation
VM064A	3x230/400V 50Hz 4-wire	6A	1A	50mA	10mA	2mA	-
VM064RA	3x230/400V 50Hz 4-wire	6A	1A	50mA	10mA	2mA	total resettable meter
VM803MA	3x400V 50Hz 3-wire	80A	5A	500mA	250mA	20mA	MID homologation
VM803A	3x400V 50Hz 3-wire	80A	5A	500mA	250mA	20mA	-
VM803RA	3x400V 50Hz 3-wire	80A	5A	500mA	250mA	20mA	total resettable meter
VM804MA	3x230/400V 50Hz 4-wire	80A	5A	500mA	250mA	20mA	MID homologation
VM804A	3x230/400V 50Hz 4-wire	80A	5A	500mA	250mA	20mA	-
VM804RA	3x230/400V 50Hz 4-wire	80A	5A	500mA	250mA	20mA	total resettable meter

- DIN rail mounting, 4 modules.
- Consumption ≤ 1 VA.

230V 400V IP51 MID

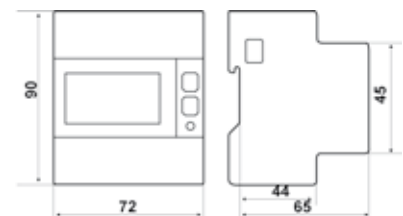

Communication modules



CODE	COMUNICATION TYPE	DIN MOUNTING (NBR. OF MODULES)	POWER SUPPLY AND ABSORPTION
VM001A	RS485-MODBUS	1	230V ± 20% / 50Hz, max 5VA
VM001B	M-BUS	1	from BUS (2 unit-load)
VM001C	LAN GATEWAY - MODBUS TCP	2	230V ± 20% / 50Hz, max 5VA

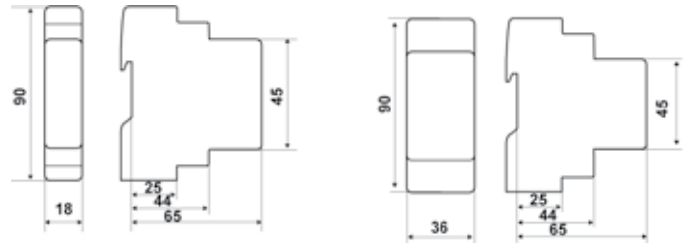

■ VM001A - VM001B

■ VM001C

Daily and weekly digital timer



CODE	POWER SUPPLY	CONTACT RATING	OPERATING TEMPERATURE	PROTECTION DEGREE
W04C	230Vac 50-60Hz	16(8)A 250Vac	-10 ÷ 40 °C	IP30 (back panel)

■ Daily or weekly programme

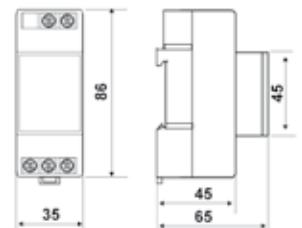

NOTES



NOTES

